

THIS DRAWING OR INFORMATION IS
PROPRIETARY INFORMATION OF THE
REMINGTON ARMS COMPANY, INC.

DO NOT SCALE THIS DRAWING: WORK TO FIGURES
UNLESS OTHERWISE NOTED.
TOLERANCES ON DECIMAL DIMENSIONS ARE:
1 PLACE (0.1) - TOLERANCE ± 0.015
2 PLACE (0.01) - TOLERANCE ± 0.010
3 PLACE (0.001) - TOLERANCE ± 0.005
& ON FRACTIONAL DIMENSIONS $\pm 1/64$
& ON ANGULAR DIMENSIONS $\pm 0.5^\circ$
FINISHES ARE DESIGNATED BY ROOT MEAN
SQUARE (R.M.S.) MICRO-INCH ROUGHNESS
VALUES AND ARE THE MAXIMUM ROUGHNESS
ACCEPTABLE, UNLESS OTHERWISE SPECIFIED.
FINISH ROUGHNESS TO BE #error: broken link
DIMENSIONS AND TOLERANCES ARE IN ACCORDANCE
WITH ASME Y14.5 1994.

MATERIAL AND HEAT TREAT

MATERIAL : MIM-4140 RCT.

HEAT TREAT : CARBURIZE 0.7% C.P.

HARDNESS : HR15n 85-90; 0.008 MIN. EFF. CASE

FINISH : SEE NOTES

HEAT TREAT AND FINISH TO BE DONE BY REMINGTON
OR BETTER.

ALTERATIONS

ALT.	ZONE	WAS	REF.	BY	DATE
------	------	-----	------	----	------

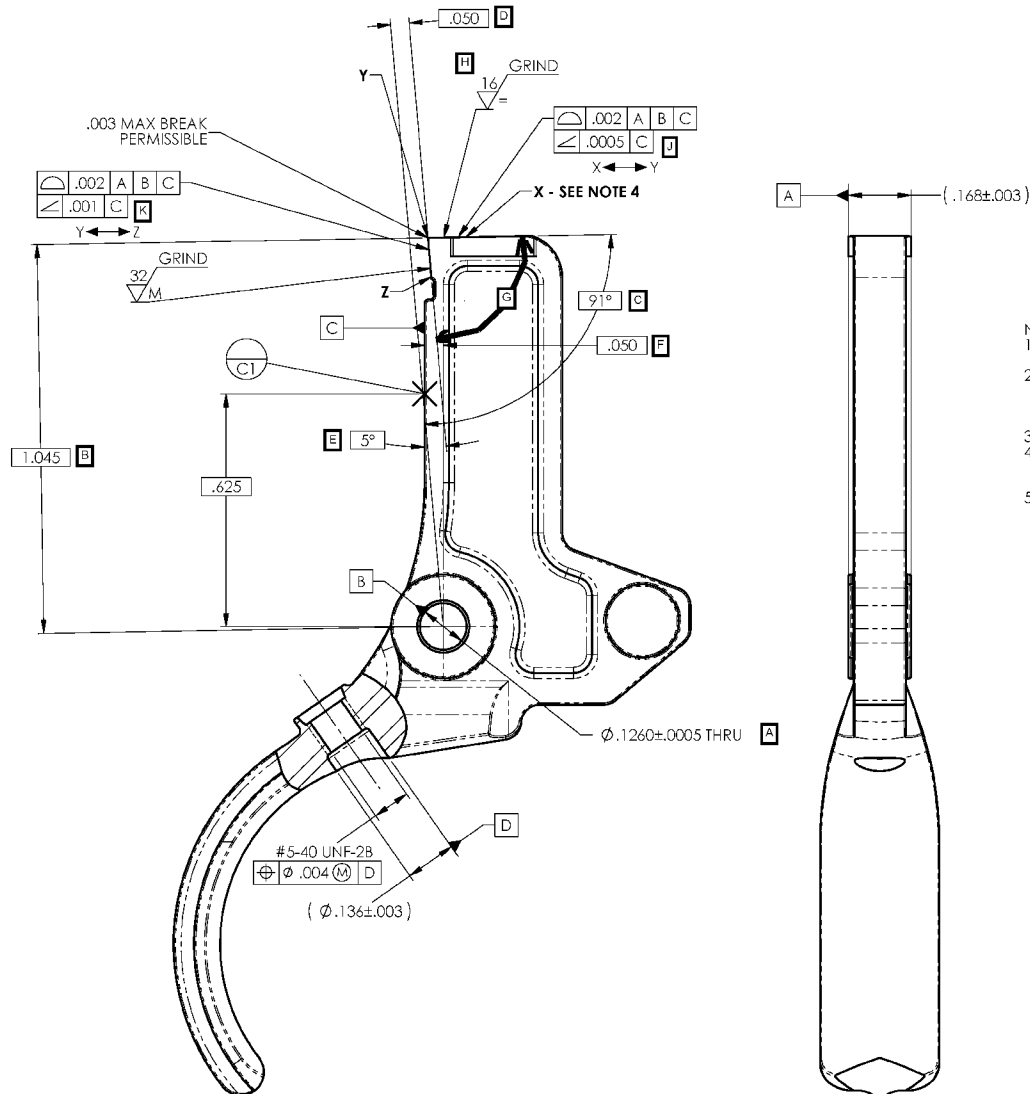
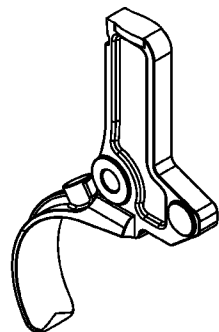

- NOTES:
1. ALL MACHINING TO BE DONE PRIOR TO PLATING. PROTECT SHARP EDGE TO PREVENT DAMAGE PRIOR TO AND DURING PLATING.
 2. DUPLEX COATING, 0.0002"-0.0003" HIGH PHOSPHOROUS ELECTROLESS NICKEL PLATE, UNDER 0.00005"-0.00015" CO-DEPOSITED MEDIUM PHOSPHOROUS ELECTROLESS NICKEL PLATE WITH PTFE (TEFLON). ALL COMPONENTS BAKED @ 375°F FOR 24 HOURS.
 3. FOR DIMENSIONS NOT SHOWN, SEE E-301462.
 4. POINT X FOR THE PROFILE AND ANGULARITY TOLERANCE ZONE ON THE TOP SURFACE OF THE TRIGGER IS LOCATED .100 ALONG THE SURFACE FROM POINT Y AT THE SHARP EDGE.
 5. SURFACE FINISH IS TO BE MEASURED WITH A 10 MICRON PROFILOMETER TIP.

SolidWorks File: 301463 - Trigger

NOT RELEASED FOR PRODUCTION

MODEL	301463	TRIGGER
DES. BY DATE	JWR 12-16-05	CHK. BY DATE
TRIGGER		
SHEET SIZE	NUMBER	SCALE
C	301463	4X
SUPersedes	REFERENCE	
	REMINGTON ARMS CO., INC.	
	Madison, NC 27025	