

DO NOT SCALE THIS DRAWING: WORK TO FIGURES UNLESS OTHERWISE NOTED.  
TOLERANCES ON DECIMAL DIMENSIONS ARE:  
1 PLACE (0.1) - TOLERANCE  $\pm 0.015$   
2 PLACE (0.01) - TOLERANCE  $\pm 0.010$   
3 PLACE (0.001) - TOLERANCE  $\pm 0.005$   
& ON FRACTIONAL DIMENSIONS  $\pm 1/64$   
& ON ANGULAR DIMENSIONS  $\pm 0.5^\circ$   
FINISHES ARE DESIGNATED BY ROOT MEAN SQUARE (R.M.S.) MICRO-INCH ROUGHNESS VALUES AND ARE THE MAXIMUM ROUGHNESS ALLOWED UNLESS OTHERWISE SPECIFIED.  
FINISH ROUGHNESS TO  $\sqrt{R}$  = error; broken line  
DIMENSIONS AND TOLERANCES ARE IN ACCORDANCE WITH ASME Y14.5 1994.

MATERIAL: MIM-4140 REF.

HEAT TREAT: CARBURIZE 0.7% C.P.

HARDNESS : HR15n 85-90; 0.008 MIN. EFF. CASE

FINISH : SEE NOTES

OR BETTER. HEAT TREAT AND FINISH TO BE DONE BY REMINGTON

ALTERATIONS					
ALT.	ZONE	WAS	REF.	BY	DATE

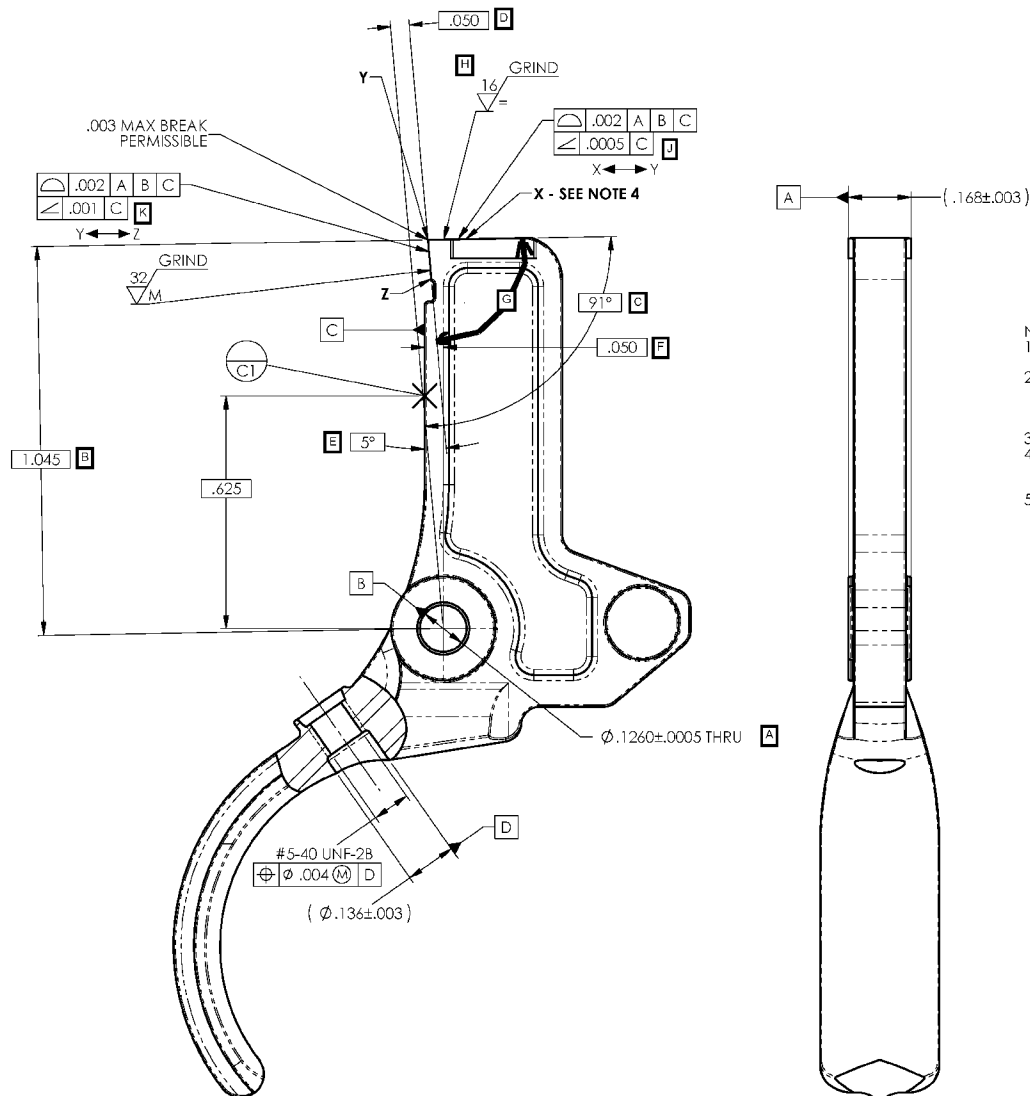
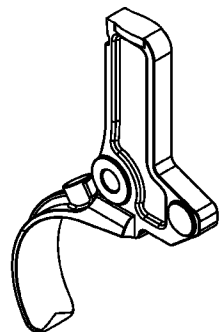

- NOTES:
1. ALL MACHINING TO BE DONE PRIOR TO PLATING. PROTECT SHARP EDGE TO PREVENT DAMAGE PRIOR TO AND DURING PLATING.
  2. DUPLEX COATING, 0.0002"-0.0003" HIGH PHOSPHOROUS ELECTROLESS NICKEL PLATE, UNDER 0.00005"-0.00015" CO-DEPOSITED MEDIUM PHOSPHORUS ELECTROLESS NICKEL PLATE WITH PTFE (TEFLON). ALL COMPONENTS BAKED @ 375°F FOR 24 HOURS.
  3. FOR DIMENSIONS NOT SHOWN, SEE E-301 462.
  4. POINT X FOR THE PROFILE AND ANGULARITY TOLERANCE ZONE ON THE TOP SURFACE OF THE TRIGGER IS LOCATED .100 ALONG THE SURFACE FROM POINT Y AT THE SHARP EDGE.
  5. SURFACE FINISH IS TO BE MEASURED WITH A 10 MICRON PROFILOMETER TIP.

		301463	TRIGGER		
MODEL	PART NO.	PART USE			
DES. BY DATE	DRN. BY DATE	CHK. BY DATE			
JWR 12-16-05	JWR 01-10-06				
TITLE TRIGGER					
SHEET SIZE	NUMBER	SCALE	SUPERSEDES	REFERENCE	
C	301463	4X			
REMINGTON ARMS CO., INC. Madison, NC 27025					

SolidWorks File: 301463 - Trigger

**NOT RELEASED FOR PRODUCTION**