

SHEET SIZE A	NUMBER 301708	REMINGTON ARMS CO., INC. Madison, NC 27025		
		SCALE 5X	SUPERSEDES	REFERENCE

TITLE SPRING, PRIMARY TRIGGER PULL
--

DES. BY DATE JWR 6-1-07	DRN. BY DATE JWR 6-1-07	CHK. BY DATE
-----------------------------------	-----------------------------------	--------------

MODEL	PART NO.	PART USE
	301708	PRIMARY TRIGGER PULL SPRING

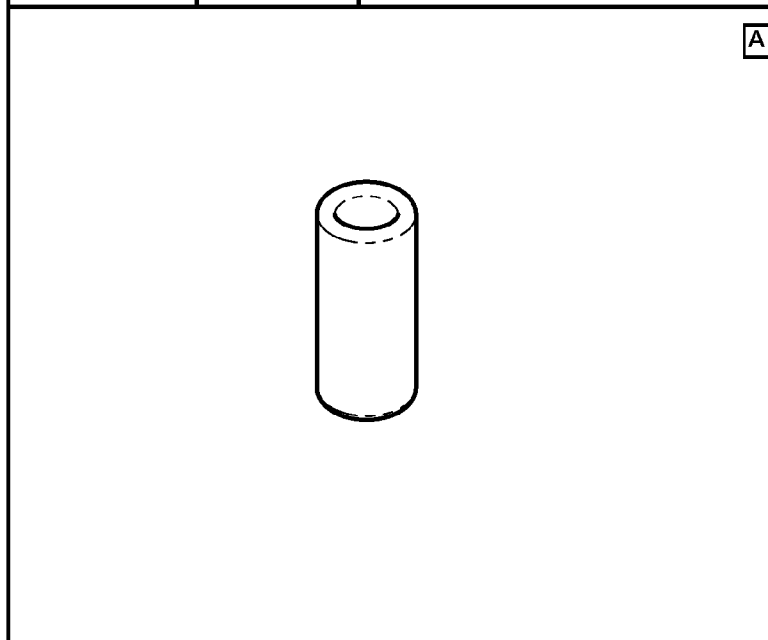

ALT.	WAS	REF.	BY	DATE
ALTERATIONS				

THIS DRAWING OR INFORMATION IS
PROPRIETARY INFORMATION TO THE
REMINGTON ARMS COMPANY, INC.

MATERIAL AND HEAT TREAT

MATERIAL : MUSIC WIRE (ASTM A228)

HEAT TREAT : STRESS RELIEVE

FINISH : OIL

INSPECTION

1. TO WORK FREELY IN A 0.120 DIA. HOLE.
2. TO WORK FREELY ON A 0.059 DIA. PIN.
3. LOAD 1.75 TO 2.25 LB. AT 0.220 (L1)
LOAD 3.60 TO 4.40 LB. AT 0.185 (L2)
4. SOLID HEIGHT 0.155 MAX.
5. WIND LEFT HAND
6. FREE LENGTH 0.250 MIN.
7. ENDS CLOSED & GROUND
8. CHECK HERE FOR NON-COMMERCIAL TOLERANCES ☐

MANUFACTURE

9. WIRE DIA. 0.020
10. FREE LENGTH 0.255
11. OUTSIDE DIA. 0.110
12. COILS: ACTIVE 5.5
13. CHECK HERE FOR SET REMOVAL ☐ TOTAL 7.5

DESIGN DATA

14. SPRING RATE 57 LB./IN.
15. STATIC STRESS AT SOLID 231270 LB./SQ.IN.
16. DYNAMIC STRESS 0 LB./SQ.IN.
17. TOTAL STRESS AT SOLID 231270 LB./SQ.IN.
18. SOLID LOAD 6.0 LBS.
19. SPRING INDEX 4.5
20. TORSIONAL MODULUS 11.5E6 LB./SQ.IN.
21. CURVATURE CORRECTION FACTOR 1.351 (WAHL)
22. VELOCITY IMPACTING MASS 0 IN./SEC.
23. CRITICAL FREQUENCY 6201 HZ.
24. TOTAL STRESS AS % OF TENSILE STRENGTH 63%
25. ENERGY FROM L1 TO L2 0.70 IN-LBS.

THIS SPRING MUST MEET THE REQUIREMENTS IN THE INSPECTION SECTION.
FIGURES GIVEN IN THE MANUFACTURE SECTION INDICATE THE PREFERRED
SPRING. THE MANUFACTURER MAY, WITH PRIOR APPROVAL, DEVIATE FROM
THESE FIGURES. FIGURES IN THE DESIGN DATA SECTION ARE BASED ON
THOSE IN THE MANUFACTURE SECTION.

SOLIDWORKS FILE : 301708 - Primary Trigger Pull Spring

NOT RELEASED FOR PRODUCTION