

START AM,

2004

FIELD ARMORER'S SCHOOL COURSE OUTLINE

DAY 1	8:30-9:00	Welcome To Class
	9:00-9:30	General Information; Ordering Parts, Tool Use, Factory Service
	9:30-11:00	M/870 Slide Presentation
	11:00-12:00	M/870 Disassembly & Re-assembly Demonstration
	12:00-1:00	Lunch
	1:00-4:00	Initial Inspection, Safety Concerns, Checks & Trouble-Shooting, Repair Procedures & Adjustments, Older Style & Newer Style parts, Service Checks, Maintenance Of Shotgun & Cleaning procedures, Barrel Stampings & Serial Number Structure. Hands-On* Disassembly And Re-assembly Of Students' M/870's.
DAY 2	8:30-12:00	See Day 1, Afternoon Session
	12:00-1:00	Lunch
	1:00-4:00	Practical Test: Students Evaluating And Trouble-Shooting Several M/870's (Provided By Instructor) That Have Been "Tricked" With Several Mechanical Problems.
DAY 3	8:30-10:00	See Day 2, Afternoon Session
	10:00-11:00	M/700 Disassembly & Re-assembly Demonstration, Including Service Information, And Extractor/Ejector Installation And Removal
	11:00-12:00	Written Examination & Dismissal.



DEAR ARMORER:

An item that is often requested in our Armorer's School is a Remington Armorer's Tool Kit. We are pleased to announce that these are available for sale. The kit is filled with the tools that are used during our classes. Remington recommends that these tools be used to properly maintain the M/870 Police Shotguns.

If a department PO is required, we will reserve your tool kit for 30 days from receipt of your PO. These tools will be available in kit form only, and no tools will be sold separately. Please use the attached order form.

The following is a list of the tools included with the M/870 kit:

1 Hammer	1 Magnetic Screwdriver Handle
1 Fore-End Wrench	1 Square Drive or Phillips Bit
1 Trigger Plate Pin Pusher	1 Small Straight Screwdriver Bit
1 3/8" Drive "T" Handle	1 Large Straight Screwdriver Bit
1 3/8" Drive 6" Extension	1 Shell Latch Staking Tool
1 Stock Bolt Socket	1 1/8" Pin Punch
1 Cleaning Brush	1 Mag. Spring Installation Tool
1 Magazine Spring Retainer "Cork Screw"	1 .015 X 6" Shim Stock

In addition, we also offer add-on kits for the M/700 and 1187 once the basic kit for the M/870 is purchased.

We would like to thank you for your participation in our Armorer's School Program. If you have any questions feel free to contact us at 315-895-3477 or 315-895-3352.

Sincerely,

Fred Supry
Instructor

Lyle Wheelock
Instructor

Ken Nickerson
Instructor

Jason Spradling
Instructor

Dewayne Mounce
Instructor

NAME: _____

AGENCY / SECTION: _____

STREET: _____

CITY, STATE, ZIP: _____

M/870 KIT QTY: _____ ADD-ON KITS: M/700 QTY. _____ M/1187 QTY. _____

Please make checks or money orders payable to: Remington Arms Co., Inc.
L.E. Parts Dept.
P. O. Box 700
Madison, NC 27025-0700

Telephone: 1-800-243-9700
Fax to: 336-548-7801

REMINGTON

M/700 ARMORER'S CHECK LIST

ARMORER'S NAME: _____ DATE: _____

SERIAL #: _____ COMPLAINT (IF ANY): _____

LIST ANY REPAIR OR MAINTENANCE NEEDED:

1. HEADSPACE: _____

2. FUNCTION: _____

3. BOLT ASSEMBLY: _____

4. STOCK: _____

5. BARREL AND RECEIVER: _____

6. TRIGGER ASSEMBLY: _____

7. OVERALL FUNCTION: _____

OTHER CONCERNS: _____

M/700 ARMORER'S CHECK LIST

1. Check headspace with " MAX " heading plug.
2. Check feed and function of rifle w/* dummy shells.
3. Remove bolt assembly and check.
(extractor, ejector, firing pin protrusion, threads, bolt handle braze, etc.)
4. Remove stock.
(check for cracks, sling swivels, etc.)
5. Check barrel and receiver.
(straightness, bulges, cracks, sights, muzzle, bore, chamber, etc.)
6. Check trigger assembly.
(clean, screw heads covered with sealant, make sure bolt release works freely, safe works properly, trigger pull 3 ½ to 5 ½ POUNDS , etc.)

**Note: NOT TO BE ADJUSTED BY UNAUTHORIZED PERSONEL.
(FACTORY OR AUTHORIZED SERVICE CENTER ONLY)**

7. Reassemble and function test.
(secure stock to the receiver, 45 inch pounds making sure that stock is seated with barrel lug and bolt stop works properly, check loading, feed, closing, extraction, ejection, etc.

NOTE: INSTRUCT ALL USERS TO REMOVE BOLT ASSEMBLY, PLACE SAFETY TO THE FIRE POSITION, PULL AND HOLD TRIGGER TO THE REAR, PUSH DOWN ON REAR OF SEAR TO MAKE SURE IT DOES NOT BIND, RELEASE TRIGGER PUSH DOWN ON REAR OF SEAR TO MAKE SURE SEAR IS BLOCKED BY TRIGGER, AND MAKE SURE SAFETY SEPERATES CONNECTION OF SEAR AND TRIGGER.

WARNING: * ALWAYS USE FUNCTIONAL " DUMMY " SHELLS (AVAILABLE FROM REMINGTON) FOR FUNCTION TESTING, NEVER USE LIVE AMMUNITION.

NOTE: REMINGTON STRONGLY RECOMMENDS WEARING SAFETY GLASSES WHILE PERFORMING FIREARM REPAIRS.



Remington®



M/700 ARMORER'S CHECK LIST

1. Check headspace with "MAX" heading plug.
2. Check feed and function of rifle w/* dummy shells.
3. Remove bolt assembly and check.
(extractor, ejector, firing pin protrusion, threads, bolt handle braze, etc.)
4. Remove stock
(check for cracks, sling swivels, etc.)
5. Check barrel and receiver.
(straightness, bulges, cracks, sights, muzzle, bore, chamber, etc.)
6. Check trigger assembly.
(clean, screw heads covered with sealant, make sure bolt release works freely, safe works properly, trigger pull is 3 ½ to 5 ½ pounds, etc.)

**Note: NOT TO BE ADJUSTED BY UNAUTHORIZED PERSONEL.
(FACTORY OR AUTHORIZED SERVICE CENTER ONLY)**

7. Reassemble and function test.
(secure stock to the receiver 45 inch pounds making sure that stock is seated with barrel lug and bolt stop works properly, check loading, feed, closing, extraction, ejection, etc.)

**NOTE: INSTRUCT ALL USERS TO REMOVE BOLT ASSEMBLY,
PLACE SAFETY TO THE FIRE POSITION, PULL AND HOLD
TRIGGER TO THE REAR, PUSH DOWN ON REAR OF SEAR
TO MAKE SURE IT DOES NOT BIND, RELEASE TRIGGER
PUSH DOWN ON REAR OF SEAR TO MAKE SURE SEAR
IS BLOCKED BY TRIGGER, AND MAKE SURE SAFETY
SEPARATES CONNECTION OF SEAR AND TRIGGER.**

**WARNING: * ALWAYS USE FUNCTIONAL " DUMMY" SHELLS
(AVAILABLE FROM REMINGTON) FOR FUNCTION TESTING,
NEVER USE LIVE AMMUNITION.**

**NOTE: REMINGTON STRONGLY RECOMMENDS WEARING SAFETY
GLASSES WHILE PERFORMING FIREARM REPAIRS.**



Remington®



M/700 ARMORER'S CHECK LIST

ARMORER'S NAME: _____ DATE: _____

SERIAL #: _____ COMPLAINT (IF ANY): _____

LIST ANY REPAIR OR MAINTENANCE NEEDED:

1. HEADSPACE: _____

2. FUNCTION: _____

3. BOLT ASSEMBLY: _____

4. STOCK: _____

5. BARREL AND RECEIVER: _____

6. TRIGGER ASSEMBLY: _____

7. OVERALL FUNCTION: _____

OTHER
CONCERNS: _____

REMINGTON FIELD SERVICE MANUAL

The Remington Model 700 is a high power bolt action repeater available in a wide variety of center fire calibers. Two grades are supplied — ADL (standard) and BDL. Included in the BDL grade is the Model 700 VARMINT — an extremely accurate rifle expressly designed for the high velocity "varmint" calibers.

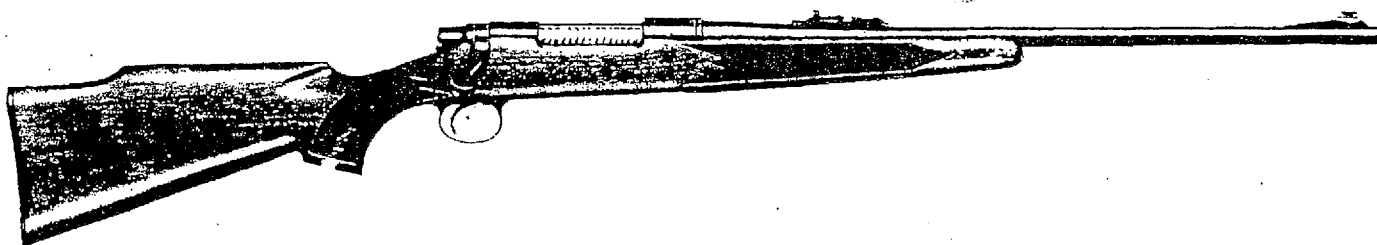

The owner's manuals RD 5461 and RD 6664 (L.H.) are packaged with each new rifle. Manuals may also be obtained from the retailer or dealer. These manuals outline operating instructions, instructions for care and maintenance of the rifle and complete parts lists and exploded views.

When handling rifle for servicing or shipping make certain rifle is empty with no rounds in magazine or chamber.

Unless described otherwise, parts are interchangeable with no factory adjustment required.

INDEX

	Page		Page
Bolt Final Assembly	1	Stock Assembly	2
Bolt Final Assembly, Components	1	Trigger Assembly	3
Firing Pin Assembly	1	Stock Assembly, Components, (ADL Grade)	3
Firing Pin Assembly, Components	1	Stock Assembly, Components, (BDL Grade)	3
Rear Sight Assembly, Components	2	Barrel Assembly	3
Front Sight Hood (BDL Grade)	2	Sling Strap Assembly and Mountings, Complete	3
Front Sight	2	Cycle of Operations	3
Front Sight Ramp	2	Malfunctions	3-4
Trigger Guard (ADL Grade)	2	Parts List	5
Trigger Guard Assembly (BDL Grade)	2	Exploded View	6
Trigger Guard Assembly, Components	2	Left Hand Model	8-9
Magazine	2		
Magazine Spring	2		

Send all guns for factory service and inquiries on service and parts to
REMINGTON ARMS COMPANY, INC.
 Arms Service Division
 Ilion, New York 13357

BOLT FINAL ASSEMBLY

To Disassemble — With safety switch forward on FIRE position lift bolt handle and pull rearward until action is halted by bolt stop. Press upward on bolt stop release — located in front of trigger and remove bolt final assembly from rifle.

To Service — Selective assembly at factory is required for replacement of bolt assemblies. However, firing, cocking, extractor and ejection parts are interchangeable and may be replaced with no factory adjustment required.

To Reassemble — With safety switch forward, insert bolt final assembly into rifle, push forward as far as possible and lower bolt handle. **Note:** Bolt must remain cocked to install. If uncocked, firing pin head will be recessed well inside bolt plug. To cock bolt, clamp firing pin head firmly to prevent movement and turn bolt with handle. Continue turning bolt handle until cocking notch on rear engages firing pin head. Bolt is then cocked and may be installed.

BOLT FINAL ASSEMBLY — COMPONENTS: Includes bolt assembly, ejector, ejector pin, ejector spring, extractor, extractor rivet, firing pin assembly. Firing pin assembly includes bolt plug, firing pin, firing pin cross pin, firing pin head and main spring.

EJECTOR — EJECTOR PIN — EJECTOR SPRING (in bolt assembly)

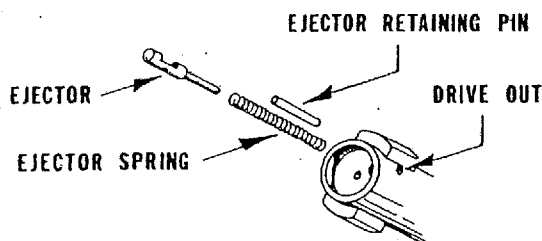

FIG. 1

To Disassemble — With bolt final assembly removed from rifle, drive out ejector pin and pull ejector spring from bolt. (See Fig. 1).

To Reassemble — Insert ejector spring and ejector into bolt. Push ejector and hold against tension of ejector spring. Align ejector pin slot in ejector to pin hole in bolt and drive in ejector pin.

Note: Assembled ejector must work freely in bolt for proper ejection.

EXTRACTOR — EXTRACTOR RIVET (in bolt assembly)

To Disassemble — Disassemble ejector and ejector spring from bolt.

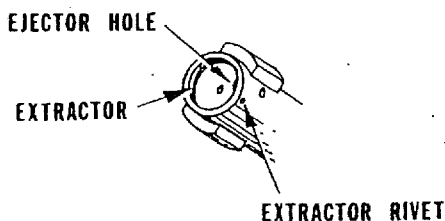

FIG. 2

Drive extractor rivet from bolt. (See Fig. 2). Dislodge and remove loosened extractor from inside bolt rim.

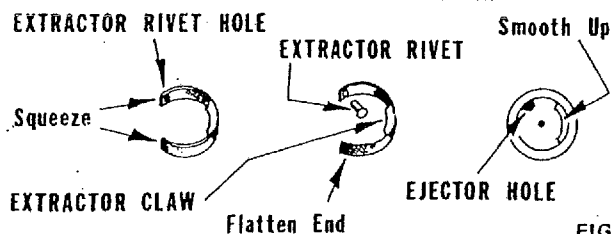

FIG. 3

To Service — Parts are interchangeable. Extractor rivet will most likely be damaged when driven from bolt and replacement rivet should be used in reassembly.

To Reassemble — Adjust replacement extractor for proper tension **before reassembly** as follows: Squeeze ends of extractor together slightly. (See Fig. 3). Straighten tail of extractor. (See Fig. 3). Place extractor inside rim in bolt face. Align hole in extractor with rivet hole in bolt. Insert extractor rivet.

Note: If original disassembled extractor is reassembled, adjustment for proper tension before reassembly may not be necessary.

Place support inside of bolt rim and against head of rivet. Peen over protruding end of rivet to tighten extractor in bolt. Reassemble ejector. Smooth up peening to blend with outside of bolt. Check extractor for proper tension using a fired case. Extractor must grip case firmly and hold case when breech is held face downwards.

If fired case is gripped too tightly (case snaps free with difficulty) tap extractor back under bolt rim using a soft metal punch. Test with fired case. Repeat, if necessary, until gripping pressure of extractor is satisfactory.

If fired case is gripped too loosely (case falls away when bolt is held face downward) extractor must be pulled from under rim to increase tension against case. Disassemble, if necessary, and rebend extractor as indicated in Fig. 3.

After tension has been adjusted satisfactorily, smooth up incline on extractor to match perfectly to breech bolt rim. (See Fig. 3).

Note: An earlier design, in 222 caliber, incorporated a "snap in" type extractor requiring no rivet. These may easily be disassembled and reassembled by inserting pointed tweezers into holes provided in ends of extractor and compressing ends together. When reassembling, hook on extractor should face bolt.

FIRING PIN ASSEMBLY FROM BOLT ASSEMBLY

To Disassemble — Remove bolt final assembly from rifle. Pull firing pin head rearward until coin or washer can be inserted into slot near back edge of firing pin head. (See Fig. 4). Unscrew and remove firing pin assembly from bolt assembly.

FIG. 4

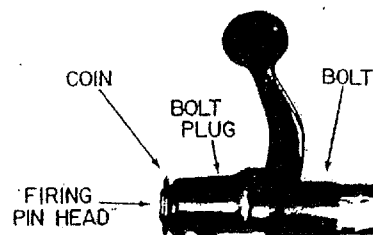

To Service — Firing pin assembly is interchangeable and may be replaced as a unit with no factory adjustment required. Replacement of bolt assembly requires selective assembly for proper function.

To Reassemble — Follow reverse order.

FIRING PIN ASSEMBLY — COMPONENTS: Includes bolt plug, firing pin, firing pin cross pin, firing pin head, main spring.

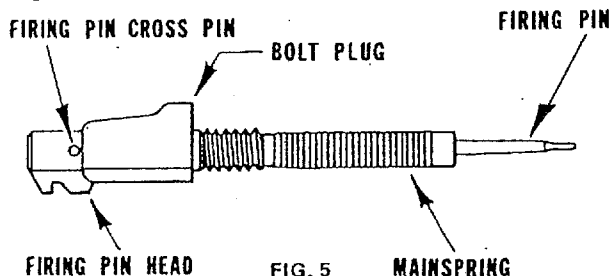

FIG. 5

To Disassemble — (with firing pin assembly removed from bolt).

Caution: Main spring is under compression. Disassembly of this unit is not recommended unless necessary for replacement of damaged parts. Suitable holding means must be used to prevent firing pin and / or firing pin head from flying free when cross pin is driven out.

Compress mainspring until firing pin cross pin is exposed. Hold firing pin and firing pin head securely and drive out cross pin. (See Fig. 5). Release parts carefully and disassemble.

To Service — All parts in firing pin assembly are interchangeable with no factory fitting required. However, if replacing firing pin, a hole drilling operation in shank of firing pin is necessary. To do this, use a No. 42 size drill (.093).

Assemble shank of replacement firing pin into firing pin head. Make sure recess in head is clean and free of any obstructions. Seat shank of firing pin firmly onto firing pin head. Align drill through cross pin hole in firing pin head. Drill through firing pin shank.

To Reassemble — Reassemble all parts of firing pin assembly. Hold bolt plug against tension of reassembled main spring. Insert firing pin cross pin through firing pin head and shank of firing pin. Release tension on bolt plug.

REAR SIGHT ASSEMBLY (Includes rear sight aperture, rear sight base, rear sight base screw (2), rear sight slide, elevation screw, windage screw).

To Disassemble — Unscrew windage and elevation screws and remove rear sight aperture and rear sight slide from base. Unscrew and remove rear sight base screws and rear sight base.

To Reassemble — Follow reverse order. All parts are interchangeable.

FRONT SIGHT HOOD (BDL Grade only)

To Disassemble — Pry bottom ears of hood apart slightly until hood can be slid forward and away from front sight base.

To Service — Interchangeable on all BDL grade front sight ramps. No factory adjustment required.

To Reassemble — Follow reverse order.

FRONT SIGHT

To Disassemble — Drive front sight out of front sight ramp from left to right. To prevent damage to sight a soft metal punch should be used.

To Reassemble — Follow reverse order.

FRONT SIGHT RAMP

To Disassemble — Unscrew and remove front sight ramp screws and front sight ramp.

To Reassemble — Follow reverse order.

TRIGGER GUARD (ADL Grade)

To Disassemble — Unscrew and remove trigger guard screws and disassemble trigger guard from stock.

To Reassemble — Follow reverse order.

TRIGGER GUARD ASSEMBLY (BDL Grade)

To Disassemble — Remove bolt assembly. Unscrew and remove front and rear guard screws. Lift loosened stock assembly from trigger and disassemble trigger guard from stock assembly.

Note: To remove magazine follower and spring (assembled to floor plate) unlatch floor plate. Lift folded end of spring upward, pull back and disassemble from floor plate.

To Reassemble — Follow reverse order. Tighten screws firmly.

TRIGGER GUARD ASSEMBLY — COMPONENTS (BDL Grade) Includes floor plate, floor plate latch, floor plate latch pin, floor plate latch spring, floor plate pivot pin, trigger guard.

To Disassemble — Drive out floor plate pivot pin and remove floor plate from trigger guard.

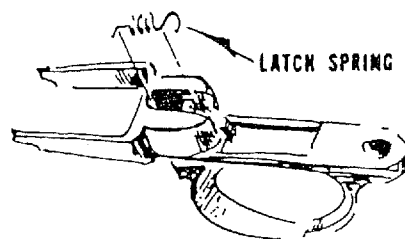

FIG. 6

Caution: Pivot pin is tight fitting. Support trigger guard properly to prevent damage to front section.

Unhook rear of floor plate latch spring from floor plate latch and front end of spring from trigger guard. Remove spring from guard (See Fig. 6)

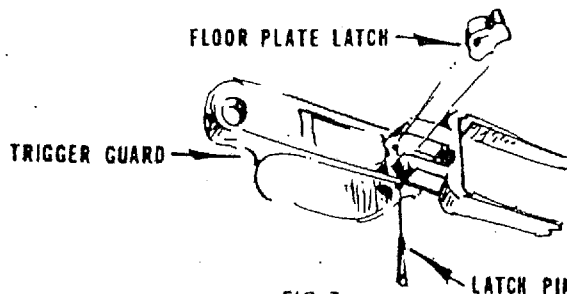

FIG. 7

Drive out floor plate latch pin — left to right and remove floor plate latch from trigger guard. (See Fig. 7).

To Reassemble — Follow reverse order. Floor plate should swing freely and latch properly.

MAGAZINE — MAGAZINE FOLLOWER — MAGAZINE SPRING

To Disassemble — Remove bolt final assembly. Remove trigger guard or (in BDL grade) trigger guard assembly. Remove stock assembly. Remove magazine follower and spring. Unscrew magazine tab screw (ADL grade only) and remove magazine. BDL grade magazines are disassembled by simply lifting from receiver.

To Reassemble — Follow reverse order.

TRIGGER HOUSING ASSEMBLY

NOTE: FACTORY SERVICE IS REQUIRED FOR ALL TRIGGER HOUSING ASSEMBLY RELATED PROBLEMS. RETURN THE FIREARM TO THE FACTORY FOR SERVICE.

STOCK ASSEMBLY

To Disassemble — Remove trigger guard or trigger guard assembly and remove stock assembly.

To Reassemble — Follow reverse order. Tighten screws securely.

STOCK ASSEMBLY — COMPONENTS (ADL Grade) includes butt plate, butt plate screw (4), front guard screw bushing, stock, stock reinforcing screw, stock reinforcing screw dowel.

To Disassemble — Unscrew and remove butt plate screws and butt plate. Front guard screw bushing may be removed for replacement, if necessary, by driving out with a tool from inside of stock. Tap against inner edge of bushing until it comes free from stock. Avoid damage to stock.

To Reassemble — Follow reverse order. Replacement butt plate may require edge sanding to match stock outline.

STOCK ASSEMBLY — COMPONENTS (BDL Grade) includes ADL grade components plus butt plate spacer, fore-end tip, fore-end tip spacer, grip cap, grip cap spacer, front swivel nut.

To Disassemble— See disassembly of ADL grade. Front swivel nut may be disassembled for replacement by carefully driving out from inside of stock.

To Reassemble— Follow reverse order.

BARREL ASSEMBLY — Includes barrel, barrel brackets, receiver. Selective factory assembly is required for replacement of parts and to insure proper operation with bolt final assembly. Disassembly is not recommended. Replace as a unit.

SLING STRAP ASSEMBLY AND MOUNTINGS, COMPLETE: Includes front swivel nut, front swivel screw, rear swivel screw, sling strap assembly, swivel assembly, Q.D. (2).

Note: Sling Strap Assembly includes sling strap, fastener, keeper and buckle. Strap is 7/8" wide. Swivel assemblies are (Q.D.) type.

A sling strap complete with mountings is packaged with each BDL Grade rifle. When attaching to rifle — assemble both quick detachable (Q.D.) swivel assemblies to stock. To do this, push plunger on swivel until small plate lifts and can be swung free of attaching stud on swivel. Then insert attaching stud into eye of stock screw. Close plate on swivel to lock swivel to stock screw.

To attach strap to swivels — insert tongue of strap into rear swivel. Loop strap back and through attached keeper band. Insert strap into and through buckle and front swivel. Loop back and secure with brass fastener. Adjust trap to desired position.

To remove strap from rifle, simply snap quick detachable swivels from stock screws and remove strap.

CYCLE OF OPERATION

The operation cycle of the Model 700 follows the basic pattern of bolt action rifles. After firing, raising of bolt handle will unlock action. Pulling bolt rearward will open action and extract and eject any fired case or round that may be in chamber. Pushing bolt handle forward and down closes and locks action — completing the cycle. Each operation is described in sequence below:

FIRING

With action closed and locked and safety switch in forward or FIRE position, rifle can be fired by pulling trigger. Pulling or squeezing trigger moves trigger connector forward, leaving sear unsupported against cocked firing pin head. With support removed, sear is cammed down by pressure of spring-loaded firing pin and firing pin is driven forward to strike primer.

UNLOCKING

Raising of bolt handle unseats locking lugs on bolt head from recoil shoulders in receiver.

COCKING

Cocking takes place as bolt handle is raised. A cam at rear of rotating bolt forces firing pin assembly rearward, compressing main spring, and holding assembly in cocked position in a notch at rear of bolt. This engagement holds until bolt handle is lowered again during locking cycle. Engagement is then transferred to sear to cock rifle.

EXTRACTION

This phase of operation cycle consists of two parts referred to as (1) primary extraction, and (2) secondary extraction. Primary extraction occurs simultaneously with unlocking. The rim of case, being completely encased by bolt head, is gripped

by a circular recessed claw-type extractor. During final upward throw of bolt handle, a primary extraction cam retracts bolt approximately 1/8" with a mechanical advantage of about 8 to 1, completing primary portion of this phase. Bolt lugs are now free of locking shoulders in receiver and bolt may now be moved to rear — completing second phase of extraction

EJECTION

Within the bolt face, maintaining constant pressure on head of cartridge, is a spring-loaded ejector. As bolt is retracted and front edge of cartridge reaches ejection port, pressure along with opposing grip of extractor, ejects cartridge from port. Rearward motion of bolt is arrested by bolt stop.

FEEDING

With bolt stopped in rearward position, topmost cartridge in magazine will be urged upwards by magazine spring. It is held in position until carried forward by bolt into loading cycle.

LOADING

In closing the action, bolt pushes cartridge from magazine into barrel chamber. Feeding lips on top of magazine guide cartridge until bullet enters chamber.

LOCKING

Rotating bolt handle downward locks cartridge in barrel chamber. Four engagements are made in this cycle: (1) Locking lugs on bolt head are engaged with recoil shoulders in receiver. (2) Head of cartridge is seated into bolt head, depressing ejector while extractor claw is snapped over rim of cartridge. (3) Sear engages and locks firing pin in a cocked position by action of (4) Sear being supported from beneath by connector. Rifle is now ready for firing by release of trigger.

SAFETY SWITCH

The safety switch, located at right rear of receiver is operated by a push and pull action on the safety switch button. This two-position safety switch has two internal functions. When safety switch is rotated rearward, a cam is brought into position beneath sear safety cam. This locks cam against firing pin and prevents rifle from firing. Second function of safety switch in SAFE position ("S" marking) brings an arm into slot in bolt preventing bolt from being opened. Pushing safety switch forward to FIRE position ("F" marking) nullifies above conditions and rifle may be fired.

MALFUNCTIONS

Cause and Correction

Over-Ride

- Cause:**
1. Magazine Follower binds.
 2. Damaged Follower Spring.
 3. Magazine Spring caught under Guard.
 4. Tabs on Follower bent.

- Correction:**
1. Adjust side angle on Magazine Box.
 2. Change Spring.
 3. Correct.
 4. Straighten or replace Follower.

Stems Chamber

- Cause:**
1. Sharp or rough Receiver Rails.
 2. Sharp edge - rear end of Chamber.
 3. Rough Ramp in Receiver.
 4. Magazine Box loose in Receiver.

- Correction:**
1. Polish or file.
 2. Remove sharpness.
 3. Polish Ramp.
 4. Adjust.

Bolt Closes Hard Over Shells

- Cause:**
1. Bolt interferes with shell rim.
 2. Extractor interferes with shell rim.
 3. Ejector binds or fails to retract far enough.
 4. Burr at Ejector Hole on Bolt.
 5. Sharp corners on Bolt Lugs.
 6. Extractor Rivet loose.

- Correction:**
1. Remove interference or change Bolt.
 2. Fit new Extractor (grind relief in new Extractor behind Claw).
 3. Free up or replace.
 4. Deburr.
 5. File radius.
 6. Tighten or replace Rivet.

Fails to Extract

- Cause:**
1. Tight, rough or oversize Chamber.
 2. Extractor broken or damaged.
 3. Not enough Hook space on Extractor.
 4. Height of Claw not correct.
 5. Extractor stuck back.

- Correction:**
1. Ream if tight or rough.
Change Barrel Assembly if oversize.
 2. Fit new Extractor.
 3. Fit new Extractor.
 4. Fit new Extractor.
 5. Replace Extractor.

Fails To Eject

- Cause:**
1. Burr at Ejector Hole in Bolt.
 2. Ejector binds or fails to retract far enough.
 3. Extractor Rivet loose.
 4. Extractor drops shell.

- Correction:**
1. Deburr.
 2. Free up or replace.
 3. Re-stake or replace.
 4. Replace Extractor.

Misfires

- Cause:**
1. Short Firing Pin (damaged).
 2. Firing Pin binds.
 3. Short Firing Pin protrusion.
 4. Firing Control out of adjustment.
 5. Faulty ammunition.

- Correction:**
1. Replace.
 2. Free up or replace.
 3. Change Firing Pin or Bolt.
 4. Return the firearm to the factory.
 5. Replace ammunition.

Follows Down

- Cause:**
1. Trigger out of adjustment.
 2. Improper vertical engagement of Sear and Connector.
 3. Trigger doesn't retract.
 4. Corners on Sear or Connector rounded.
 5. Trigger binds on Trigger Guard.
 6. Not enough tension on Weight Screw (light pull).

- Correction:**
1. Return the firearm to the factory.
 2. Return the firearm to the factory.
 3. Return the firearm to the factory.
 4. Return the firearm to the factory.
 5. File Trigger Guard - eliminate interference.
 6. Return the firearm to the factory.

Bolt Opens Hard

- Cause:**
1. See Fails to Extract.
 2. Upset Extraction Cam on Bolt Handle.
 3. Burr at Ejector Hole in Bolt.
 4. Blown or set back Primer on shell.

- Correction:**
1. See Fails to Extract.
 2. Smooth up.
 3. Deburr.
 4. Ream Chamber if throat is shallow (ammunition may be at fault).

Bolt Pulls Out

- Cause:**
1. Bolt Stop or Bolt Release binds.
 2. Bolt Stop or Bolt Release broken.

- Correction:**
1. Return the firearm to the factory.
 2. Return the firearm to the factory.

Safety Switch Works Too Hard or Too Freely

- Cause:**
1. Safety switch binds (works hard).
 2. Safety switch Snap Washer stretched out (Safety Switch works too freely.)

- Correction:**
1. Return the firearm to the factory.
 2. Return the firearm to the factory.

Bulges or Blows Cases

- Cause:**
1. Oversize Chamber.
 2. Maximum head space.

- Correction:**
1. Change Barrel or Barrel and Receiver Assembly.
 2. Fit new Bolt (ammunition may be at fault).

Bolt Binds

- Cause:**
1. Guard Screws protrude into Bolt track.
 2. Scope Screws protrude into Bolt track.
 3. Bolt Handle interference on Stock.
 4. Step at rear of Bolt Lugs.

- Correction:**
1. File ends of Screws.
 2. File ends of Screws.
 3. Correct Stock or fit new Stock.
 4. File to blend.

View No.	NAME OF PART	View No.	NAME OF PART
NOTE: Basic 30-06 Caliber listed below. See Sectional View for proper identity of parts.			
1	Barrel Assembly	35	Main Spring
2	Bolt Assembly	36	Rear Guard Screw
	Bolt Final Assembly	37	Rear Sight Aperture
3	Bolt Plug	38	Rear Sight Base
4	Bolt Stop (Restricted)	39	Rear Sight Base Screw (2)
5	Bolt Stop Pin (Restricted)	40	Rear Sight Slide
6	Bolt Stop Release (Restricted)	41	Elevation Screw
7	Bolt Stop Spring (Restricted)	42	Windage Screw
8	Butt Plate	43	Rear Swivel Screw, BDL Grade
8a	Butt Plate Spacer, BDL	44	Receiver Plug Screw
9	Butt Plate Screw	45	Safety Switch Assembly (Restricted)
10	Center Guard Screw, ADL Grade	46	Safety Switch Detent Ball (Restricted)
11	Ejector	47	Safety Switch Detent Spring (Restricted)
12	Ejector Pin	48	Safety Switch Pivot Pin (Restricted)
13	Ejector Spring	49	Safety Switch Snap Washer (Restricted)
14	Extractor	50	Sear Safety Cam (Restricted)
	Fastener, Sling Strap	51	Sear Pin (Restricted)
16	Firing Pin	52	Sear Spring (Restricted)
17	Firing Pin Assembly	53	Sling Strap Assembly, BDL Grade
18	Firing Pin Cross Pin		Sling Strap Assembly and Mountings Complete
20	Floor Plate Latch, BDL Grade	54	Stock Assembly, ADL Grade
21	Floor Plate Latch Pin, BDL Grade		Stock Assembly, BDL Grade
22	Floor Plate Latch Spring, BDL Grade		Stock Reinforcing Screw (not shown)
23	Floor Plate Pivot Pin, BDL Grade		Stock Reinforcing Screw Dowel (not shown)
24	Front Guard Screw	55	Swivel Assembly, BDL Grade (Q.D.)
25	Front Guard Screw Bushing, ADL Grade	56	Trigger (Restricted)
26	Front Sight	57	Trigger Adjusting Screw (Restricted)
	Front Sight (Low)		Trigger Assembly (Restricted)
27	Front Sight Ramp	58	Trigger Connector (Restricted)
	Front Sight Ramp, BDL Grade	59	Trigger Engagement Screw (Restricted)
28	Front Sight Ramp Screw	60	Trigger Guard
29	Front Sight Hood, BDL Grade	61	Trigger Guard, BDL Grade
30	Front Swivel Nut, BDL Grade		Trigger Guard Assembly, BDL Grade
31	Front Swivel Screw, BDL Grade	62	Trigger Housing Assembly (Restricted)
	Grip Cap, BDL Grade (not shown)	63	Trigger Pin (Restricted)
	Grip Cap Screw	64	Trigger Spring (Restricted)
	Grip Cap Spacer, BDL Grade (not shown)	65	Trigger Stop Screw (Restricted)
32	Magazine, ADL Grade		
	Magazine, BDL Grade (not shown)		
33	Magazine Follower		
	Magazine Follower, BDL Grade		
	Magazine Tab Screw, ADL Grade		
34	Magazine Spring		
	Magazine Spring, BDL Grade		

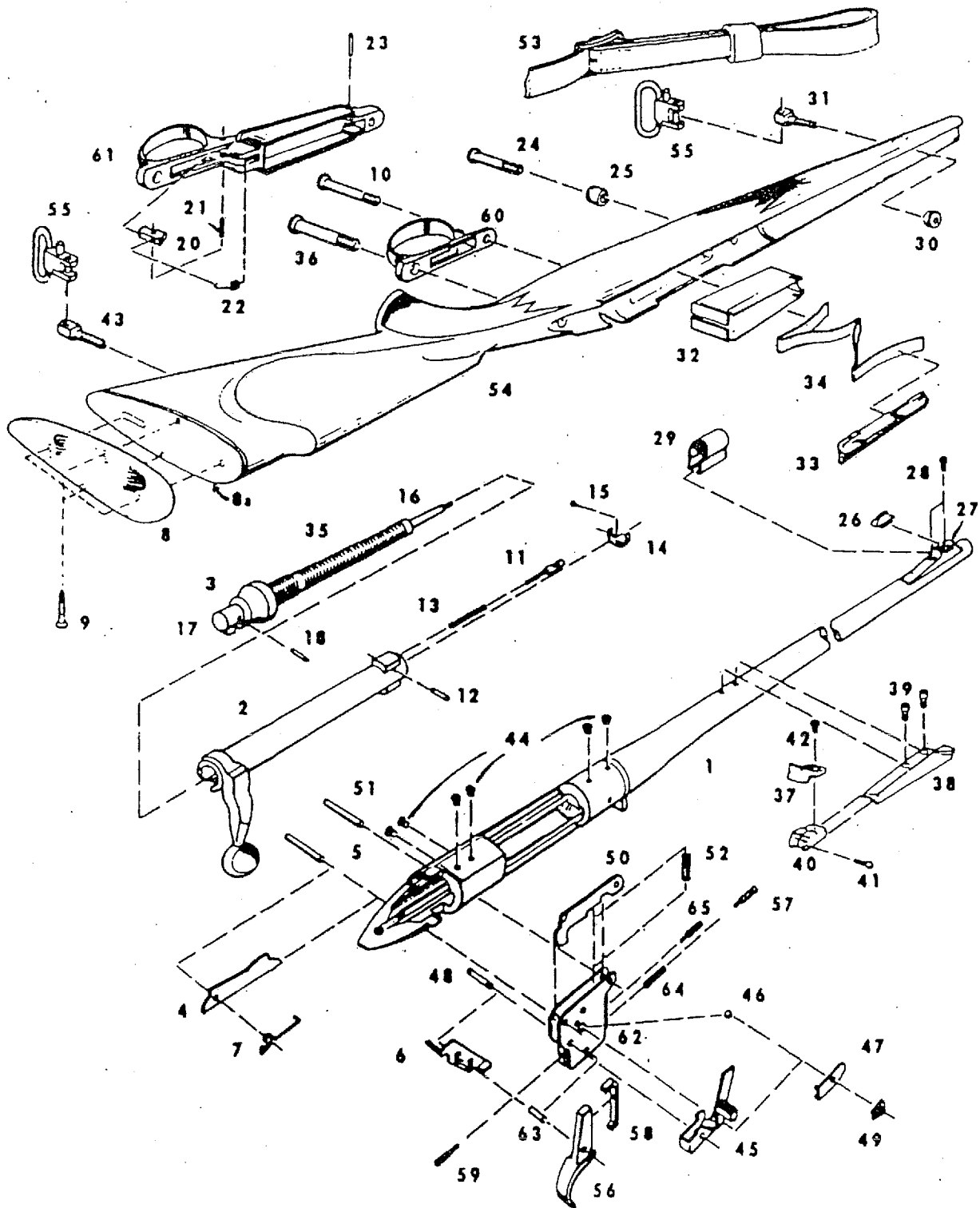

MALFUNCTIONS

CAUSE and CORRECTION

(Con't. from Page 4)

Doesn't Group

- Cause:
1. Crown of Barrel damaged.
 2. Leading of Bore.
 3. Oversize Bore.
 4. Improper bedding of Barrel in Stock.
 5. Loose Sights.

- Correction:
1. Recrown.
 2. Lead or change Barrel.
 3. Change Barrel.
 4. Correct bedding.
 5. Tighten or replace.

Point of Impact Not Correct

- Cause:
1. Barrel not straight.
 2. Horns, breaks, etc. in Bore.
 3. Improper or loose Sights.

- Correction:
1. Straighten.
 2. Correct if possible.
 3. Tighten or change Sights.

REMINGTON FIELD SERVICE MANUAL

View No	NAME OF PART		View No	NAME OF PART	
NOTE:	Basic 30-06 caliber listed below.		46	Safety Switch Pivot Pin	(Restricted)
1	Barrel Assembly		47	Safety Switch Snap Washer	(Restricted)
2	Bolt Assembly		48	Sear Safety Cam	(Restricted)
	Bolt Final Assembly		49	Sear Pin	(Restricted)
3	Bolt Plug		50	Sear Spring	(Restricted)
4	Bolt Stop	(Restricted)	51	Sling Strap Assembly	
5	Bolt Stop Pin	(Restricted)		Sling Strap Assembly and Mountings Complete	
6	Bolt Stop Release	(Restricted)	52	Stock Assembly	
7	Bolt Stop Spring	(Restricted)		Stock Reinforcing Screw	
8	Butt Plate			Stock Reinforcing Screw Dowel	
8a	Butt Plate Spacer		53	Swivel Assembly (O.D.)	
9	Butt Plate Screw		54	Trigger	(Restricted)
10	Ejector		55	Trigger Adjusting Screw	(Restricted)
11	Ejector Pin			Trigger Assembly	(Restricted)
12	Ejector Spring		56	Trigger Connector	(Restricted)
13	Extractor		57	Trigger Engagement Screw	(Restricted)
14	Extractor Rivet		58	Trigger Guard	
	Fastener, Sling Strap			Trigger Guard Assembly	
15	Firing Pin		59	Trigger Housing Assembly	(Restricted)
16	Firing Pin Assembly		60	Trigger Pin	(Restricted)
17	Firing Pin Cross Pin		61	Trigger Spring	(Restricted)
19	Floor Plate Latch		62	Trigger Stop Screw	(Restricted)
20	Floor Plate Latch Pin				
21	Floor Plate Latch Spring				
22	Floor Plate Pivot Pin				
23	Front Guard Screw				
24	Front Sight				
	Front Sight (Low)				
25	Front Sight Ramp				
26	Front Sight Ramp Screw				
27	Front Sight Hood				
28	Front Swivel Nut				
29	Front Swivel Screw				
	Grip Cap				
	Grip Cap Spacer				
	Grip Cap Spacer Screw				
30	Magazine				
31	Magazine Follower				
32	Magazine Spring				
33	Main Spring				
34	Rear Guard Screw				
35	Rear Sight Aperture				
36	Rear Sight Base				
37	Rear Sight Screw				
38	Rear Sight Slide				
39	Elevation Screw				
40	Windage Screw				
41	Rear Swivel Screw				
42	Receiver Plug Screw				
43	Safety Switch Assembly	(Restricted)			
44	Safety Switch Detent Ball	(Restricted)			
45	Safety Switch Detent Spring	(Restricted)			

MODEL
700
LEFT HAND MODEL

REMINGTON FIELD SERVICE MANUAL

EXPLODED
VIEW

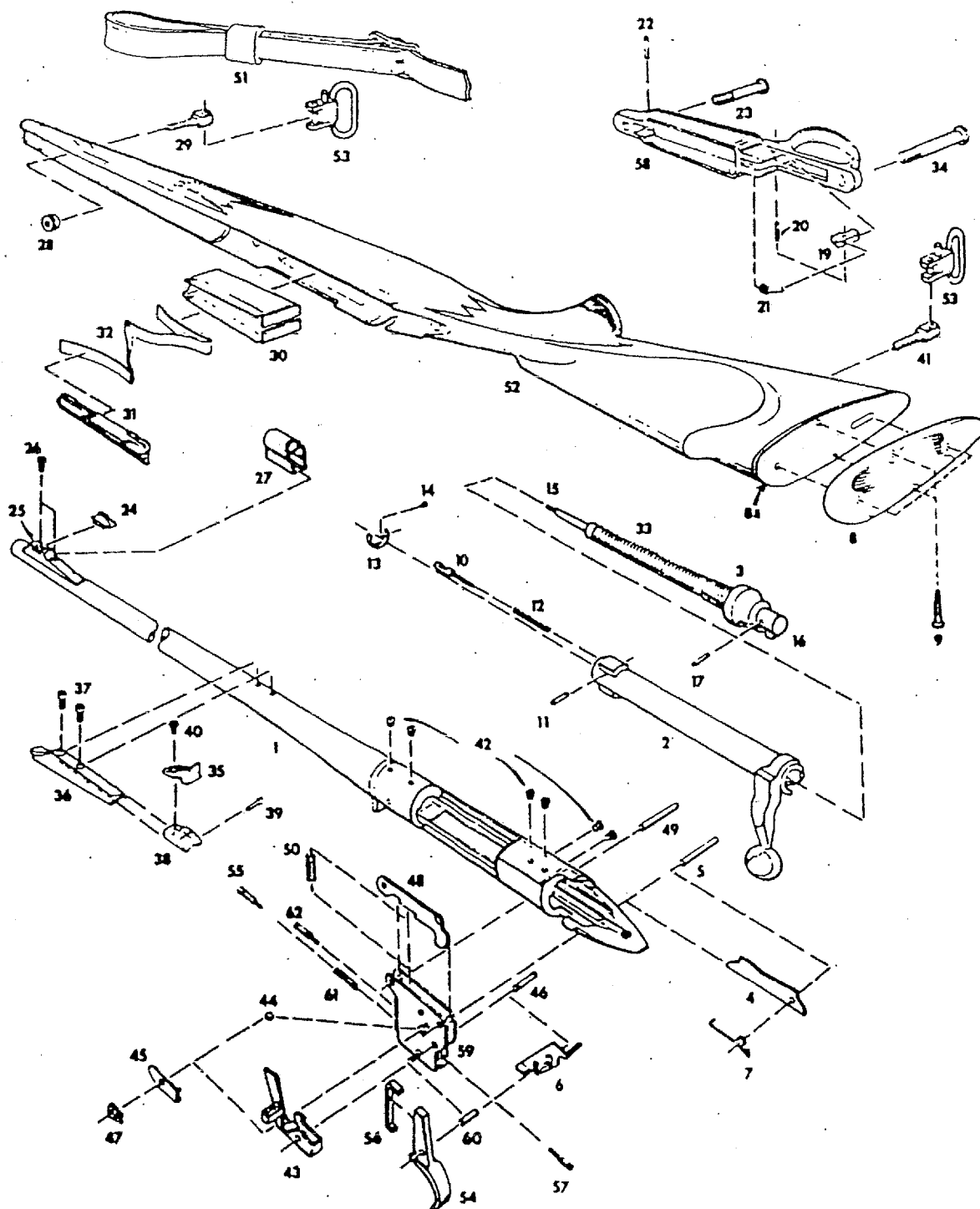

REMINGTON FIELD SERVICE MANUAL

The Remington Model 700 is a high power bolt action repeater available in a wide variety of center fire calibers. Two grades are supplied — ADL (standard) and BDL. Included in the BDL grade is the Model 700 VARMINT — an extremely accurate rifle expressly designed for the high velocity "varmint" calibers.

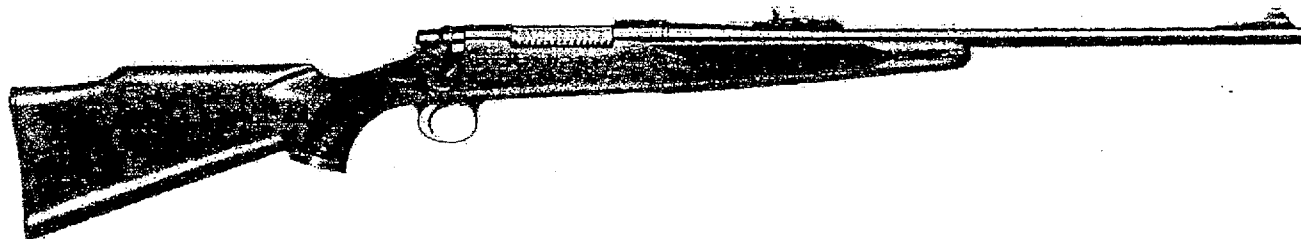

The owner's manuals RD 5461 and RD 6664 (L.H.) are packaged with each new rifle. Manuals may also be obtained from the retailer or dealer. These manuals outline operating instructions, instructions for care and maintenance of the rifle and complete parts lists and exploded views.

When handling rifle for servicing or shipping make certain rifle is empty with no rounds in magazine or chamber. Unless described otherwise, parts are interchangeable with no factory adjustment required.

INDEX

	Page		Page
Bolt Final Assembly	1	Stock Assembly	2
Bolt Final Assembly, Components	1	Trigger Assembly	3
Firing Pin Assembly	1	Stock Assembly, Components, (ADL Grade)	3
Firing Pin Assembly, Components	1	Stock Assembly, Components, (BDL Grade)	3
Rear Sight Assembly, Components	2	Barrel Assembly	3
Front Sight Hood (BDL Grade)	2	Sling Strap Assembly and Mountings, Complete	3
Front Sight	2	Cycle of Operations	3
Front Sight Ramp	2	Malfunctions	3-4
Trigger Guard (ADL Grade)	2	Parts List	5
Trigger Guard Assembly (BDL Grade)	2	Exploded View	6
Trigger Guard Assembly, Components	2	Parts List (additional calibers)	7
Magazine	2	Left Hand Model	9-10
Magazine Spring	2		

BOLT FINAL ASSEMBLY

To Disassemble — With safety switch forward on FIRE position lift bolt handle and pull rearward until action is halted by bolt stop. Press upward on bolt stop release — located in front of trigger and remove bolt final assembly from rifle.

To Service — Selective assembly at factory is required for replacement of bolt assemblies. However, firing, cocking, extractor and ejection parts are interchangeable and may be replaced with no factory adjustment required.

To Reassemble — With safety switch forward, insert bolt final assembly into rifle, push forward as far as possible and lower bolt handle. **Note:** Bolt must remain cocked to install. If uncocked, firing pin head will be recessed well inside bolt plug. To cock bolt, clamp firing pin head firmly to prevent movement and turn bolt with handle. Continue turning bolt handle until cocking notch on rear engages firing pin head. Bolt is then cocked and may be installed.

BOLT FINAL ASSEMBLY — COMPONENTS: Includes bolt assembly, ejector, ejector pin, ejector spring, extractor, extractor rivet, firing pin assembly. Firing pin assembly includes bolt plug, firing pin, firing pin cross pin, firing pin head and main spring.

EJECTOR — EJECTOR PIN — EJECTOR SPRING (in bolt assembly)

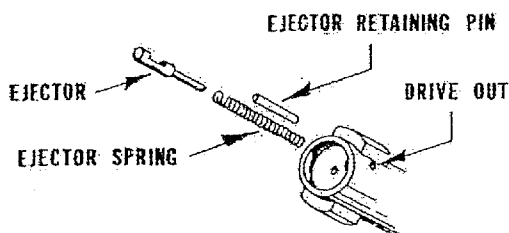

FIG. 1

To Disassemble — With bolt final assembly removed from rifle, drive out ejector pin and pull ejector spring from bolt. (See Fig. 1).

To Reassemble — Insert ejector spring and ejector into bolt. Push ejector and hold against tension of ejector spring. Align ejector pin slot in ejector to pin hole in bolt and drive in ejector pin.

Note: Assembled ejector must work freely in bolt for proper ejection.

EXTRACTOR — EXTRACTOR RIVET (in bolt assembly)

To Disassemble — Disassemble ejector and ejector spring from bolt.

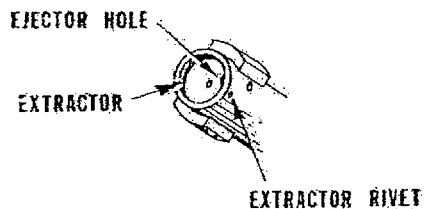

FIG. 2

Drive extractor rivet from bolt. (See Fig. 2). Dislodge and remove loosened extractor from inside bolt rim.

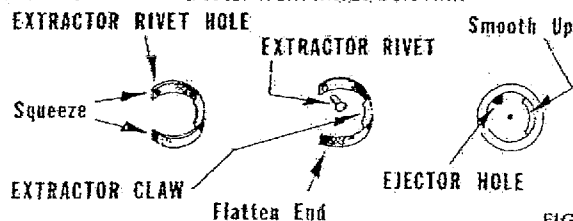

FIG. 3

To Service — Parts are interchangeable. Extractor rivet will most likely be damaged when driven from bolt and replacement rivet should be used in reassembly.

To Reassemble — Adjust replacement extractor for proper tension before reassembly as follows: Squeeze ends of extractor together slightly. (See Fig. 3). Place extractor inside rim in bolt face. Align hole in extractor with rivet hole in bolt. Insert extractor rivet.

Note: If original disassembled extractor is reassembled, adjustment for proper tension before reassembly may not be necessary.

Place support inside of bolt rim and against head of rivet. Peen over protruding end of rivet to tighten extractor in bolt. Reassemble ejector. Smooth up peening to blend with outside of bolt. Check extractor for proper tension using a fired case. Extractor must grip case firmly and hold case when breech is held face downwards.

If fired case is gripped too tightly (case snaps free with difficulty) tap extractor back under bolt rim using a soft metal punch. Test with fired case. Repeat, if necessary, until gripping pressure of extractor is satisfactory.

If fired case is gripped too loosely (case falls away when bolt is held face downward) extractor must be pulled from under rim to increase tension against case. Disassemble, if necessary, and rebend extractor as indicated in Fig. 3.

After tension has been adjusted satisfactorily, smooth up incline on extractor to match perfectly to breech bolt rim. (See Fig. 3).

Note: An earlier design, in 222 caliber, incorporated a "snap in" type extractor requiring no rivet. These may easily be disassembled and reassembled by inserting pointed tweezers into holes provided in ends of extractor and compressing ends together. When reassembling, hook on extractor should face bolt.

FIRING PIN ASSEMBLY FROM BOLT ASSEMBLY

To Disassemble — Remove bolt final assembly from rifle. Pull firing pin head rearward until coin or washer can be inserted into slot near back edge of firing pin head. (See Fig. 4). Unscrew and remove firing pin assembly from bolt assembly.

FIG. 4

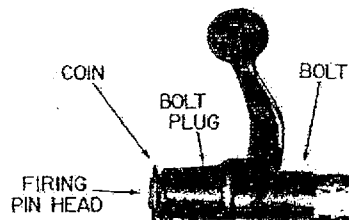

To Service — Firing pin assembly is interchangeable and may be replaced as a unit with no factory adjustment required. Replacement of bolt assembly requires selective assembly for proper function.

To Reassemble — Follow reverse order.

FIRING PIN ASSEMBLY — COMPONENTS: Includes bolt plug, firing pin, firing pin cross pin, firing pin head, main spring.

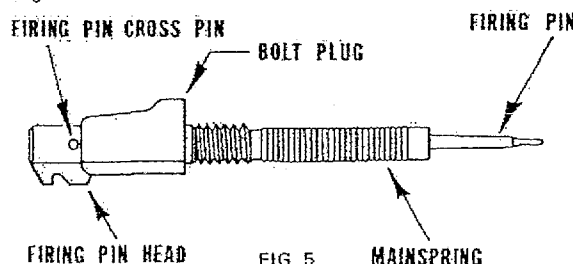

FIG. 5

To Disassemble — (with firing pin assembly removed from bolt).

Caution: Main spring is under compression. Disassembly of this unit is **not recommended** unless necessary for replacement of damaged parts. Suitable holding means must be used to prevent firing pin and / or firing pin head from flying free when cross pin is driven out.

Compress mainspring until firing pin cross pin is exposed. Hold firing pin and firing pin head securely and drive out cross pin. (See Fig. 5). Release parts carefully and disassemble.

To Service — All parts in firing pin assembly are interchangeable with no factory fitting required. However, if replacing firing pin; a hole drilling operation in shank of firing pin is necessary. To do this, use a No. 42 size drill (.093).

Assemble shank of replacement firing pin into firing pin head. Make sure recess in head is clean and free of any obstructions. Seat shank of firing pin firmly onto firing pin head. Align drill through cross pin hole in firing pin head. Drill through firing pin shank.

To Reassemble — Reassemble all parts of firing pin assembly. Hold bolt plug against tension of reassembled main spring. Insert firing pin cross pin through firing pin head and shank of firing pin. Release tension on bolt plug.

REAR SIGHT ASSEMBLY (Includes rear sight aperture, rear sight base, rear sight base screw (2), rear sight slide, elevation screw, windage screw).

To Disassemble — Unscrew windage and elevation screws and remove rear sight aperture and rear sight slide from base. Unscrew and remove rear sight base screws and rear sight base.

To Reassemble — Follow reverse order. All parts are interchangeable.

FRONT SIGHT HOOD (BDL Grade only)

To Disassemble — Pry bottom ears of hood apart slightly until hood can be slid forward and away from front sight base.

To Service — Interchangeable on all BDL grade front sight ramps. No factory adjustment required.

To Reassemble — Follow reverse order.

FRONT SIGHT

To Disassemble — Drive front sight out of front sight ramp from left to right. To prevent damage to sight a soft metal punch should be used.

To Reassemble — Follow reverse order.

FRONT SIGHT RAMP

To Disassemble — Unscrew and remove front sight ramp screws and front sight ramp.

To Reassemble — Follow reverse order.

TRIGGER GUARD (ADL Grade)

To Disassemble — Unscrew and remove trigger guard screws and disassemble trigger guard from stock.

To Reassemble — Follow reverse order.

TRIGGER GUARD ASSEMBLY (BDL Grade)

To Disassemble — Remove bolt assembly. Unscrew and remove front and rear guard screws. Lift loosened stock assembly from trigger and disassemble trigger guard from stock assembly.

Note: To remove magazine follower and spring (assembled to floor plate) unlatch floor plate. Lift folded end of spring upward, pull back and disassemble from floor plate.

To Reassemble — Follow reverse order. Tighten screws firmly.

TRIGGER GUARD ASSEMBLY — COMPONENTS (BDL Grade) Includes floor plate, floor plate latch, floor plate latch pin, floor plate latch spring, floor plate pivot pin, trigger guard.

To Disassemble — Drive out floor plate pivot pin and remove floor plate from trigger guard.

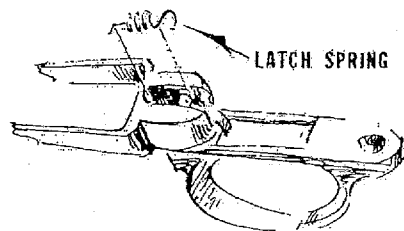

FIG. 6

Caution: Pivot pin is tight fitting. Support trigger guard properly to prevent damage to front section.

Unhook rear of floor plate latch spring from floor plate latch and front end of spring from trigger guard. Remove spring from guard (See Fig. 6)

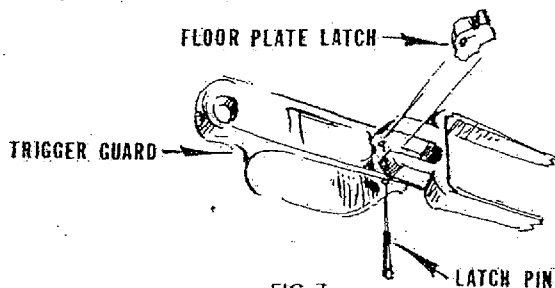

FIG. 7

Drive out floor plate latch pin — left to right and remove floor plate latch from trigger guard. (See Fig. 7).

To Reassemble — Follow reverse order. Floor plate should swing freely and latch properly.

MAGAZINE — MAGAZINE FOLLOWER — MAGAZINE SPRING

To Disassemble — Remove bolt final assembly. Remove trigger guard or (in BDL grade) trigger guard assembly. Remove stock assembly. Remove magazine follower and spring. Unscrew magazine tab screw (ADL grade only) and remove magazine. BDL grade magazines are disassembled by simply lifting from receiver.

To Reassemble — Follow reverse order.

TRIGGER HOUSING ASSEMBLY

NOTE: FACTORY SERVICE IS REQUIRED FOR ALL TRIGGER HOUSING ASSEMBLY RELATED PROBLEMS. RETURN THE FIREARM TO THE FACTORY FOR SERVICE.

STOCK ASSEMBLY

To Disassemble — Remove trigger guard or trigger guard assembly and remove stock assembly.

To Reassemble — Follow reverse order. Tighten screws securely.

STOCK ASSEMBLY — COMPONENTS (ADL Grade) includes butt plate, butt plate screw (4), front guard screw bushing, stock, stock reinforcing screw, stock reinforcing screw dowel.

To Disassemble — Unscrew and remove butt plate screws and butt plate. Front guard screw bushing may be removed for replacement, if necessary, by driving out with a tool from inside of stock. Tap against inner edge of bushing until it comes free from stock. Avoid damage to stock.

To Reassemble — Follow reverse order. Replacement butt plate may require edge sanding to match stock outline.

STOCK ASSEMBLY — COMPONENTS (BDL Grade) includes ADL grade components plus butt plate spacer, fore-end tip, fore-end tip spacer, grip cap, grip cap spacer, front swivel nut.

To Disassemble— See disassembly of ADL grade. Front swivel nut may be disassembled for replacement by carefully driving out from inside of stock.

To Reassemble— Follow reverse order.

BARREL ASSEMBLY — Includes barrel, barrel brackets, receiver. Selective factory assembly is required for replacement of parts and to insure proper operation with bolt final assembly. Disassembly is not recommended. Replace as a unit.

SLING STRAP ASSEMBLY AND MOUNTINGS, COMPLETE: Includes front swivel nut, front swivel screw, rear swivel screw, sling strap assembly, swivel assembly, Q.D. (2).

Note: Sling Strap Assembly includes sling strap, fastener, keeper and buckle. Strap is 7/8" wide. Swivel assemblies are (Q.D.) type.

A sling strap complete with mountings is packaged with each BDL Grade rifle. When attaching to rifle — assemble both quick detachable (Q.D.) swivel assemblies to stock. To do this, push plunger on swivel until small plate lifts and can be swung free of attaching stud on swivel. Then insert attaching stud into eye of stock screw. Close plate on swivel to lock swivel to stock screw.

To attach strap to swivels — insert tongue of strap into rear swivel. Loop strap back and through attached keeper band. Insert strap into and through buckle and front swivel. Loop back and secure with brass fastener. Adjust trap to desired position.

To remove strap from rifle, simply snap quick detachable swivels from stock screws and remove strap.

CYCLE OF OPERATION

The operation cycle of the Model 700 follows the basic pattern of bolt action rifles. After firing, raising of bolt handle will unlock action. Pulling bolt rearward will open action and extract and eject any fired case or round that may be in chamber. Pushing bolt handle forward and down closes and locks action — completing the cycle. Each operation is described in sequence below:

FIRING

With action closed and locked and safety switch in forward or FIRE position, rifle can be fired by pulling trigger. Pulling or squeezing trigger moves trigger connector forward, leaving sear unsupported against cocked firing pin head. With support removed, sear is cammed down by pressure of spring-loaded firing pin and firing pin is driven forward to strike primer.

UNLOCKING

Raising of bolt handle unseats locking lugs on bolt head from recoil shoulders in receiver.

COCKING

Cocking takes place as bolt handle is raised. A cam at rear of rotating bolt forces firing pin assembly rearward, compressing main spring, and holding assembly in cocked position in a notch at rear of bolt. This engagement holds until bolt handle is lowered again during locking cycle. Engagement is then transferred to sear to cock rifle.

EXTRACTION

This phase of operation cycle consists of two parts referred to as (1) primary extraction, and (2) secondary extraction. Primary extraction occurs simultaneously with unlocking. The rim of case, being completely encased by bolt head, is gripped

by a circular recessed claw-type extractor. During final upward throw of bolt handle, a primary extraction cam retracts bolt approximately 1/8" with a mechanical advantage of about 8 to 1, completing primary portion of this phase. Bolt lugs are now free of locking shoulders in receiver and bolt may now be moved to rear — completing second phase of extraction.

EJECTION

Within the bolt face, maintaining constant pressure on head of cartridge, is a spring-loaded ejector. As bolt is retracted and front edge of cartridge reaches ejection port, pressure along with opposing grip of extractor, ejects cartridge from port. Rearward motion of bolt is arrested by bolt stop.

FEEDING

With bolt stopped in rearward position, topmost cartridge in magazine will be urged upwards by magazine spring. It is held in position until carried forward by bolt into loading cycle.

LOADING

In closing the action, bolt pushes cartridge from magazine into barrel chamber. Feeding lips on top of magazine guide cartridge until bullet enters chamber.

LOCKING

Rotating bolt handle downward locks cartridge in barrel chamber. Four engagements are made in this cycle: (1) Locking lugs on bolt head are engaged with recoil shoulders in receiver. (2) Head of cartridge is seated into bolt head, depressing ejector while extractor claw is snapped over rim of cartridge. (3) Sear engages and locks firing pin in a cocked position by action of (4) Sear being supported from beneath by connector. Rifle is now ready for firing by release of trigger.

SAFETY SWITCH

The safety switch, located at right rear of receiver is operated by a push and pull action on the safety switch button. This two-position safety switch has two internal functions. When safety switch is rotated rearward, a cam is brought into position beneath sear safety cam. This locks cam against firing pin and prevents rifle from firing. Second function of safety switch in SAFE position ("S" marking) brings an arm into slot in bolt preventing bolt from being opened. Pushing safety switch forward to FIRE position ("F" marking) nullifies above conditions and rifle may be fired.

MALFUNCTIONS

Cause and Correction

Over-Ride

- Cause:**
1. Magazine Follower binds.
 2. Damaged Follower Spring.
 3. Magazine Spring caught under Guard.
 4. Tabs on Follower bent.

- Correction:**
1. Adjust side angle on Magazine Box.
 2. Change Spring.
 3. Correct.
 4. Straighten or replace Follower.

Stems Chamber

- Cause:
1. Sharp or rough Receiver Rails.
 2. Sharp edge - rear end of Chamber.
 3. Rough Ramp in Receiver.
 4. Magazine Box loose in Receiver.

- Correction:
1. Polish or file.
 2. Remove sharpness.
 3. Polish Ramp.
 4. Adjust.

Bolt Closes Hard Over Shells

- Cause:
1. Bolt interferes with shell rim.
 2. Extractor interferes with shell rim.
 3. Ejector binds or fails to retract far enough.
 4. Burr at Ejector Hole on Bolt.
 5. Sharp corners on Bolt Lugs.
 6. Extractor Rivet loose.

- Correction:
1. Remove interference or change Bolt.
 2. Fit new Extractor (grind relief in new Extractor behind Claw).
 3. Free up or replace.
 4. Deburr.
 5. File radius.
 6. Tighten or replace Rivet.

Fails to Extract

- Cause:
1. Tight, rough or oversize Chamber.
 2. Extractor broken or damaged.
 3. Not enough Hook space on Extractor.
 4. Height of Claw not correct.
 5. Extractor stuck back.

- Correction:
1. Ream if tight or rough.
Change Barrel Assembly if oversize.
 2. Fit new Extractor.
 3. Fit new Extractor.
 4. Fit new Extractor.
 5. Replace Extractor.

Fails To Eject

- Cause:
1. Burr at Ejector Hole in Bolt.
 2. Ejector binds or fails to retract far enough.
 3. Extractor Rivet loose.
 4. Extractor drops shell.

- Correction:
1. Deburr.
 2. Free up or replace.
 3. Re-stake or replace.
 4. Replace Extractor.

Misfires

- Cause:
1. Short Firing Pin (damaged).
 2. Firing Pin binds.
 3. Short Firing Pin protrusion.
 4. Firing Control out of adjustment.
 5. Faulty ammunition.

- Correction:
1. Replace.
 2. Free up or replace.
 3. Change Firing Pin or Bolt.
 4. Return the firearm to the factory.
 5. Replace ammunition.

Follows Down

- Cause:
1. Trigger out of adjustment.
 2. Improper vertical engagement of Sear and Connector.
 3. Trigger doesn't retract.
 4. Corners on Sear or Connector rounded.
 5. Trigger binds on Trigger Guard.
 6. Not enough tension on Weight Screw (light pull).

- Correction:
1. Return the firearm to the factory.
 2. Return the firearm to the factory.
 3. Return the firearm to the factory.
 4. Return the firearm to the factory.
 5. File Trigger Guard - eliminate interference.
 6. Return the firearm to the factory.

Bolt Opens Hard

- Cause:
1. See Fails to Extract.
 2. Upset Extraction Cam on Bolt Handle.
 3. Burr at Ejector Hole in Bolt.
 4. Blown or set back Primer on shell.

- Correction:
1. See Fails to Extract.
 2. Smooth up.
 3. Deburr.
 4. Ream Chamber if throat is shallow (ammunition may be at fault).

Bolt Pulls Out

- Cause:
1. Bolt Stop or Bolt Release binds.
 2. Bolt Stop or Bolt Release broken.

- Correction:
1. Return the firearm to the factory.
 2. Return the firearm to the factory.

Safety Switch Works Too Hard or Too Freely

- Cause:
1. Safety switch binds (works hard).
 2. Safety switch Snap Washer stretched out (Safety Switch works too freely.)

- Correction:
1. Return the firearm to the factory.
 2. Return the firearm to the factory.

Bulges or Blows Cases

- Cause:
1. Oversize Chamber.
 2. Maximum head-space.

- Correction:
1. Change Barrel or Barrel and Receiver Assembly.
 2. Fit new Bolt (ammunition may be at fault).

Bolt Binds

- Cause:
1. Guard Screws protrude into Bolt track.
 2. Scope Screws protrude into Bolt track.
 3. Bolt Handle interference on Stock.
 4. Step at rear of Bolt Lugs.

- Correction:
1. File ends of Screws.
 2. File ends of Screws.
 3. Correct Stock or fit new Stock.
 4. File to blend.

**MODEL
700**

**REMINGTON
FIELD SERVICE MANUAL**

PARTS LIST

View No.	Part No.	NAME OF PART	View No.	Part No.	NAME OF PART
NOTE: Basic 30-06 Caliber listed below. See Sectional View for proper identity of parts. See added page for other caliber part listings.					
1		Barrel Assembly	35	17029	Main Spring
2		Bolt Assembly	36	26355	Rear Guard Screw
		Bolt Final Assembly	37	32510	Rear Sight Aperture
3	17012	Bolt Plug	38	91595	Rear Sight Base
4	17013	Bolt Stop (Restricted)	39	28505	Rear Sight Base Screw (2)
5	24475	Bolt Stop Pin (Restricted)	40	90905	Rear Sight Slide
6	15478	Bolt Stop Release (Restricted)	41	90906	Elevation Screw
7	15224	Bolt Stop Spring (Restricted)	42	90904	Windage Screw
8	90953	Butt Plate	43	15358	Rear Swivel Screw, BDL Grade
8a	90954	Butt Plate Spacer, BDL	44	17034	Receiver Plug Screw
9	25380	Butt Plate Screw	45	26585	Safety Switch Assembly (Restricted)
10	15287	Center Guard Screw, ADL Grade	46	23222	Safety Switch Detent Ball (Restricted)
11	17017	Ejector	47	15368	Safety Switch Detent Spring (Restricted)
12	17676	Ejector Pin	48	17043	Safety Switch Pivot Pin (Restricted)
13	17019	Ejector Spring	49	17044	Safety Switch Snap Washer (Restricted)
14	91816	Extractor	50	15666	Sear Safety Cam (Restricted)
	15376	Fastener, Sling Strap	51	24476	Sear Pin (Restricted)
16	22020	Firing Pin	52	17047	Sear Spring (Restricted)
17	22040	Firing Pin Assembly	53	30855	Sling Strap Assembly, BDL Grade
18	17022	Firing Pin Cross Pin		26990	Sling Strap Assembly and Mountings Complete
20	15291	Floor Plate Latch, BDL Grade	54	33366	Stock Assembly, ADL Grade
21	16451	Floor Plate Latch Pin, BDL Grade		33371	Stock Assembly, BDL Grade
22	16452	Floor Plate Latch Spring, BDL Grade		18186	Stock Reinforcing Screw (not shown)
23	16453	Floor Plate Pivot Pin, BDL Grade		16970	Stock Reinforcing Screw Dowel (not shown)
24	22035	Front Guard Screw	55	26555	Swivel Assembly, BDL Grade (Q.D.)
25	15161	Front Guard Screw Bushing, ADL Grade	56	15280	Trigger (Restricted)
26	15373	Front Sight	57	17053	Trigger Adjusting Screw (Restricted)
	15719	Front Sight (Low)		26345	Trigger Assembly (Restricted)
27	28510	Front Sight Ramp	58	19461	Trigger Connector (Restricted)
	15635	Front Sight Ramp, BDL Grade	59	91128	Trigger Engagement Screw (Restricted)
28	28505	Front Sight Ramp Screw	60	15281	Trigger Guard
29	15363	Front Sight Hood, BDL Grade	61	26376	Trigger Guard, BDL Grade
30	15357	Front Swivel Nut, BDL Grade		26371	Trigger Guard Assembly, BDL Grade
31	15358	Front Swivel Screw, BDL Grade	62	26655	Trigger Housing Assembly (Restricted)
	90957	Grip Cap, BDL Grade (not shown)	63	24477	Trigger Pin (Restricted)
	25380	Grip Cap Screw	64	15400	Trigger Spring (Restricted)
	90958	Grip Cap Spacer, BDL Grade (not shown)	65	15481	Trigger Stop Screw (Restricted)
32	15284	Magazine, ADL Grade			
	16430	Magazine, BDL Grade (not shown)			
33	90952	Magazine Follower			
	91017	Magazine Follower, BDL Grade			
	15940	Magazine Tab Screw, ADL Grade			
34	17028	Magazine Spring			
	15677	Magazine Spring, BDL Grade			

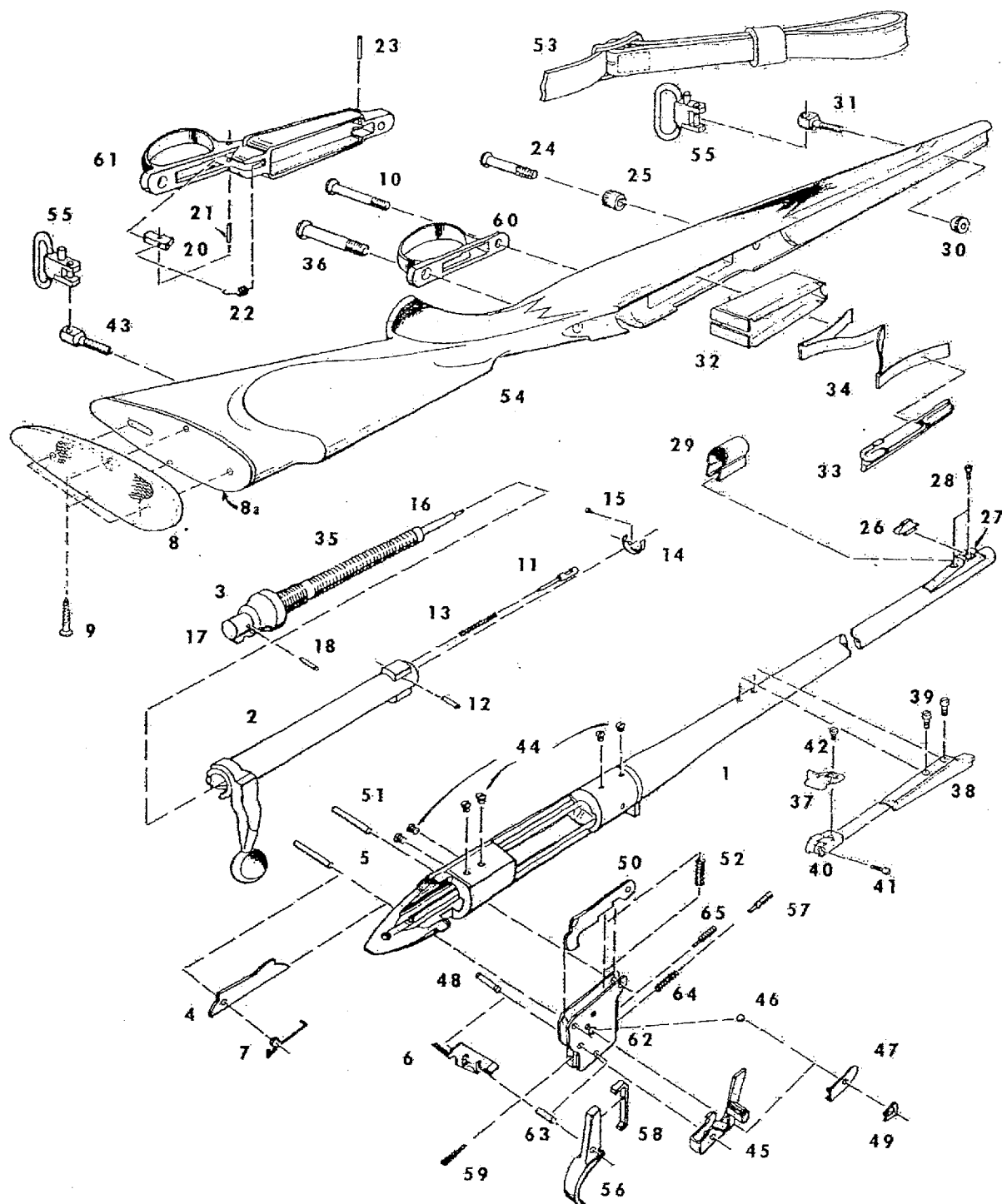

ADDITIONAL CALIBERS
(Not Shown in Sectional View)
INCLUDES VARMINT MODEL

REMINGTON
FIELD SERVICE MANUAL

MODEL
700

Note: Caliber part numbers not listed below same as 30-06
(222 Rem. Mag. discontinued)

Part No.	NAME OF PART	Part No.	NAME OF PART
91837	Extractor, 7mm Rem., Mag., 264-300 Win. Mag.	33370	Stock Assembly, 222 Rem., 243 Win., 308 Win., 6mm Rem., 22-250 Rem., BDL Grade, 17 Rem.
91906	Extractor, 222-223 Rem., 17 Rem.	33376	Stock Assembly, Varmint, BDL Grade, 222 Rem., 223 Rem., 243 Win., 6mm Rem., 22-250 Rem.
22021	Firing Pin, 222 Rem., 234-308 Win., 6mm Rem. Mag., 22-250 Rem., 223 Rem., 17 Rem.	33375	Stock Assembly, Varmint, BDL Grade, 25-06
22041	Firing Pin Assembly, 222 Rem., 17 Rem., 243 Win., 308 Win., 6mm Rem., 22-250 Rem., 223 Rem.	26375	Trigger Guard, BDL Grade, 222 Rem., 223 Rem., 243 & 308 Win., 6mm Rem., 22-250 Rem., 17 Rem.
16434	Floor Plate, BDL Grade, 222 Rem., 223 Rem., 243 & 308 Win., 6mm Rem., 22-250 Rem., 17 Rem.	26370	Trigger Guard Assembly, BDL Grade, 222 Rem., 17 Rem., 223 Rem., 243 Win., 6mm Rem., 22-250 Rem.
22037	Front Guard Screw, 222 Rem., 223 Rem., 243 & 308 Win., 6mm Rem., 22-250 Rem., 17 Rem.	CALIBERS: 375 H & H MAGNUM, 458 WIN. MAGNUM	
16204	Front Scope Base, Varmint	27265	Barrel Assembly, 375 H & H Mag.
14659	Front Sight, 7mm Rem. Mag., 264 Win. Mag.	27266	Barrel Assembly, 458 Win. Mag.
28511	Front Sight Ramp, ADL Grade	15709	Extractor
15992	Front Sight Ramp, BDL Grade	16771	Front Sight, 375 H & H Mag.
15282	Magazine, ADL Grade, 222 Rem.	23805	Front Sight, 458 Win. Mag.
16716	Magazine, BDL Grade, 222 Rem., 223 Rem., 17 Rem.	27270	Stock Assembly, 375 H & H Mag., 458 Win. Mag. (includes same as standard Magnum except Stock Bolt (2) Nut (2), Cover (4) used)
15283	Magazine, ADL Grade, 243 & 308 Win., 6mm Rem., 22-250 Rem.	DISCONTINUED or SERVICE PARTS	
16715	Magazine, BDL Grade, 243 & 308 Win., 6mm Rem., 22-250 Rem.	26270	Barrel Assembly, 280 Rem.
14756	Magazine, BDL Grade	20467	Extractor, 222 Cal.
90951	Magazine Follower, 222 Rem., 223 & 17 Rem.	17639	Ejector, 222 Cal.
90982	Magazine Follower, 243 & 308 Win., 6mm Rem., 22-250 Rem.	16717	Front Sight Ramp, 6mm Rem., 7mm Rem. Mag., 264 Win. Mag., 222 Rem., 222 Rem. Mag., 243 Win., ADL Grade
15742	Magazine Spacer, 222 Rem.	15361	Front Sight Ramp, 7mm Rem. Mag., 264 Win. Mag., 222 Rem., 222 Rem. Mag., 243 Win., BDL Grade
15286	Magazine Spacer, 222 Rem., BDL Grade	24666	Front Sight Ramp, 30-06, 280 Rem., 308 Win., 270 Win., ADL Grade
15286	Magazine Spacer, 223 Rem., BDL Grade, 17 Rem.	24477	Front Sight Ramp Pin, 6mm Rem., 7mm Rem. Mag., 264 Win. Mag., 222 Rem., 222 Rem. Mag., 243 Win.
91133	Magazine Spring, 222 Rem., 223 Rem., 17 Rem.	19025	Front Sight Ramp Screw, 7mm Rem. Mag., 6mm Rem., 264 Win. Mag., 222 Rem., 222 Rem. Mag., 243 Win.
17891	Magazine Spring, 243 & 308 Win., 6mm Rem. ADL Grade	28200	Rear Sight Assembly, Complete (includes Rear Sight Assembly, Rear Sight Base, Rear Sight Base Screw (2), Rear Sight Screw, Rear Sight Step, Rear Sight Washer (2))
15698	Magazine Spring, 22-250 Rem.	15709	Extractor, 7mm Rem. Mag., 264-300 Win. Mag.
15699	Magazine Spring, 22-250 Rem., 6mm Rem., 243 Win., BDL Grade	15850	Extractor, 222-223 Rem., 17 Rem.
17058	Main Spring, 222 Rem., 223 Rem., 243 Win., 308 Win., 17 Rem.	27341	Extractor Rivet, 7mm Rem. Mag., 264-300 Win. Mag.
18842	Rear Scope Base, Varmint	27342	Extractor Rivet, 222-223 Rem., 17 Rem.
90949	Recoil Pad, 7mm Rem. Mag., 264 & 300 Win. Mag.		
25410	Recoil Pad Screw, 7mm Rem. Mag., 264 & 300 Win. Mag.		
18842	Scope Base Screw, Rear Varmint		
16204	Scope Base Screw, Front Varmint		
33380	Stock Assembly, 7mm Rem. Mag., ADL Grade		
33365	Stock Assembly, 222 Rem., 243 Win., 308 Win., 6mm Rem., 22-250 Rem., ADL Grade		
33385	Stock Assembly, 7mm Rem. Mag., 264 & 300 Win. Mag., BDL Grade		

Deliveries c/o F.O.B. Ilion, New York

Parts Subject to Change Without Notice

R 2201648

MALFUNCTIONS

CAUSE and CORRECTION

(Con't. from Page 4)

Doesn't Group

- Cause:
1. Crown of Barrel damaged.
 2. Leading of Bore.
 3. Oversize Bore.
 4. Improper bedding of Barrel in Stock.
 5. Loose Sights.

- Correction:
1. Recrown.
 2. Lead or change Barrel.
 3. Change Barrel.
 4. Correct bedding.
 5. Tighten or replace.

Point of Impact Not Correct

- Cause:
1. Barrel not straight.
 2. Horns, breaks, etc. in Bore.
 3. Improper or loose Sights.

- Correction:
1. Straighten.
 2. Correct if possible.
 3. Tighten or change Sights.

MODEL

700

LEFT HAND MODEL

REMINGTON
FIELD SERVICE MANUAL

PARTS LIST

View No.	Part No.	NAME OF PART	View No.	Part No.	NAME OF PART
NOTE: Basic 30-06 caliber listed below. For other caliber parts and numbers, see additional calibers list.			46	17043	Safety Switch, Pivot Pin. (Restricted)
1		Barrel Assembly	47	17044	Safety Switch, Snap Washer (Restricted)
2		Bolt Assembly	48	15866	Sear Safety Cam (Restricted)
		Bolt Final Assembly	49	24476	Sear Pin (Restricted)
3	17012	Bolt Plug	50	17047	Sear Spring (Restricted)
4	17013	Bolt Stop (Restricted)	51	30855	Sling Strap Assembly
5	24475	Bolt Stop Pin (Restricted)		26990	Sling Strap Assembly and Mountings Complete
6	90555	Bolt Stop Release (Restricted)	52	33391	Stock Assembly
7	90554	Bolt Stop Spring (Restricted)		18186	Stock Reinforcing Screw
8	90953	Butt Plate		16970	Stock Reinforcing Screw Dowel
8a	90954	Butt Plate Spacer	53	26555	Swivel Assembly (Q.D.)
9	25380	Butt Plate Screw	54	15280	Trigger (Restricted)
10	17017	Ejector	55	17053	Trigger Adjusting Screw (Restricted)
11	17676	Ejector Pin		32895	Trigger Assembly (Restricted)
12	17019	Ejector Spring	56	19461	Trigger Connector (Restricted)
13	91816	Extractor	57	91128	Trigger Engagement Screw (Restricted)
14	27340	Extractor Rivet	58	26376	Trigger Guard
	15376	Fastener, Sling Strap		26371	Trigger Guard Assembly
15	22020	Firing Pin	59	32905	Trigger Housing Assembly (Restricted)
16	22040	Firing Pin Assembly	60	24477	Trigger Pin (Restricted)
17	17022	Firing Pin Cross Pin	61	15400	Trigger Spring (Restricted)
18	15291	Floor Plate Latch	62	15481	Trigger Stop Screw (Restricted)
20	16451	Floor Plate Latch Pin	ADDITIONAL CALIBERS		
21	16452	Floor Plate Latch Spring			
22	16453	Floor Plate Pivot Pin	NOTE: Parts not listed; same as 30-06 Caliber.		
23	22035	Front Guard Screw			
24	15373	Front Sight			Barrel Assembly, 7mm Rem. Mag.
	15719	Front Sight (Low)			Barrel Assembly, 270 Win.
25	15635	Front Sight Ramp			Bolt Assembly, 7mm Rem. Mag.
26	28505	Front Sight Ramp Screw	91837		Extractor, 7mm Rem. Mag.
27	15363	Front Sight Hood	27341		Extractor Rivet, 7mm Rem. Mag.
28	15357	Front Swivel Nut	14659		Front Sight, 7mm Rem. Mag.
29	15358	Front Swivel Screw	90949		Recoil Pad, 7mm Rem. Mag.
	90957	Grip Cap	25410		Recoil Pad Screw, 7mm Rem. Mag.
	90958	Grip Cap Spacer	33395		Stock Assembly, 7mm Rem. Mag.
	25380	Grip Cap Spacer Screw			
30	16430	Magazine			
31	91017	Magazine Follower			
32	15677	Magazine Spring			
33	17029	Main Spring			
34	26355	Rear Guard Screw			
35	32510	Rear Sight Aperture			
36	91595	Rear Sight Base			
37	28505	Rear Sight Screw			
38	90905	Rear Sight Slide			
39	90906	Elevation Screw			
40	90904	Windage Screw			
41	15358	Rear Swivel Screw			
42	17034	Receiver Plug Screw			
43	32900	Safety Switch Assembly (Restricted)			
44	23222	Safety Switch Detent Ball (Restricted)			
45	90557	Safety Switch Detent Spring (Restricted)			

EXPLODED
VIEW

REMINGTON FIELD SERVICE MANUAL

MODEL
700
LEFT HAND MODEL

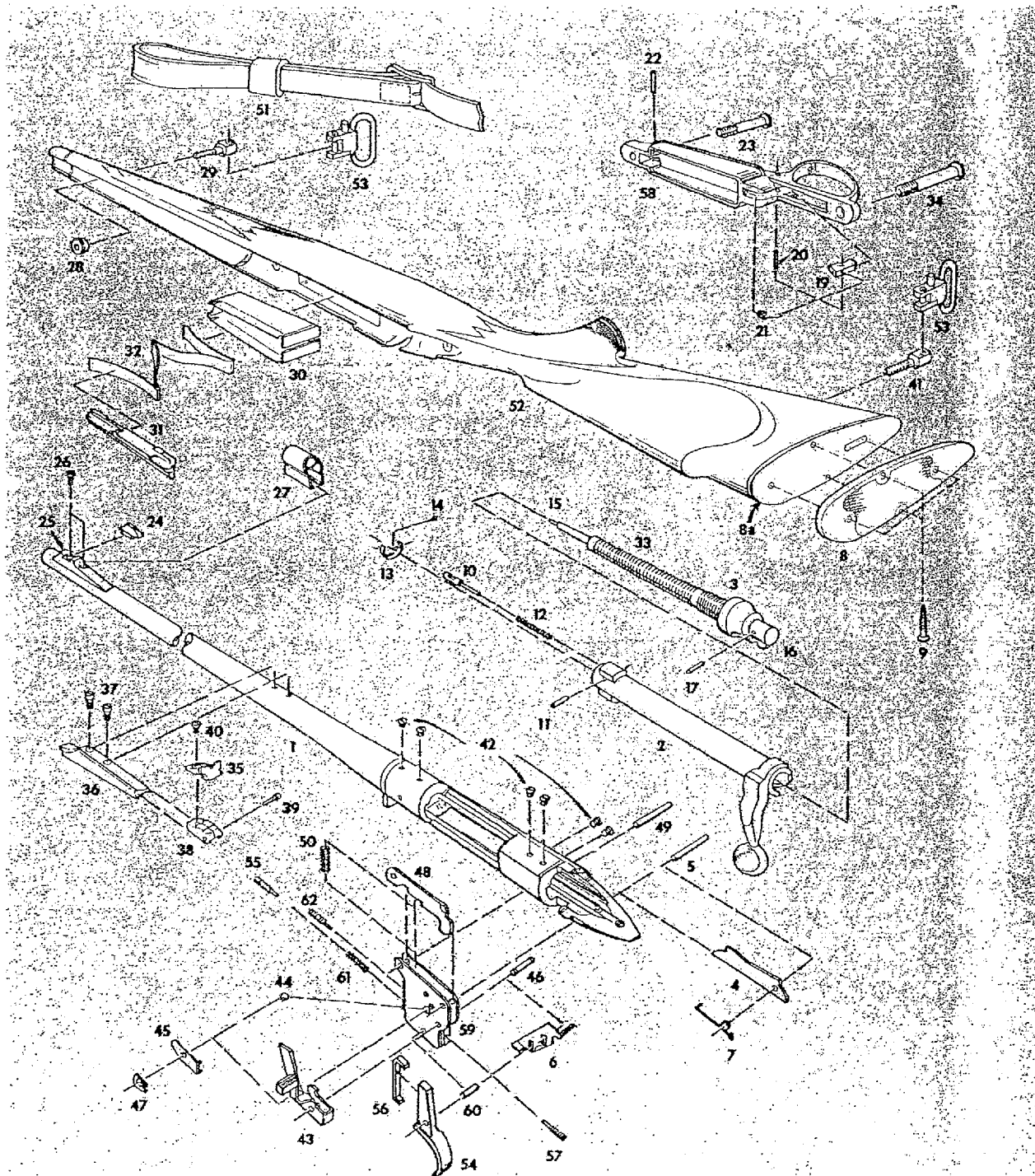

EXPLODED VIEW

Remington.

MODEL
700

BOLT ACTION CENTERFIRE RIFLE

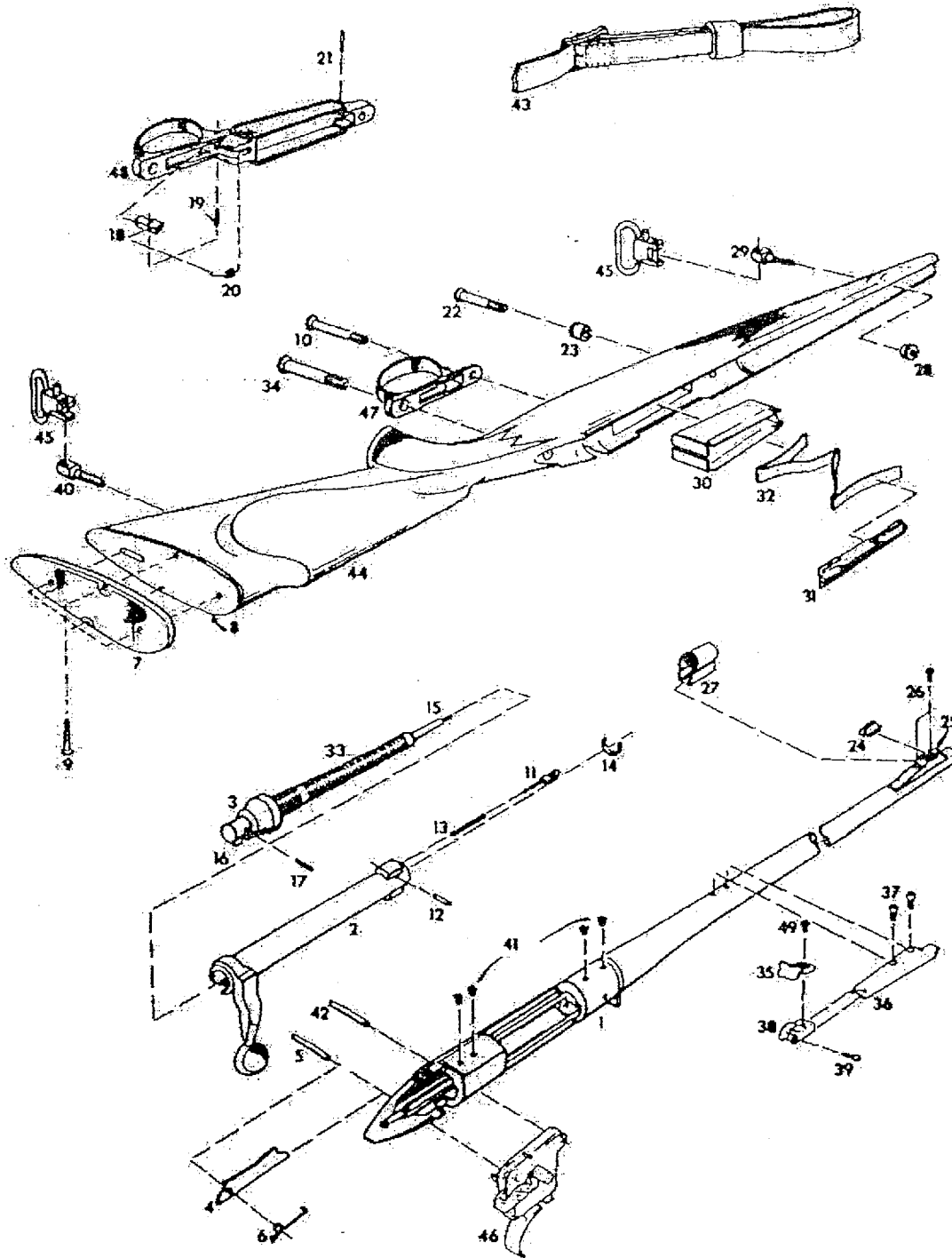



M700 Inspection Checklist



** Warning **

- * Use Only "Dummy" Shells for Function Testing
- * Never Have Live Ammunition in the Area Where Inspection or Repair Work is Being Performed
- * Always Wear Safety Glasses While Performing Any Inspections or Repairs

1 - Initial Inspections	PASS	FAIL
Clear Weapon		
Overall Appearance		
Function Check w/ Dummy Rounds		
2 - Bolt Assembly (Remove F.P. and Ejector Assemblies)		
Check Headspace		
Closes on MIN (go) Gauge		
Does Not Close Fully on MAX (no go) Gauge		
Firing Pin Assembly		
Current Style, Fluted Shaft, No ISS Lock		
Tip Not Bent or Broken		
Bolt Shroud Not Damaged		
Cocking Surface Smooth, Undamaged		
Ejector		
Ejector Not Bent or Broken, 'C' Cut Not Damaged		
Spring Not Damaged, Corroded		
Ejector Recess Free of Corrosion, Debris		
Bolt Body		
Breechface Clean, Undamaged		
Extractor Travels, Rebounds Freely		
Bolt Handle Secured and Undamaged		
Cocking Surface Smooth, Undamaged		
Reassemble Bolt		
3 - Stock Assembly (Remove from Action)		
Overall Condition		
Cracks, Finish Damage		
Recoil Present, Secure and Undamaged		
Sling/Accessory Mounts Present and Secure		
Bedding		
Secured to Stock		
No Cracks, Chips Etc.		
No Damage / Obstructions in Recoil Lug Recess		
Action Screw Holes Unobstructed / Marred by Screw Threads		
4 - Trigger Guard / Floorplate		
Internal Box, Drop Floorplate Magazine		
Trigger Guard Not Damaged		
Floorplate Latch - Travel, Tension, Secure Hold		
Floorplate Swings Freely		
Magazine Follower Not Damaged		
Magazine Spring Not Damaged or Bent		
Detachable Box Magazine		
Trigger Guard Not Damaged		
Magazine Box Body Not Damaged, Dented, Corroded		
Magazine Locking Surface Not Damaged		
Feed Lips Not Damaged, Bent		
Magazine Follower Not Damaged		
Magazine Spring Not Damaged or Bent		

5 - Barreled Action	PASS	FAIL
Barrel		
Bore Free of Obstructions		
Muzzle Not Damaged		
Chamber - Corrosion, Debris (Inspect w/ Reflector)		
Receiver		
Overall Condition		
Optics Mount Secure		
Feed Lips / Ramp Undamaged		
Locking Lug Recess Free of Corrosion, Debris		
Trigger		
Overall Condition		
Sealant Present On All Internal Adjustment Points		
Trigger - Travel, Rebound		
Sear - Travel Rebound		
Safety - Travel, Positive Detent		
Install Bolt - Closed, Cocked, Safety ON		
Sear Lift - MIN .008" Clearance		
All Trigger Types		
Trigger Block - MAX .008" Clearance		
X-Mark Pro, X-Mark Pro Adjustable ONLY		
6 - Final Inspections		
Reinstall Stock - Torque Spec Chart Below		
Barrel Free Floats		
Trigger Pull Weight		
Function Test w/ Dummy Rounds		
7 - Accessories		
N/A	PASS	FAIL
Optics		
Optics Accessories		
Light		
Bipod		
Sling		
Other -		
Other -		

Action Screw Torque Specs				
Bedding - Block or Pillars	X	X		
Aluminum Trigger Guard		X		X
Steel Trigger Guard	X		X	
** Torque Specs Given in Inch Pounds**	65	45	35	35



M700 Armorer's Inspection Report



Pre-Inspection Report

Serial Number		Inspection Number mm/dd/yy - #	
Issued Officer		Name of Inspector	
Problem(s) Reported		Round Count	

Summary of Previous Inspection
Issues Found / Actions Taken

--

Post-Inspection Report

Summary of Corrective Actions
Taken, Parts Serviced/Replaced

--

Areas Requiring Additional
Attention @ Next Inspection

--

Armorer's Comments

--

Certificate Number

Signature

Date

--	--	--

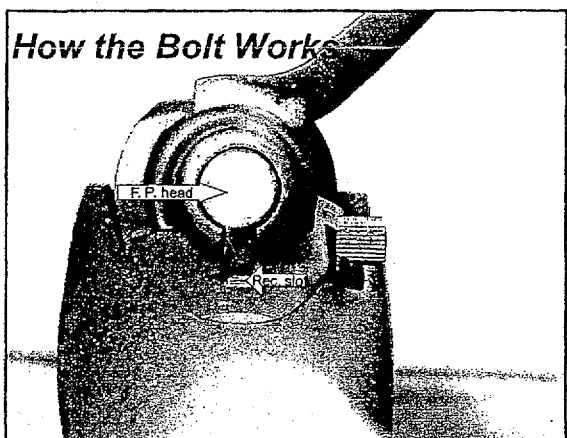
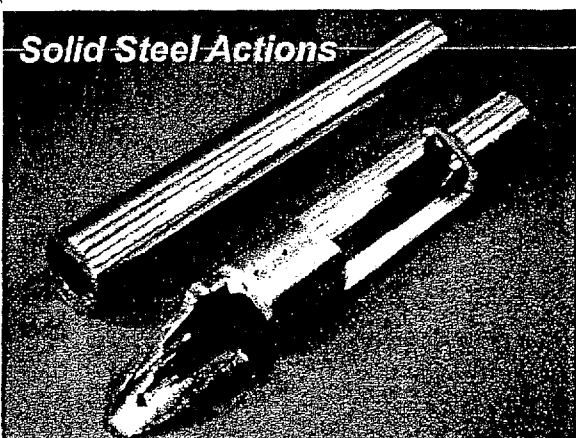
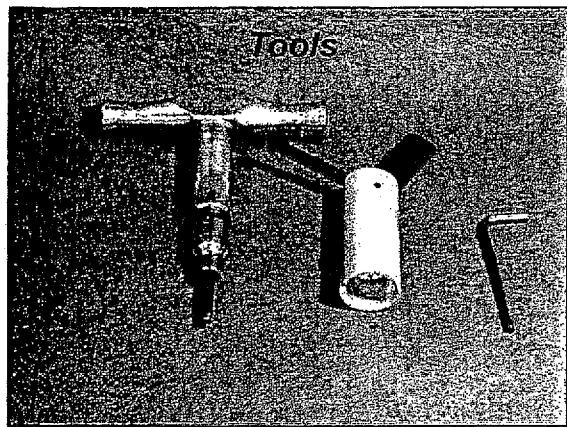
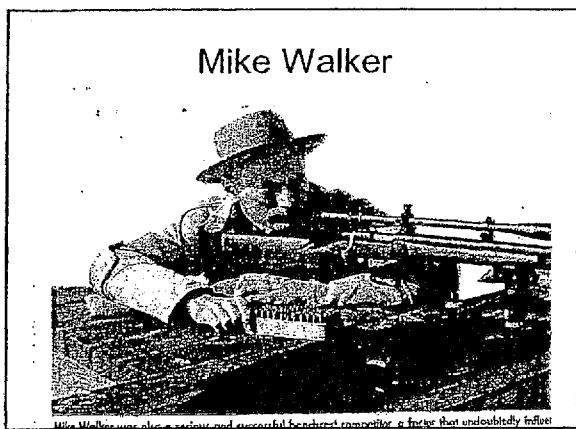
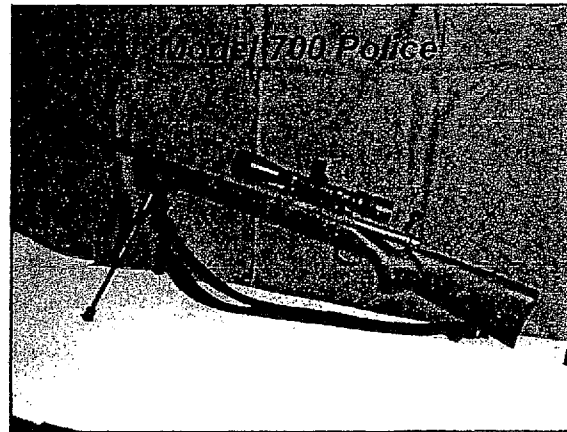
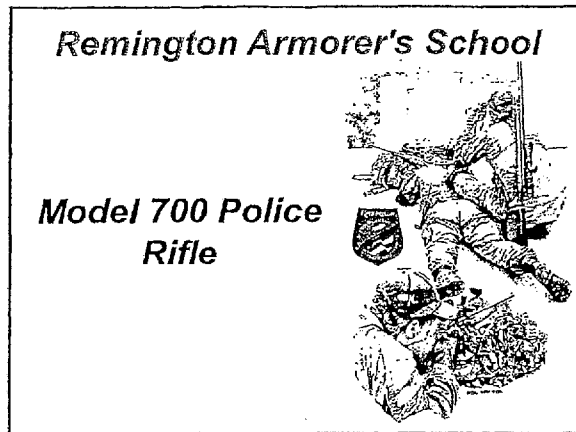

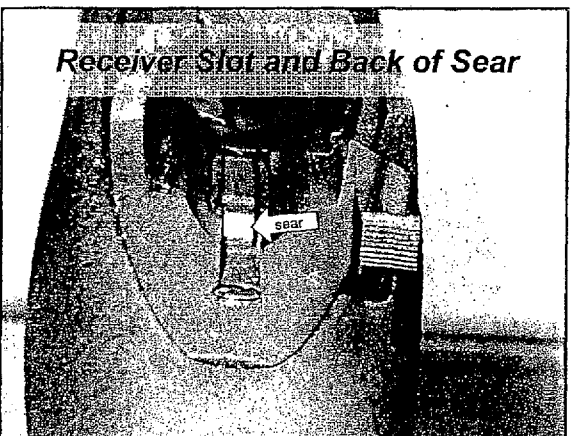
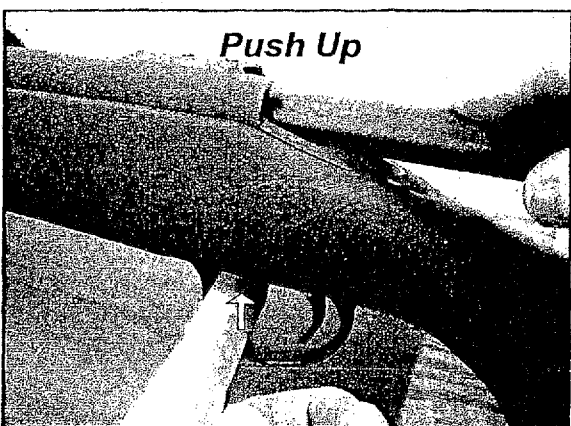
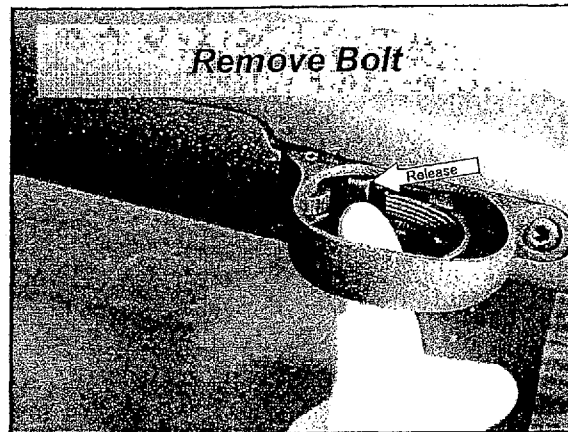
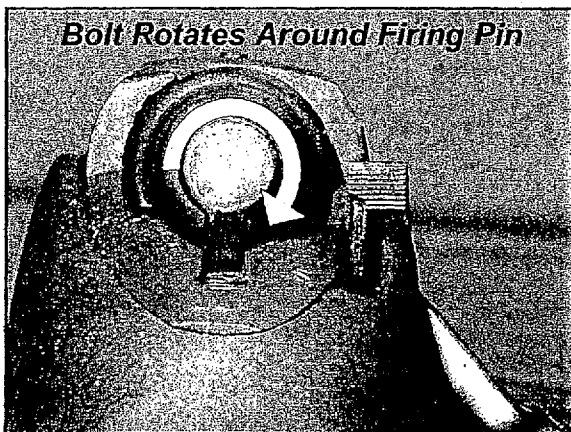

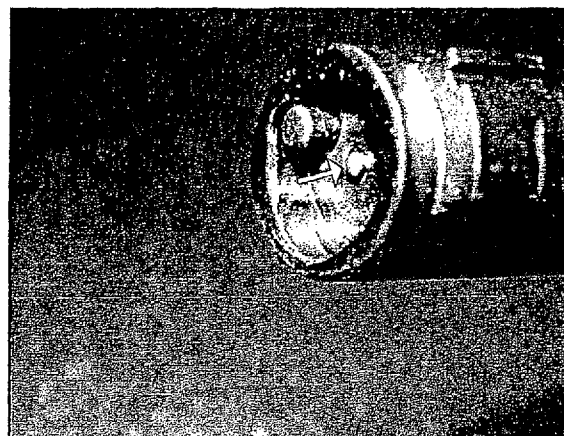
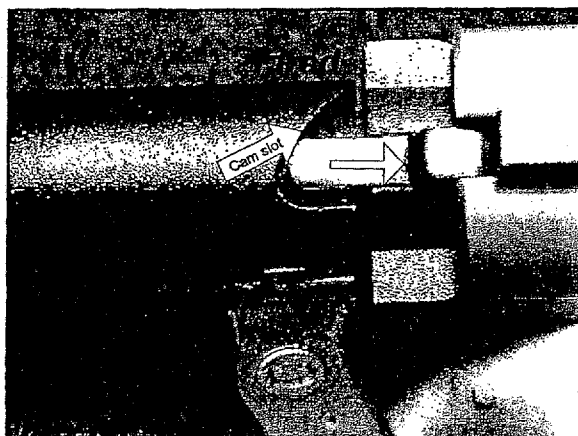
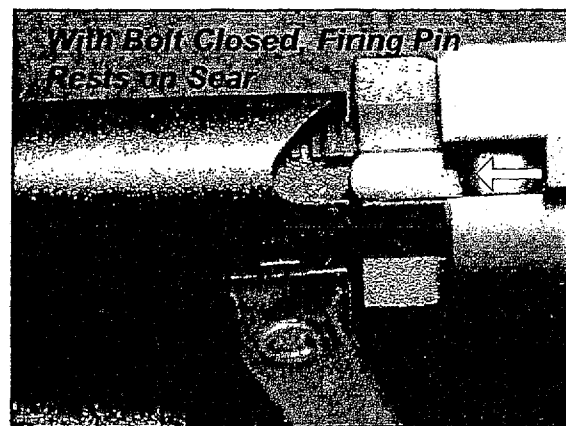
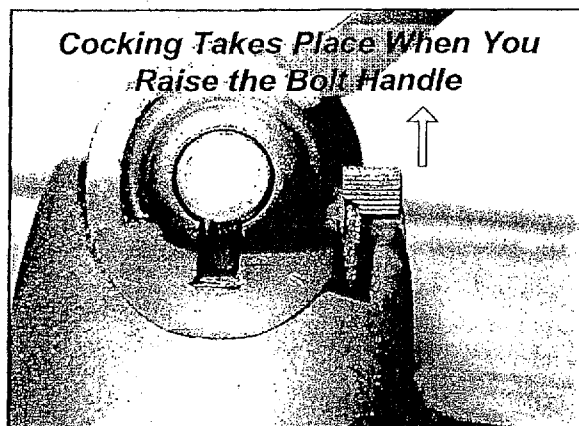
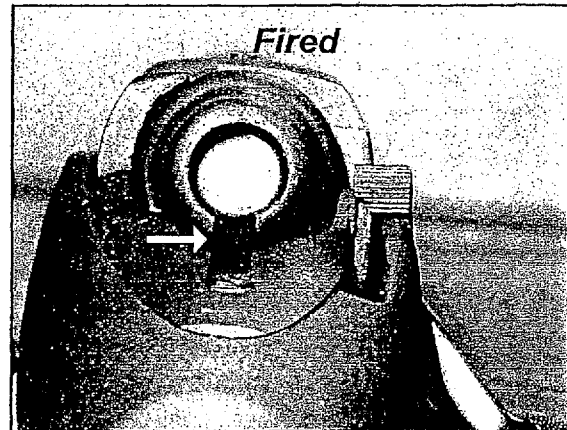
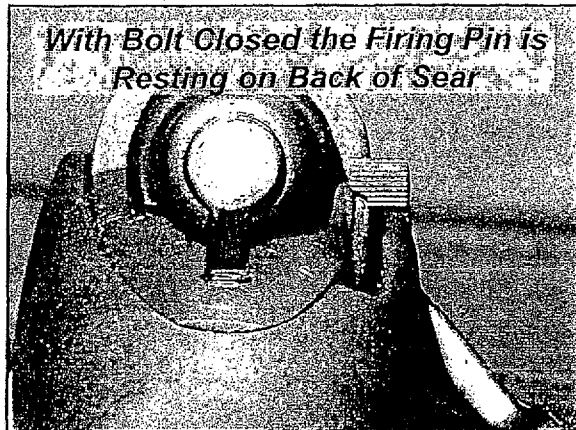

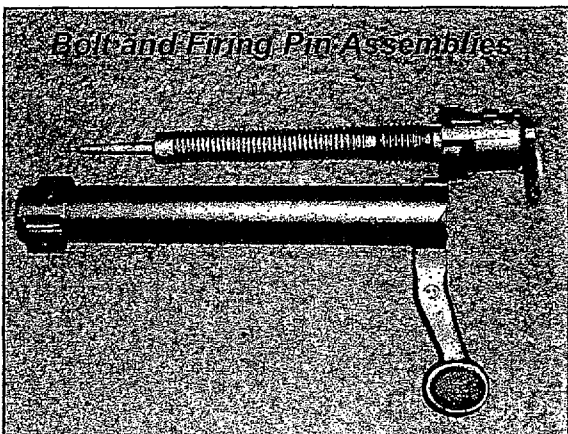
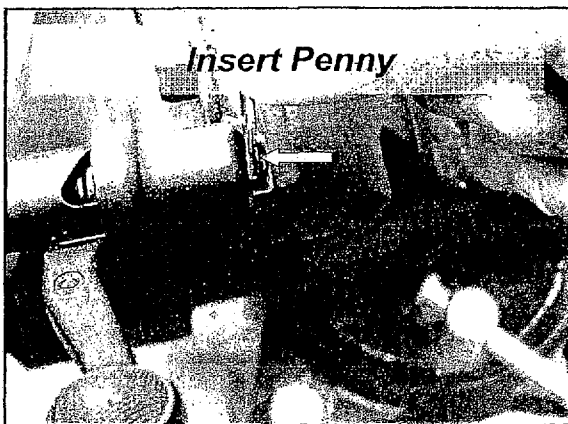
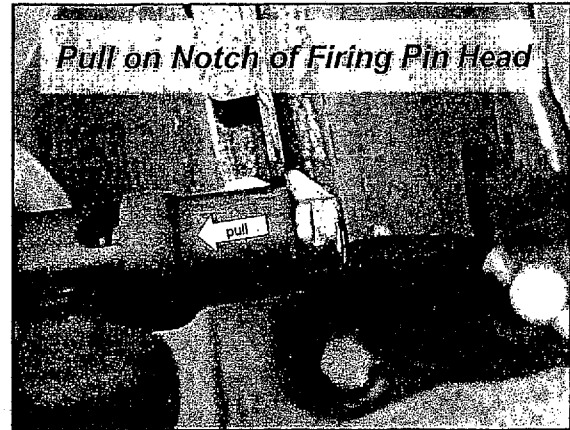
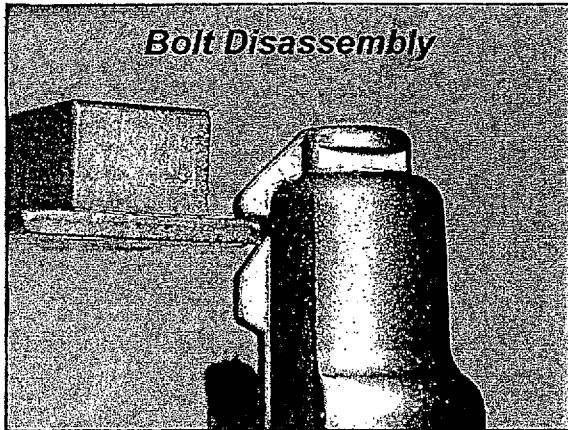

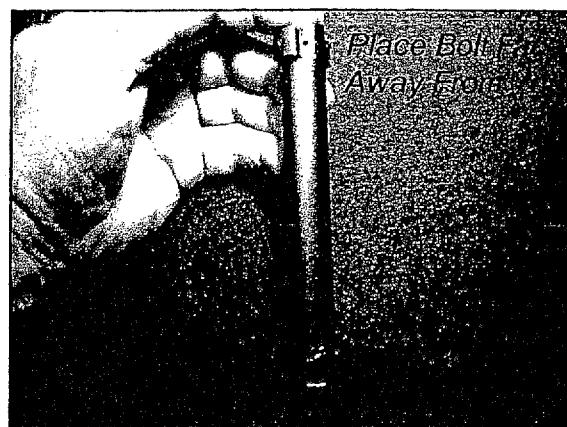
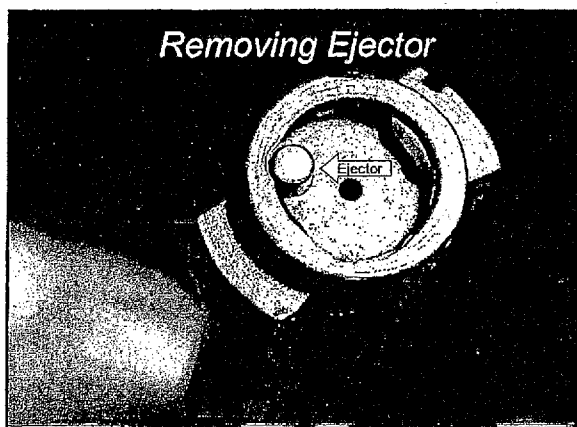
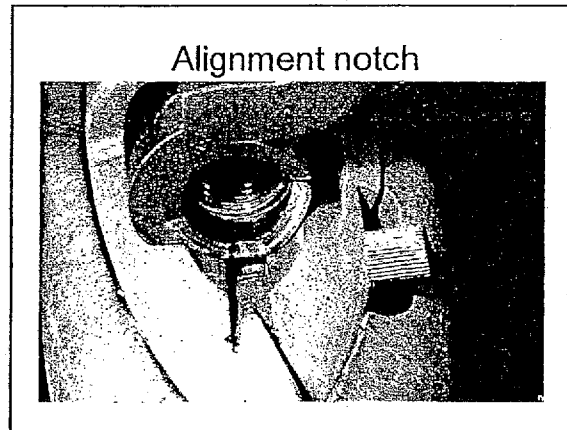

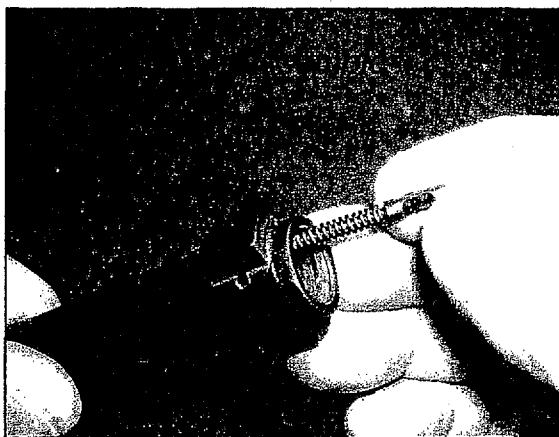
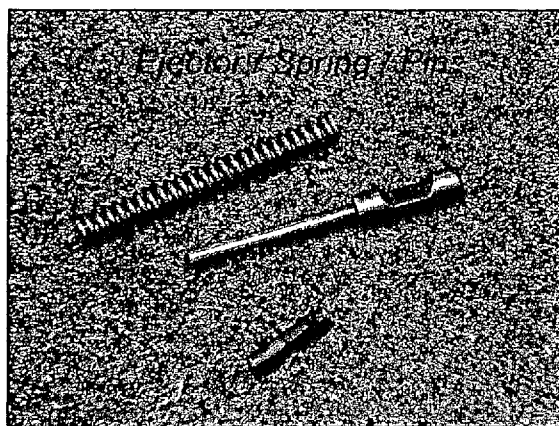
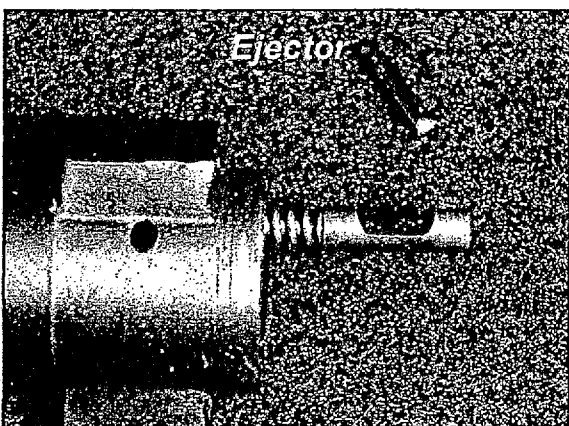
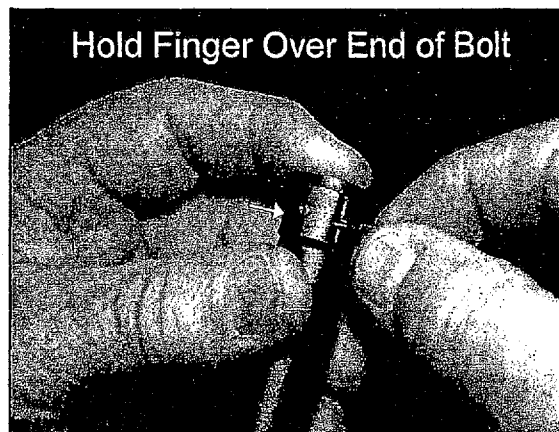
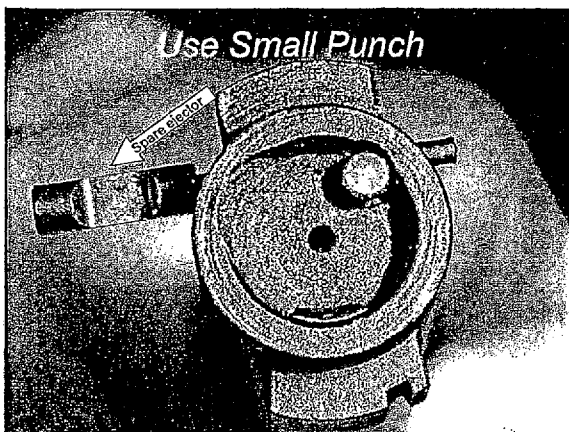

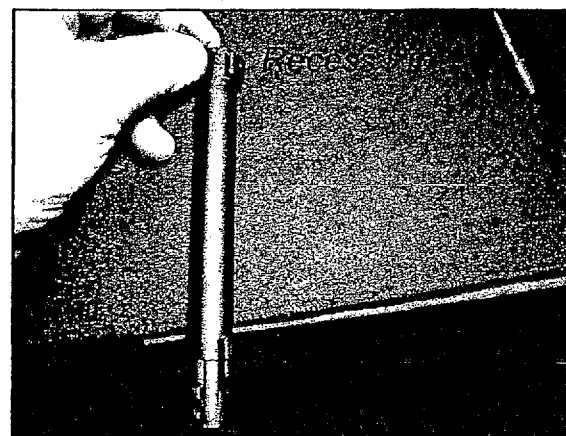
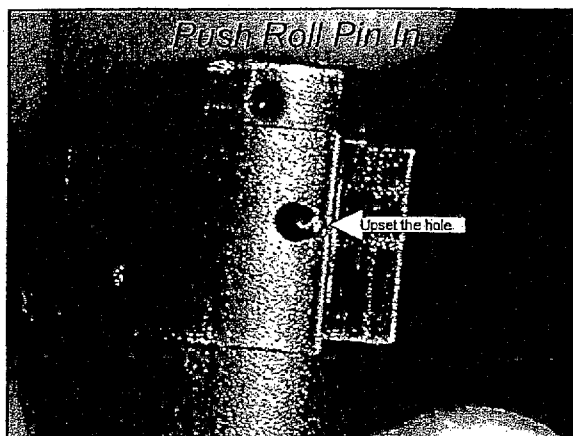
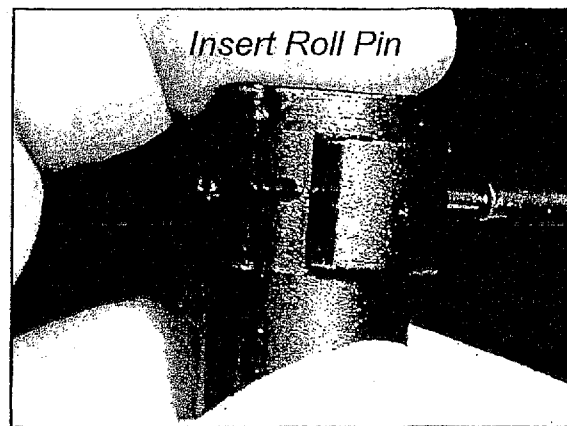
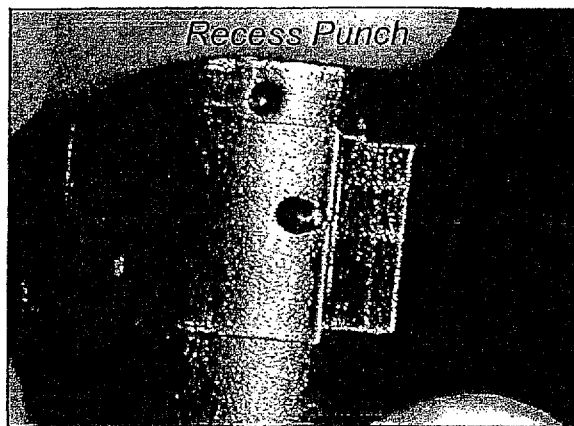
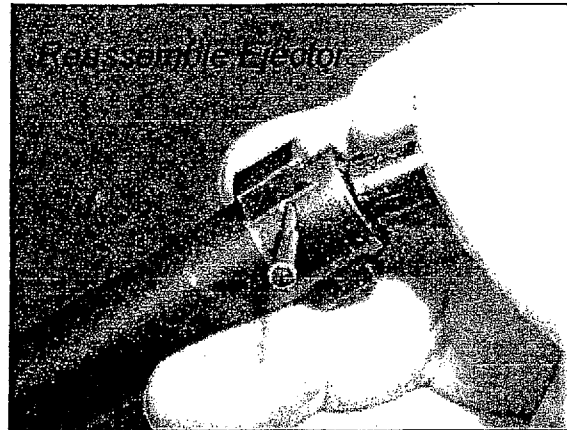
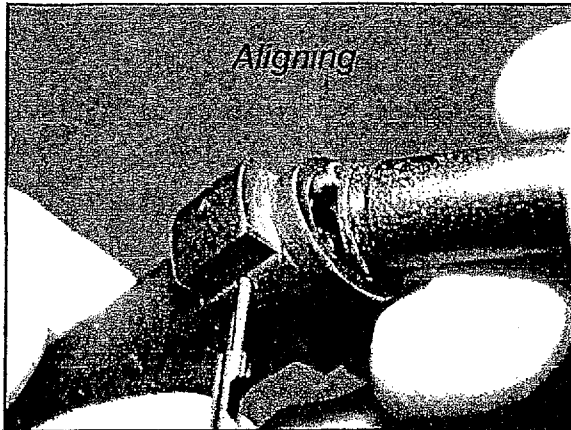

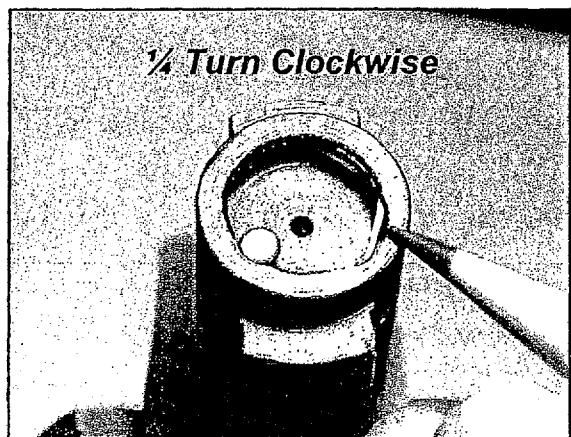
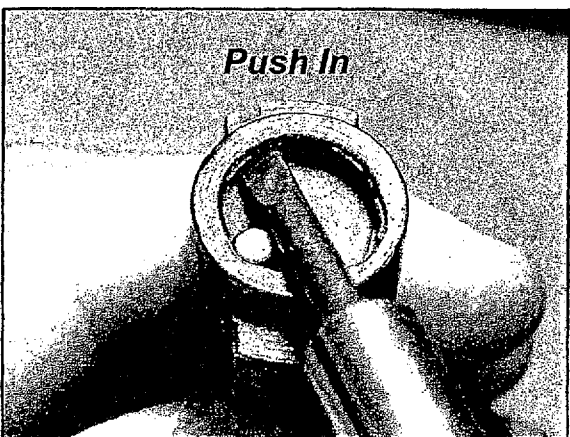
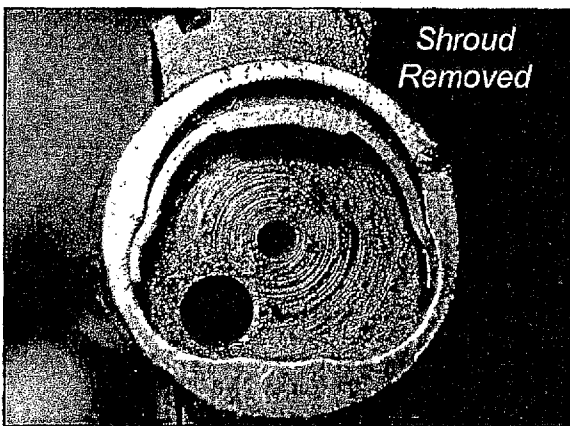
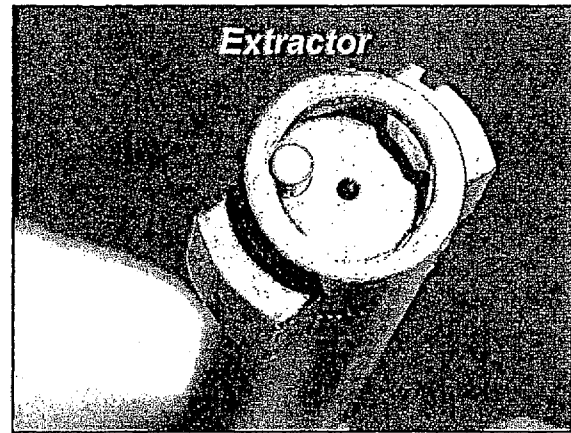
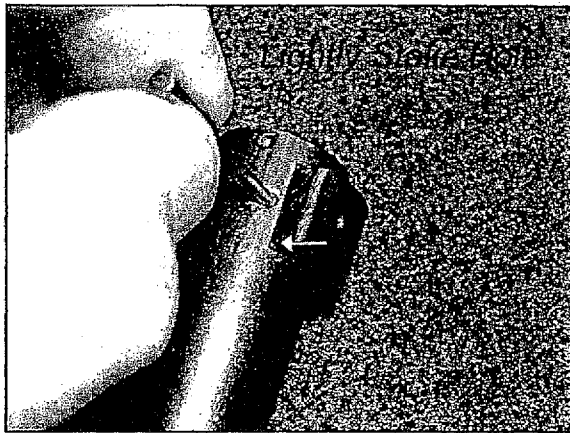

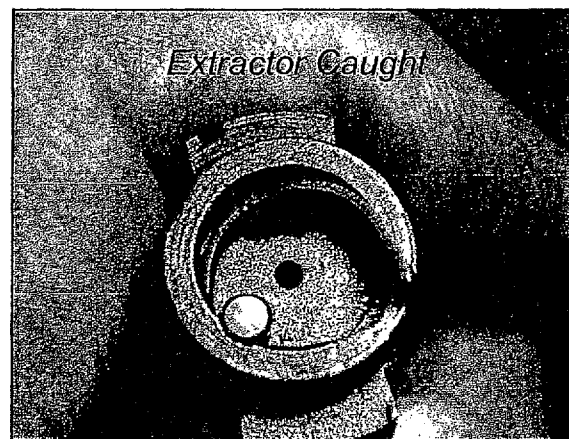
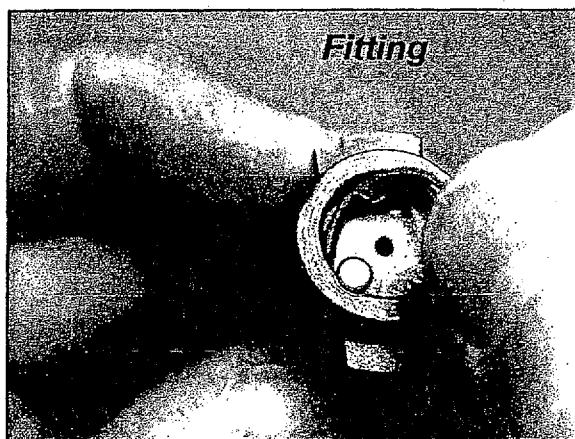
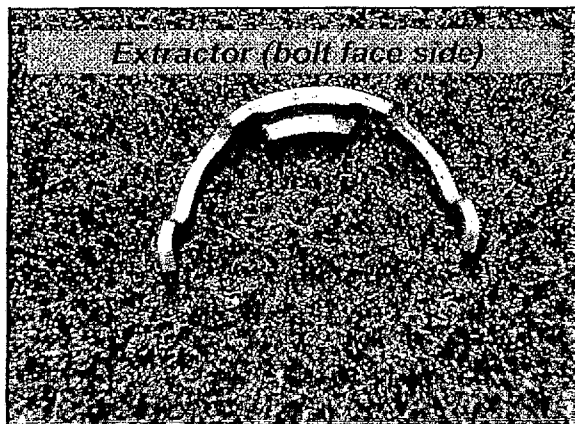
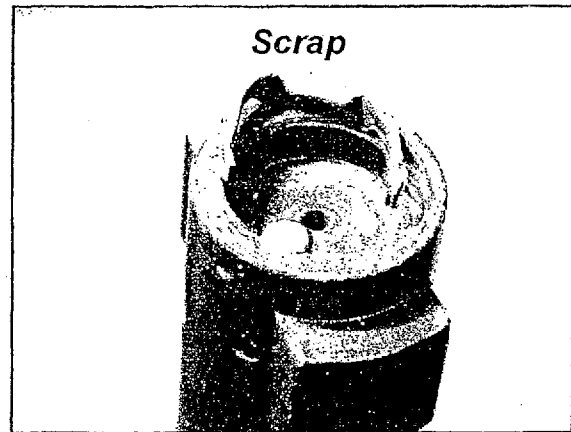
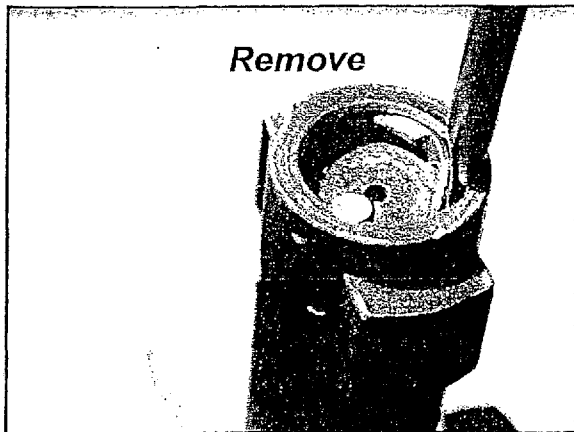

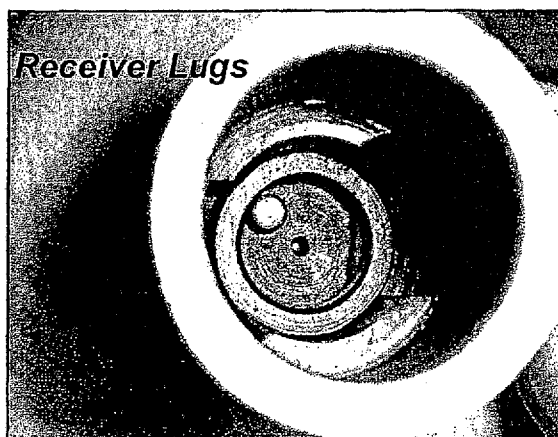
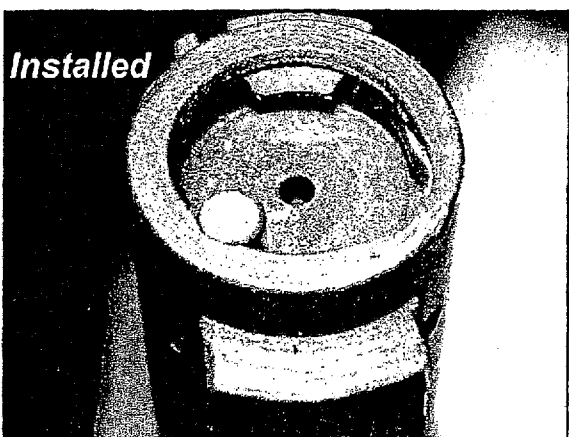
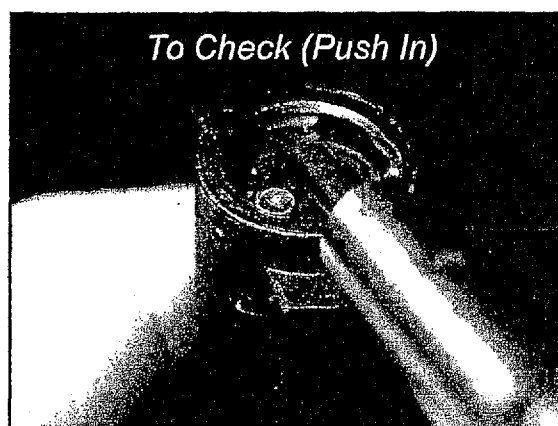
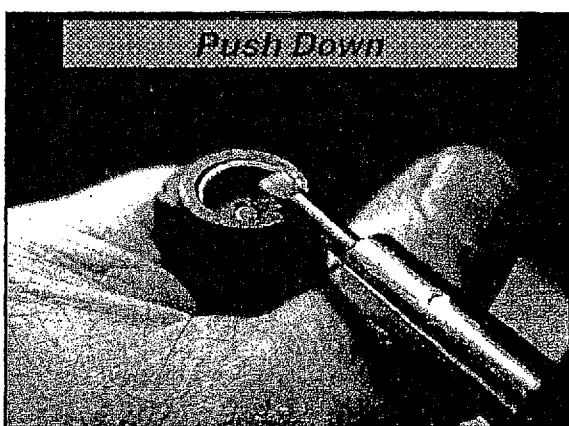

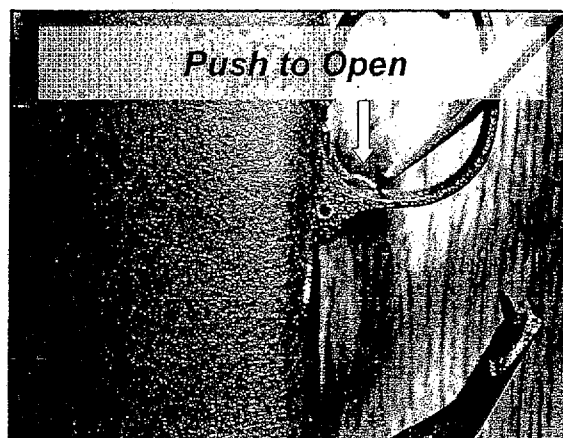
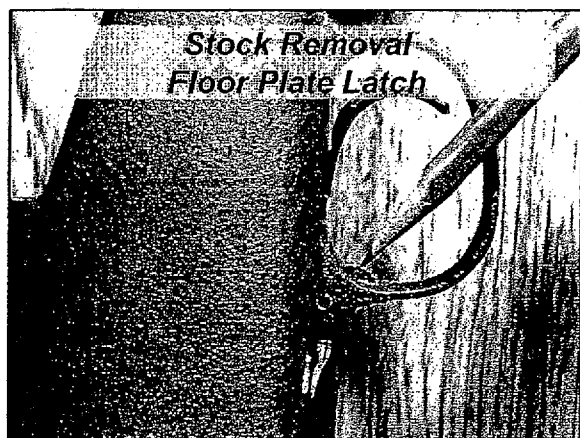
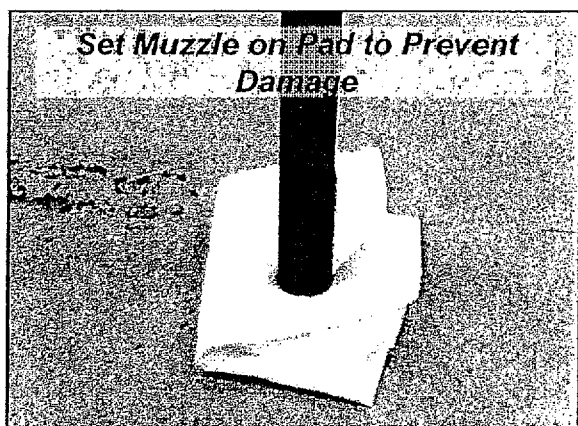
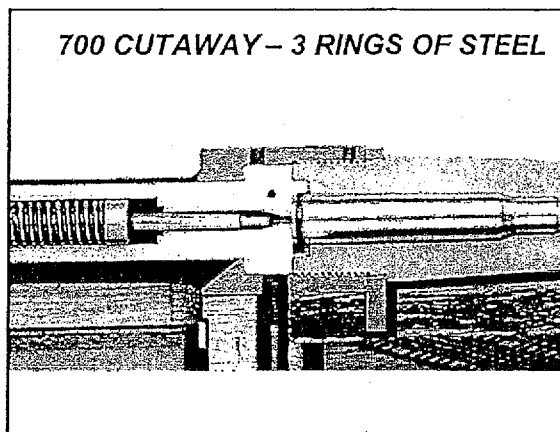
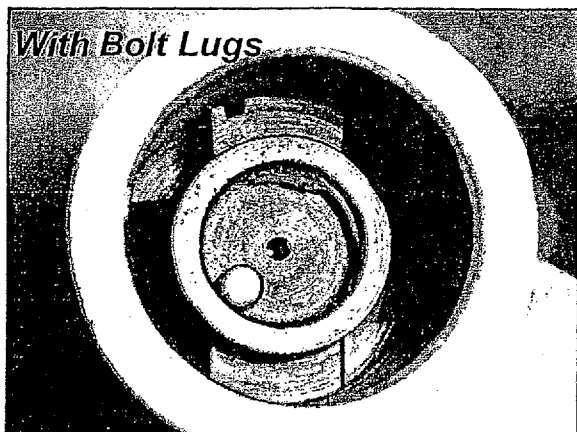

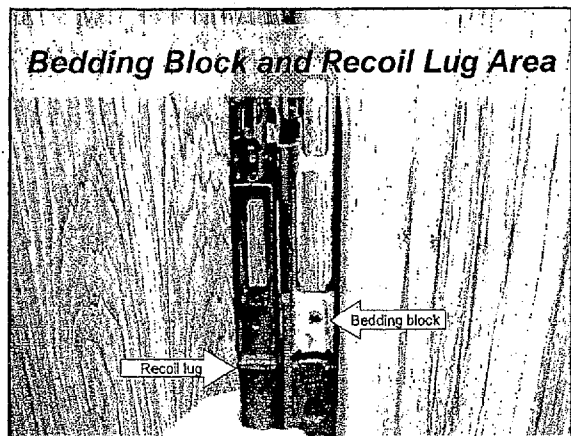
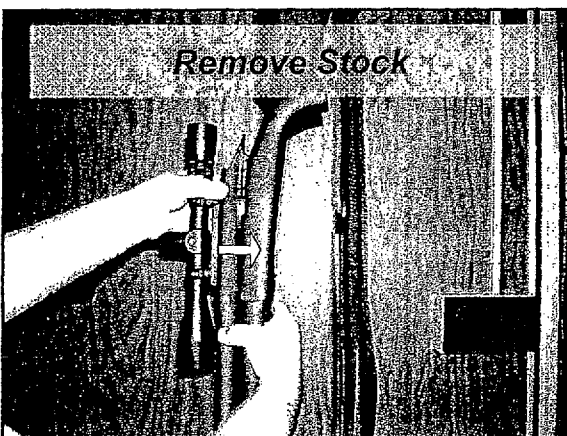
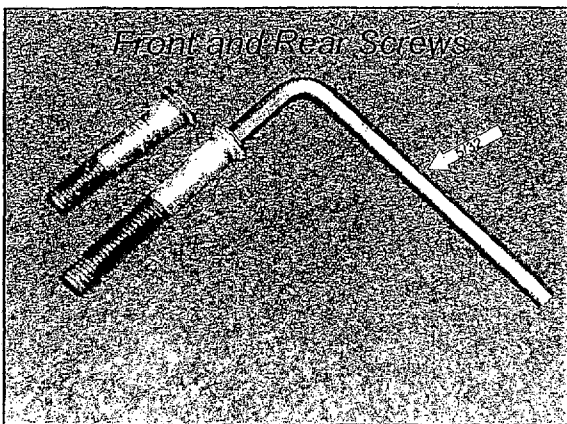
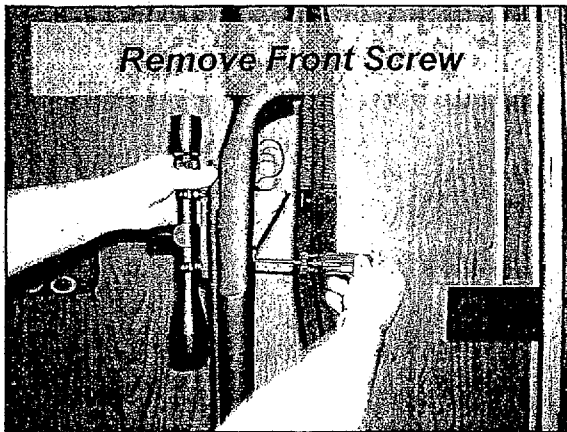

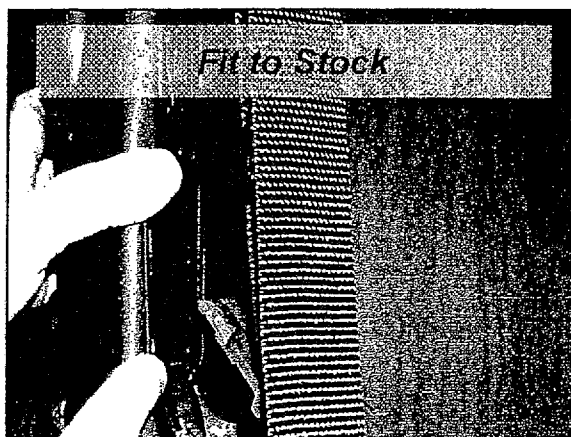
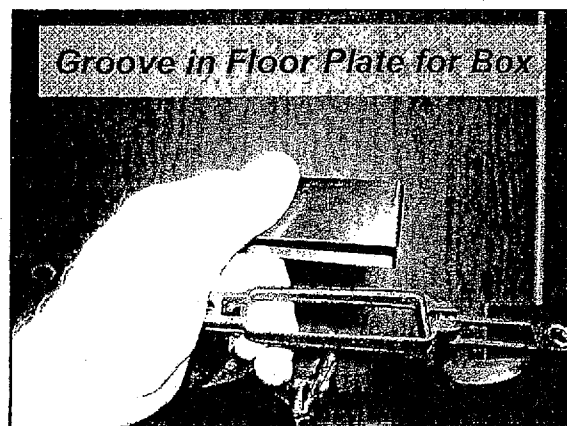
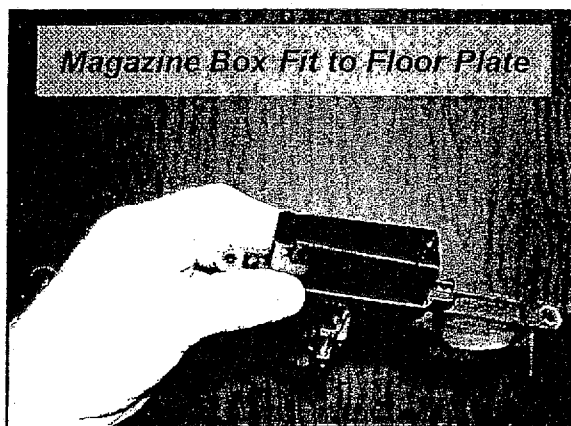
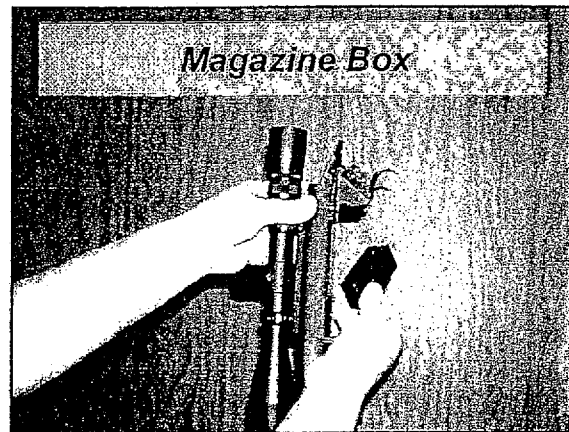
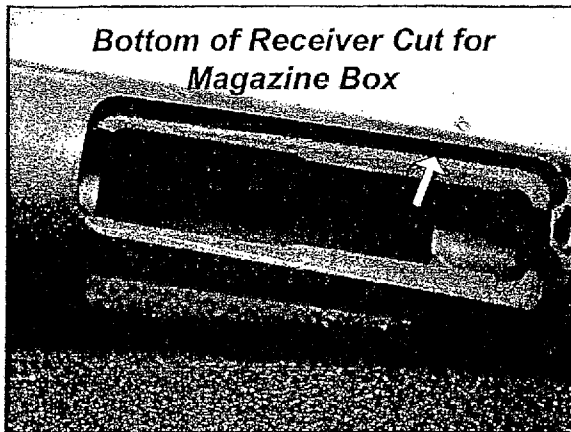

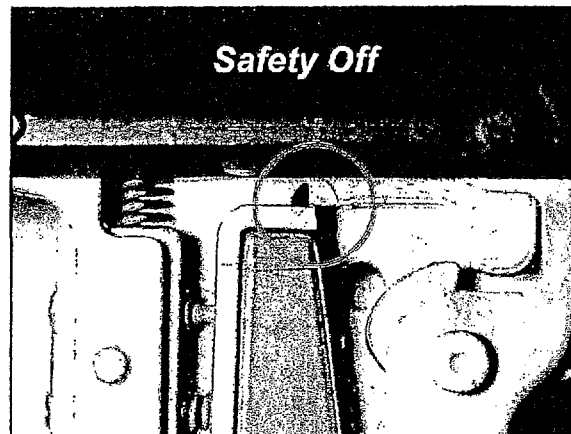
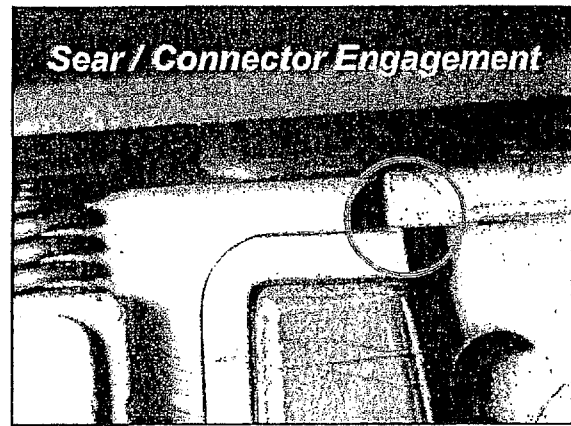
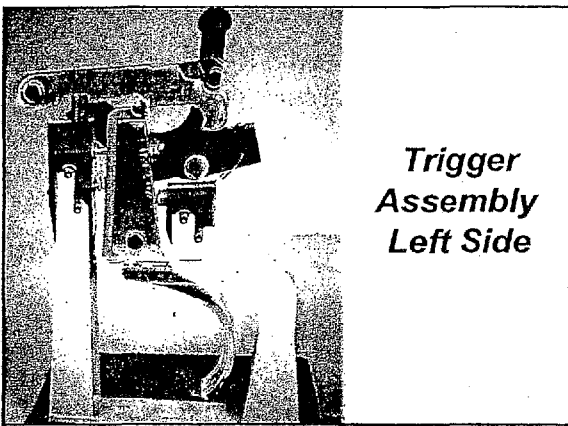
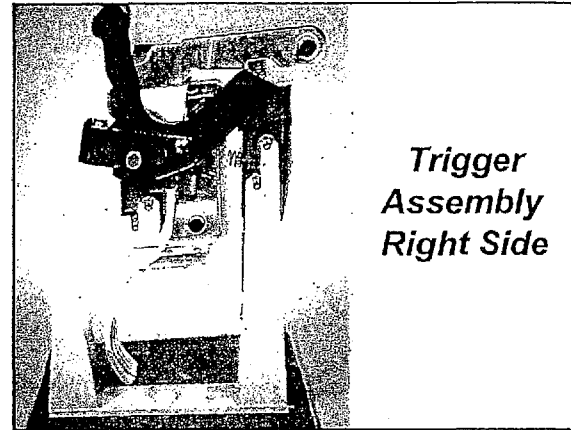
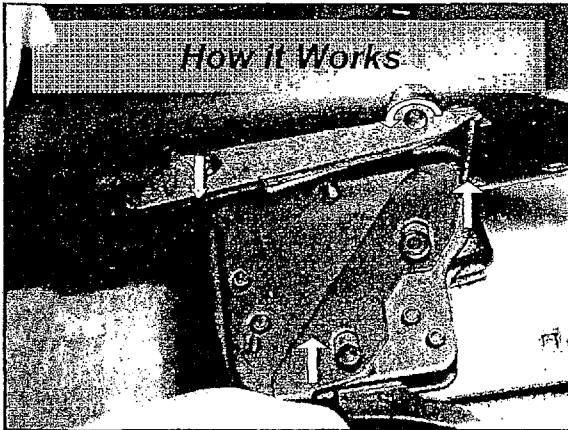

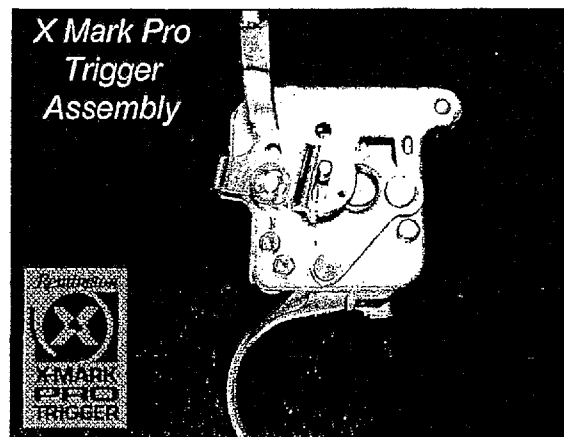
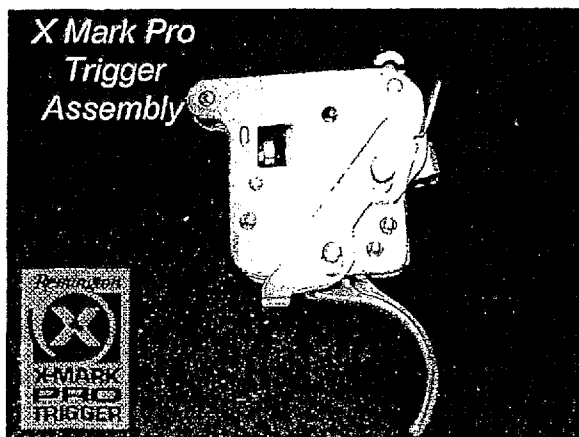
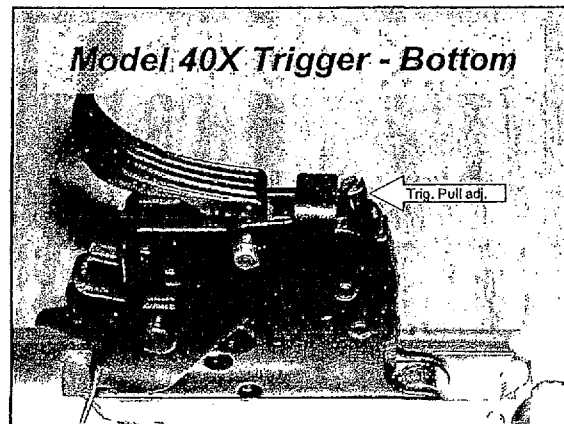
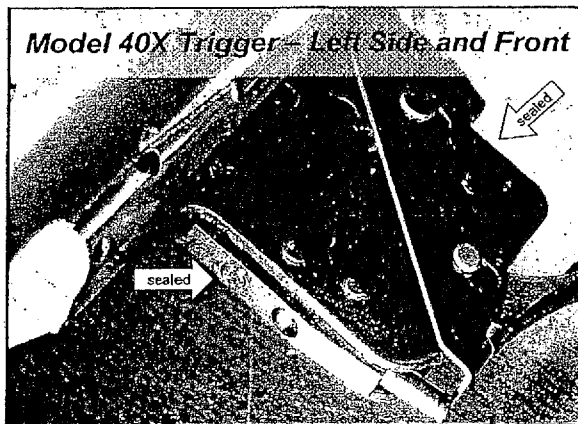
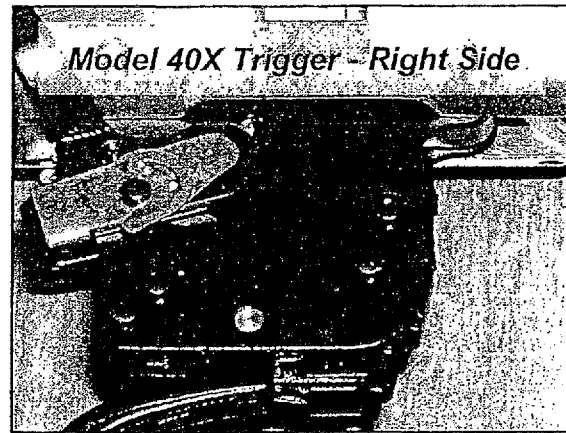
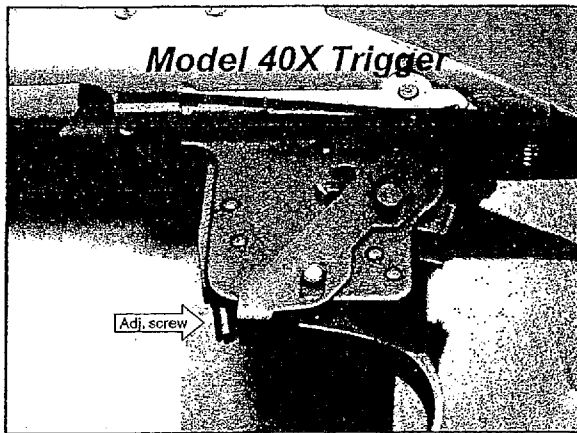

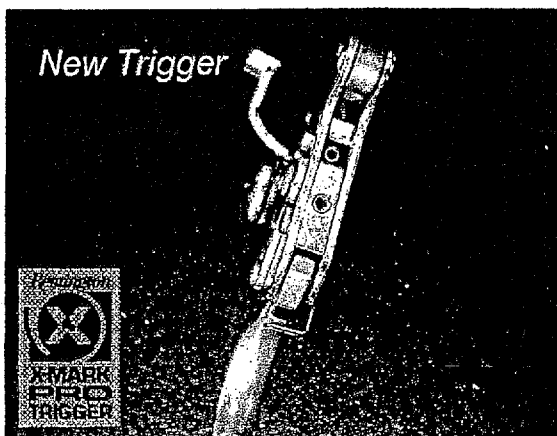
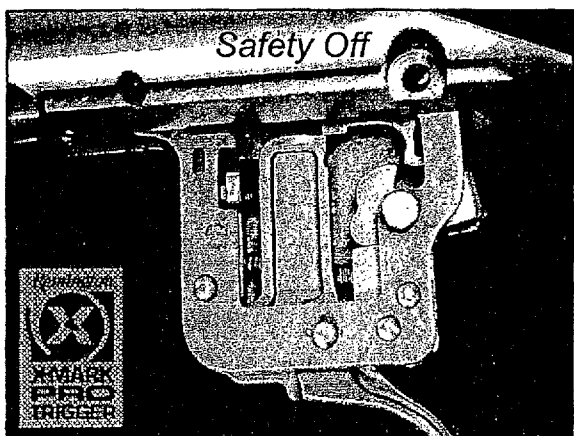
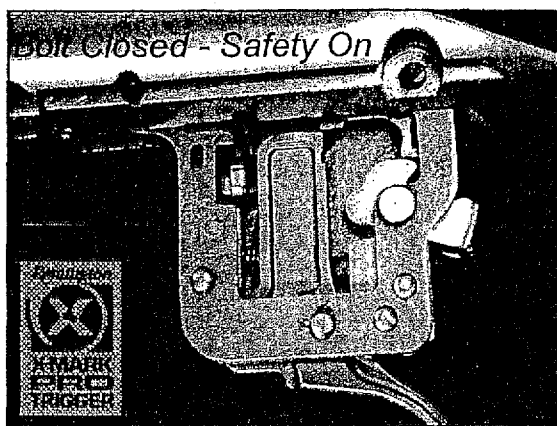
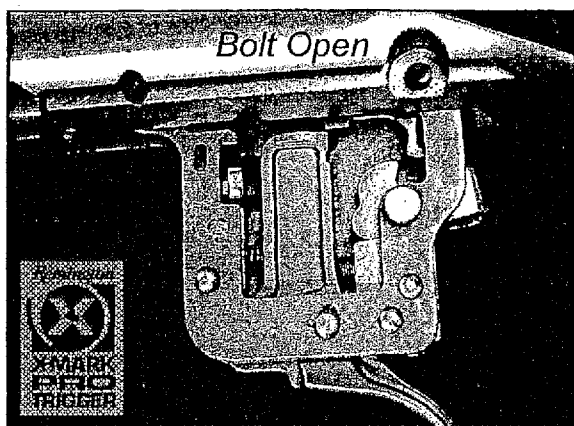
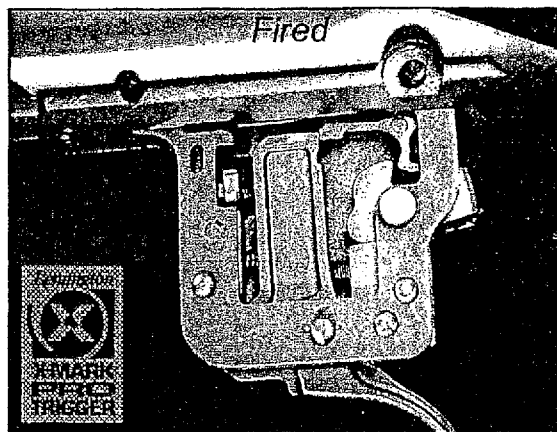
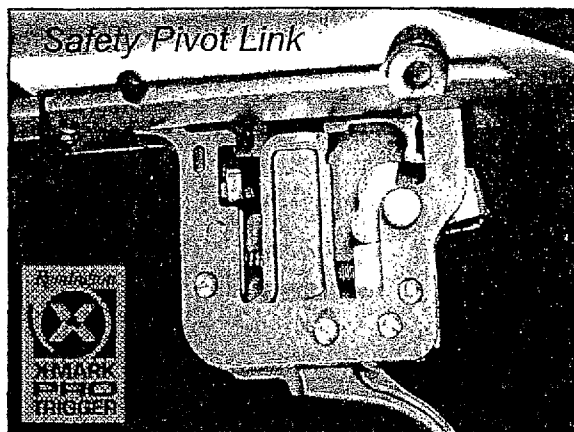

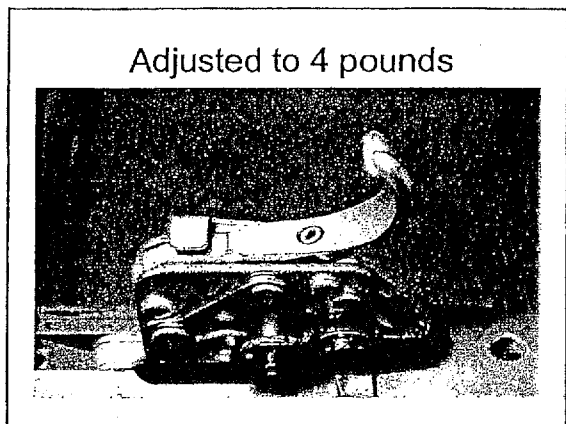
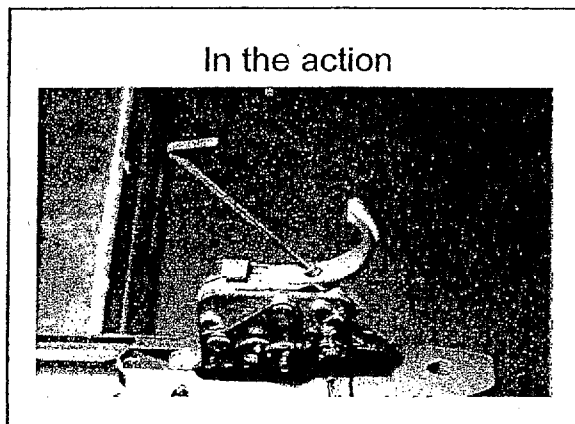
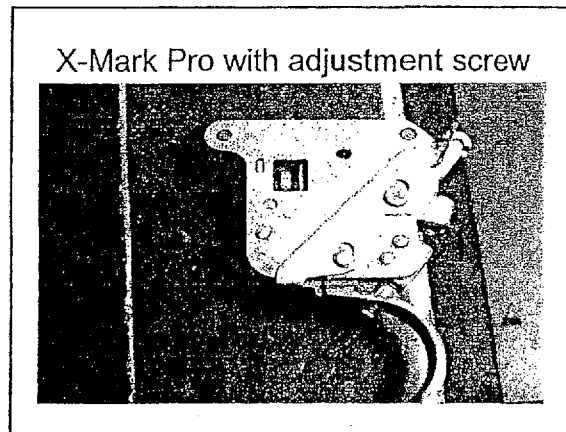
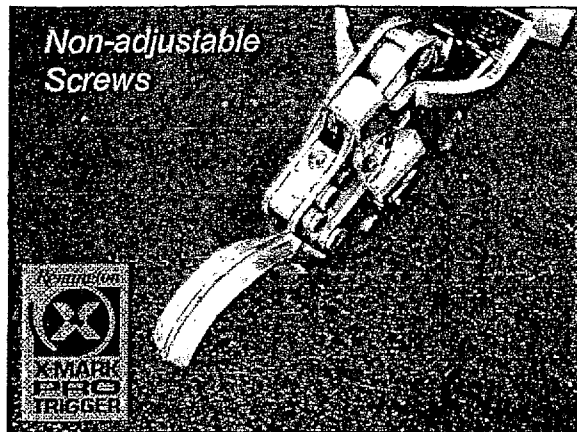

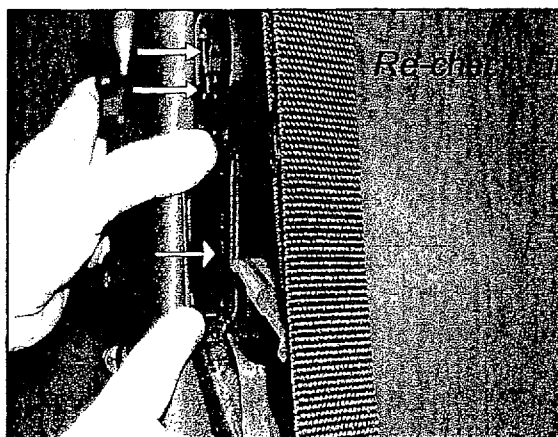
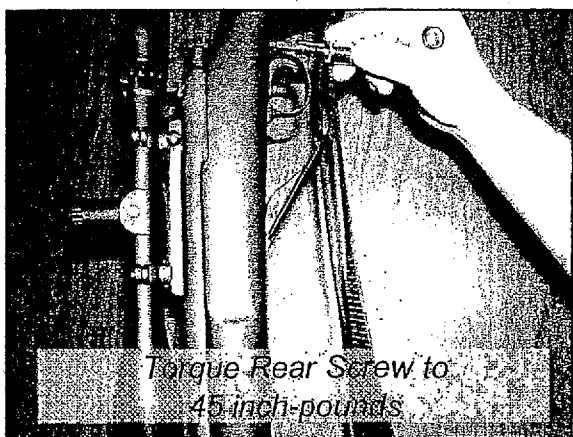
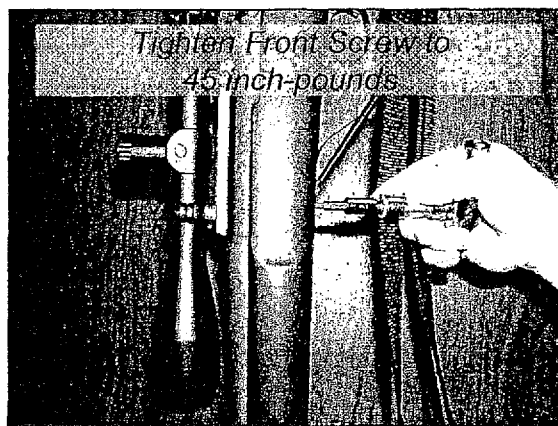
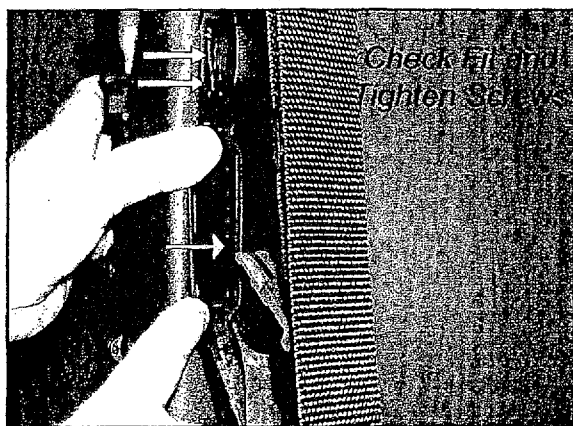
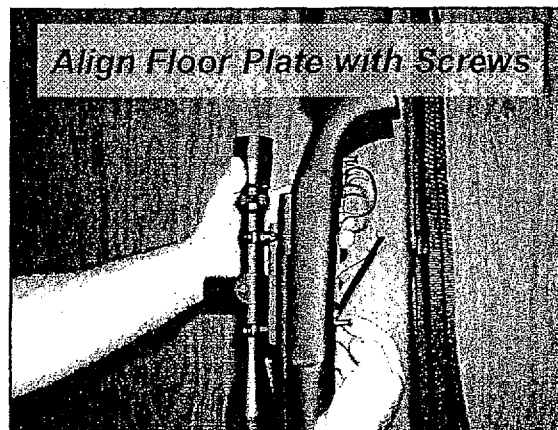
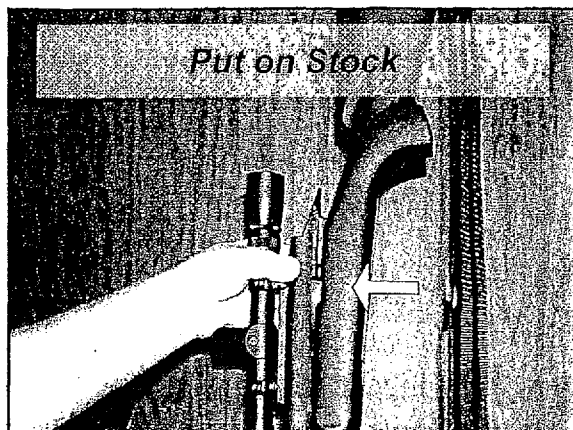

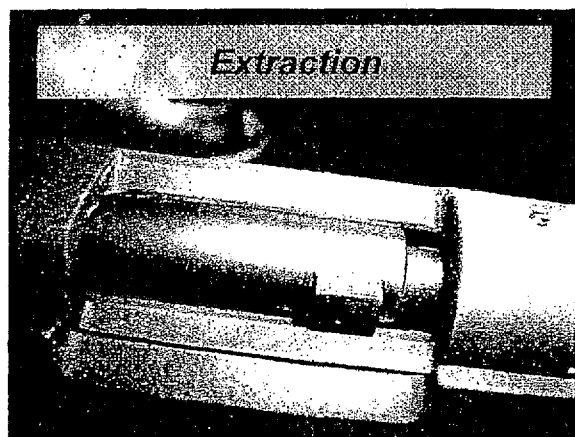
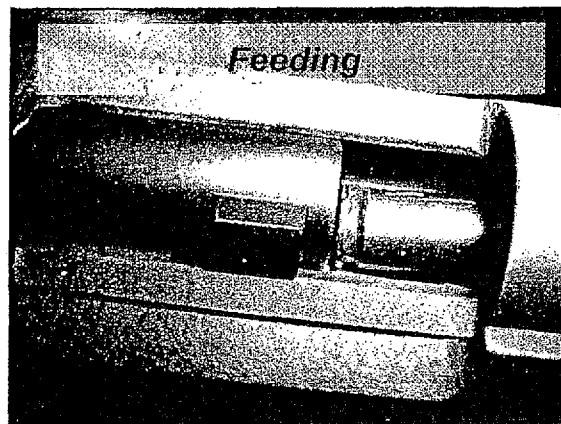
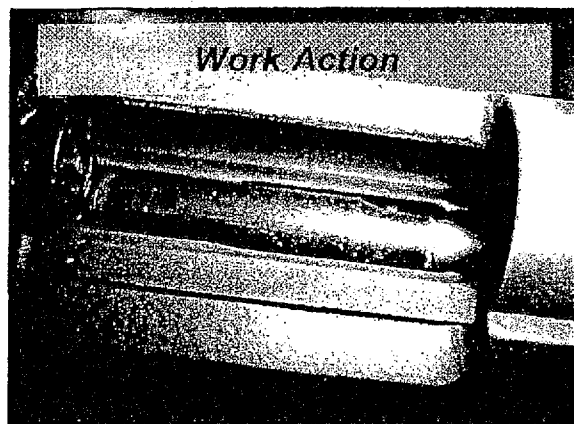
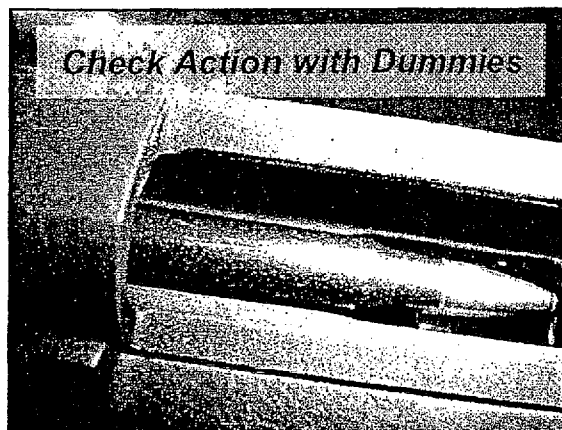
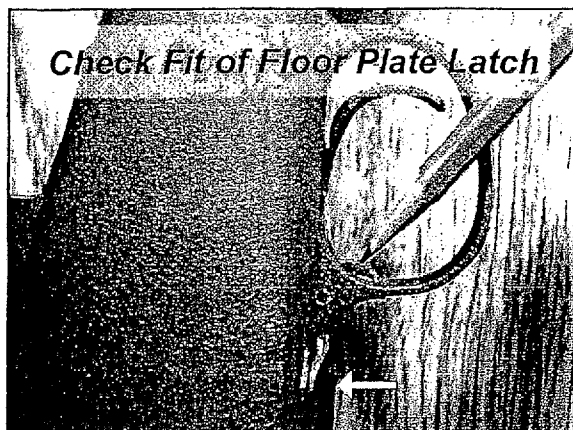

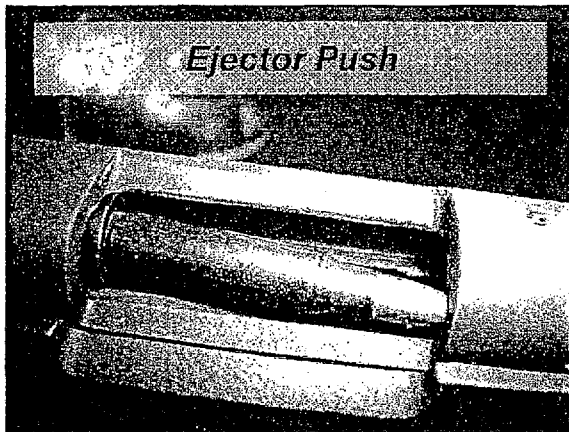

Ejector Push

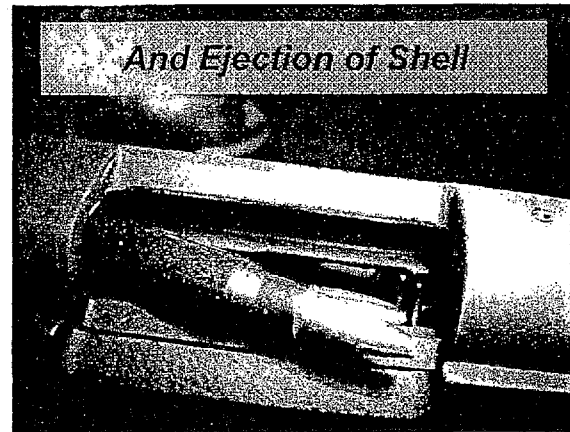

And Ejection of Shell

Model 700-P Variations

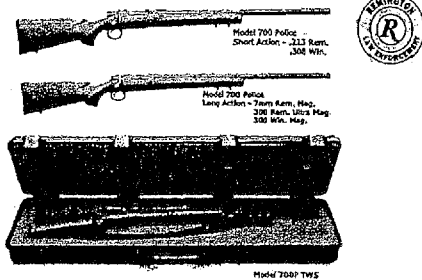

Model 700 LTR Light Tactical Rifle

- 20 inch, Hammer Forged Fluted Barrel
- Specifically Engineered Barrel Fluting
- H.S. Precision Stock w/ Full Aluminum Bedding Block
- Dual Front Swivel Studs
- A Full 1.5 lbs. lighter than the Model 700-P!!

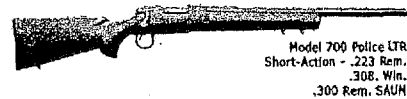

Model 700 Police LTR
Short-Action - .223 Rem.
.308, Win.
.300 Rem. SAUM

Model 40-XB Tactical

- 27 1/4" long bbl
- Stainless steel with Teflon coating
- Three longitudinal flutes
- Twist rate = 1 turn in 14"
- Buttoned rifled benches/target grade
- 7/8" muzzle diameter
- Special Rollmark on barrel 40XB TACTICAL
- 308 Win. Caliber



1/2" or less group with proper ammo at 100 yards***

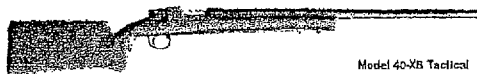

Model 40-XB Tactical

Model 7600-Patrol Rifle

- 16 1/2 inch bbl w/ 1 in 10" twist
- .308 Win.
- 37 1/2 inches over-all length
- 7 lbs.
- Synthetic stock and fore end
- Carbon Steel bbl and receiver
- Parkerized finish
- Swivel Studs for QD sling attachment
- Wilson Combat Rear Ghost Ring
- XS Sight Standard Dot Front

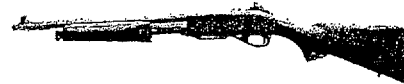

Model 7615-P

- 16 1/2" barrel - 1 in 9" twist
- Synthetic Stock and FE
- Parkerized finish
- .223 Remington
- Wilson Combat Rear - XS front sight system
- Magazine capacity - Accepts the AR-15 Style Mags - 10 thru 30 round.
- 7 Lbs
- Swivel Studs for QD sling attachment



M-24 SWS

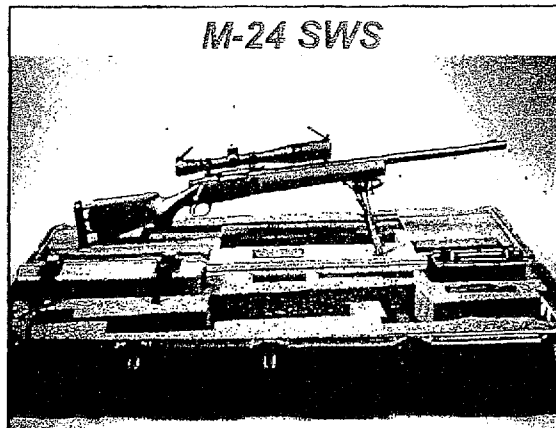

Remington M24

- Bolt Action, 7.62mm x 51mm rifle
- Leupold Mark IV M3-10X 40mm Optical Day Sight
- Day Sight, O.K. Weber
- Optical Sight Carrying Case
- Component Case
- Deployment Kit
- Operator's Manual
- BI Pod (optional)*
- Sling Strap (optional)*



* Not Included in Base Price

Remington Armorer's School

**Model 700 Police
Rifle**



Model 700 Police



Tools

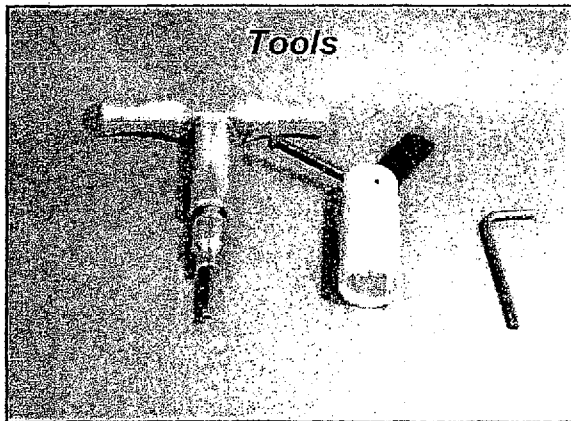

Solid Steel Actions

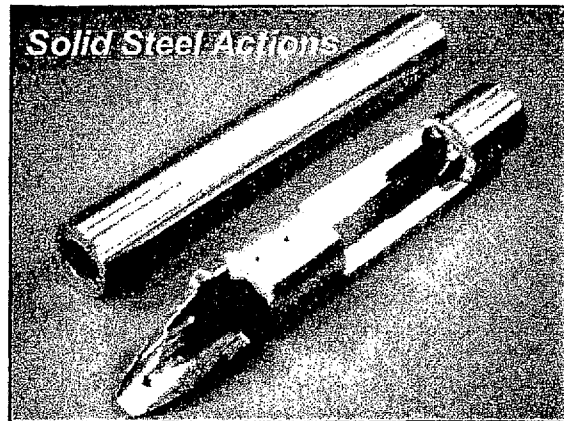

Overall Sight Picture
Back to front

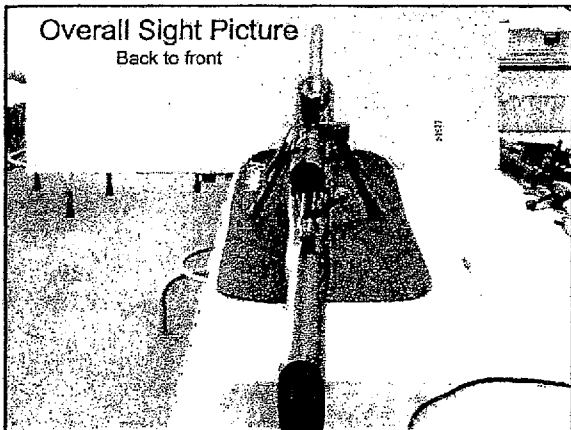

Front to Back

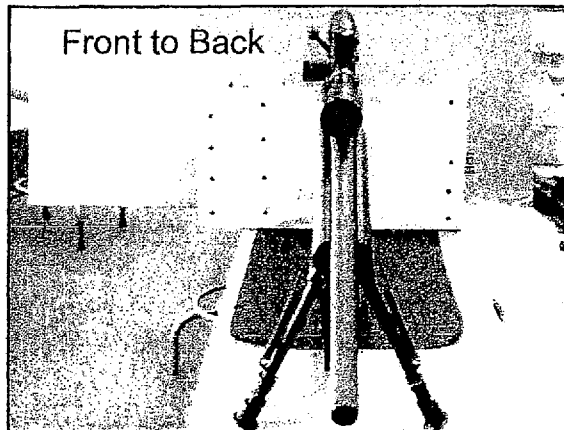

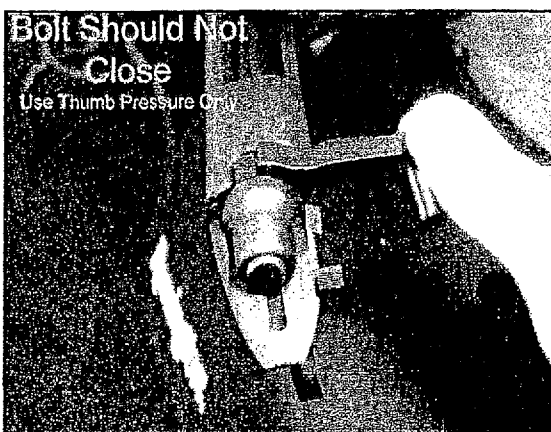
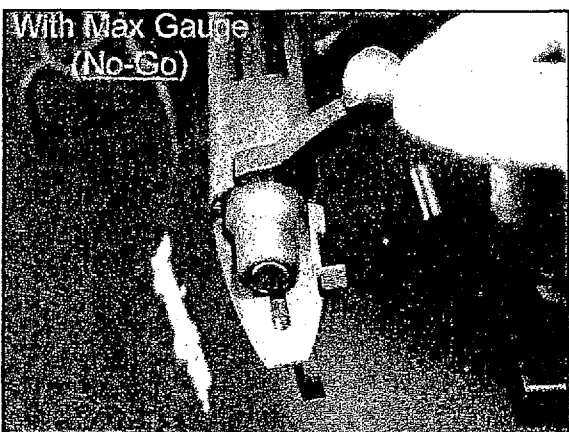
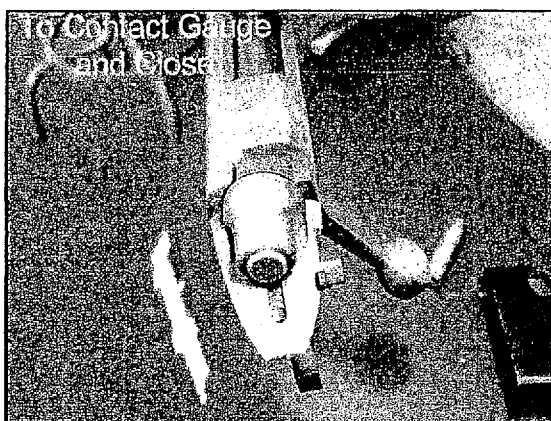
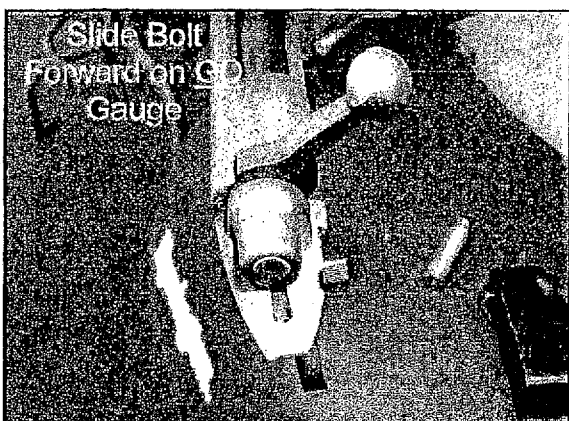
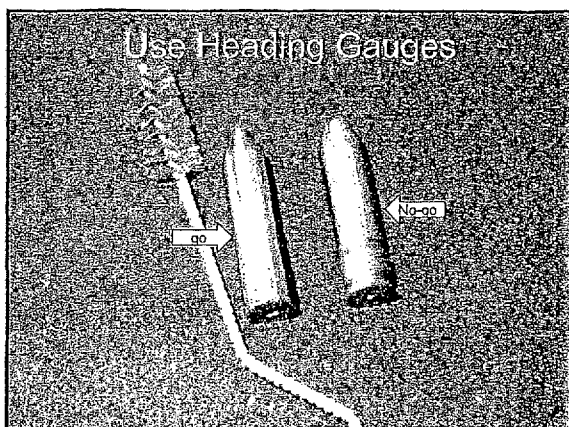

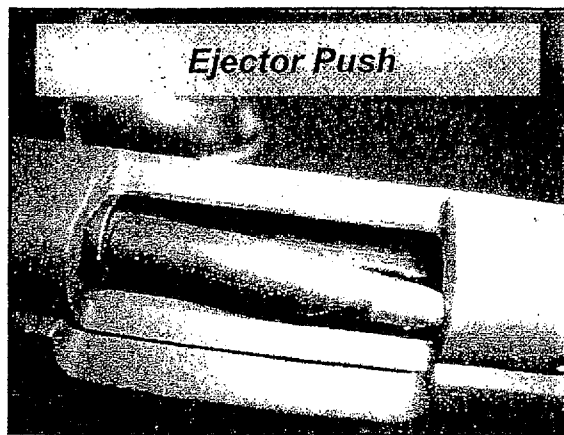
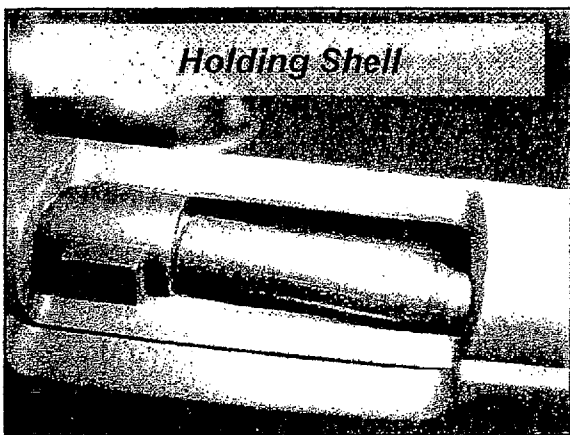
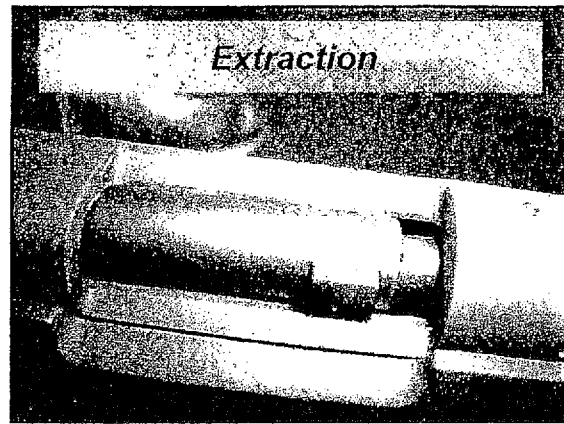
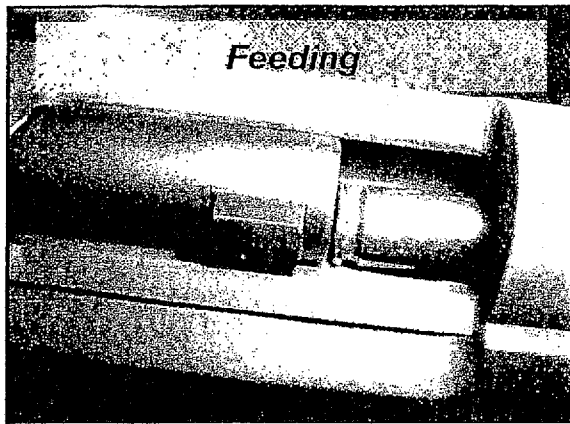
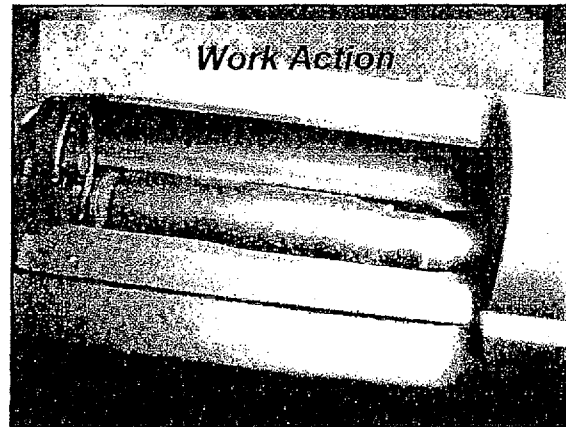
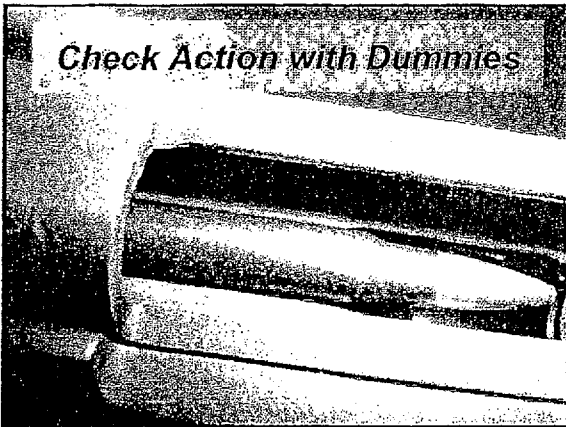

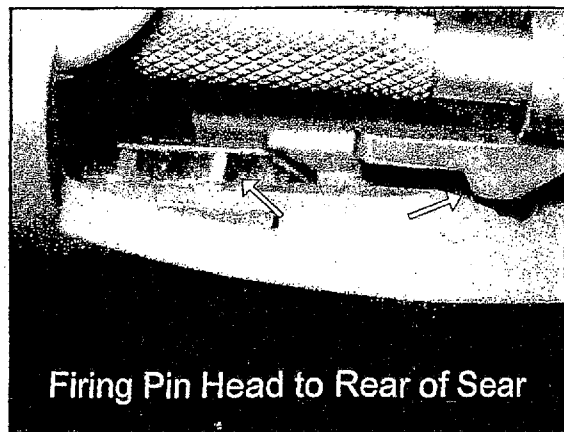
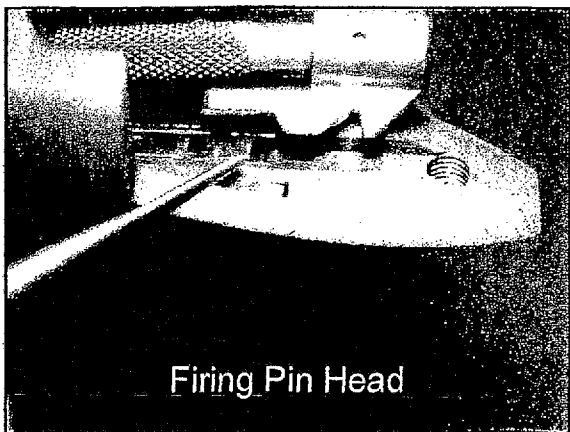
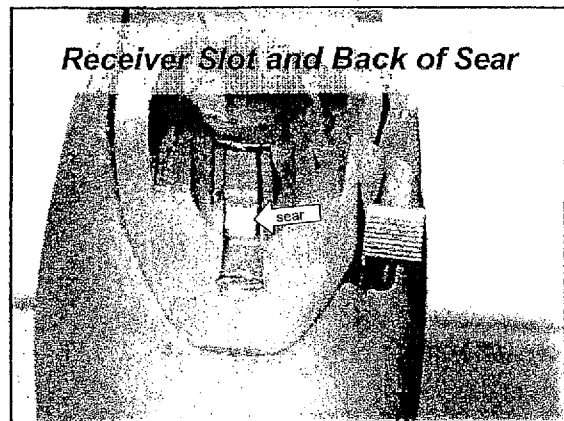
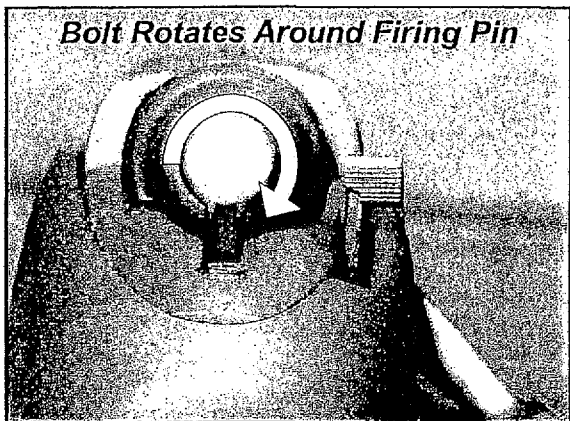
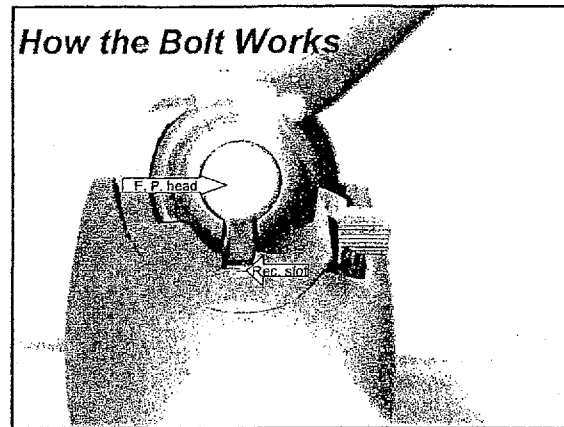
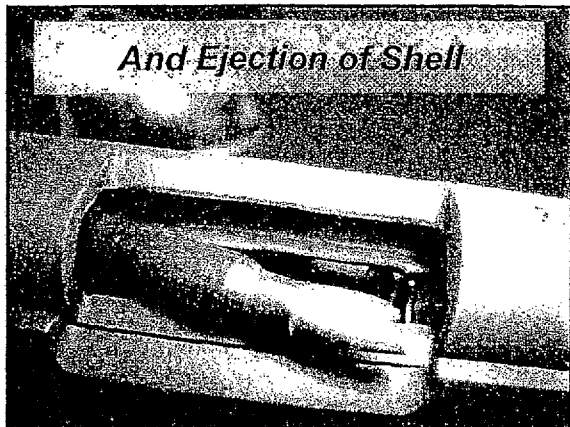

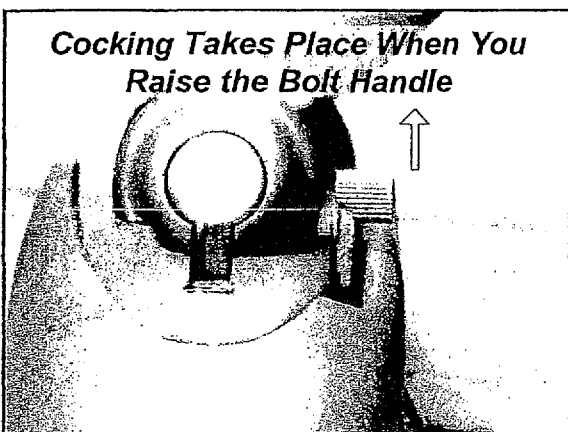
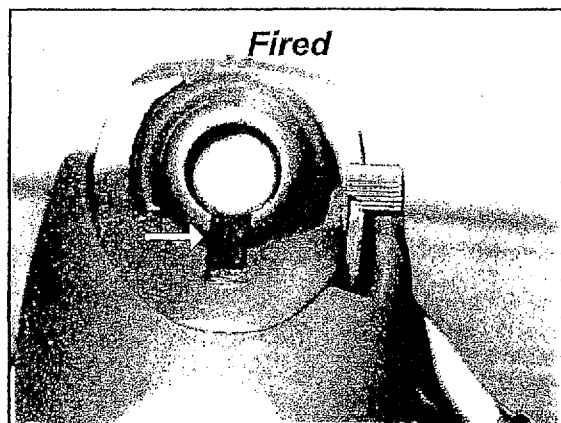
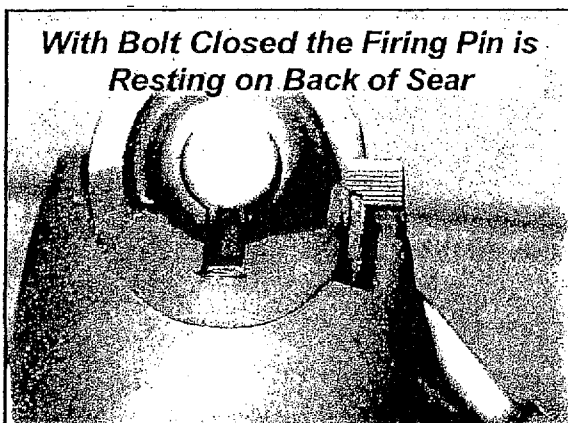
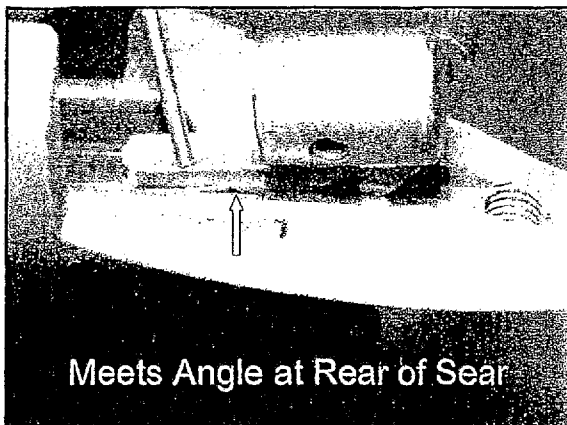

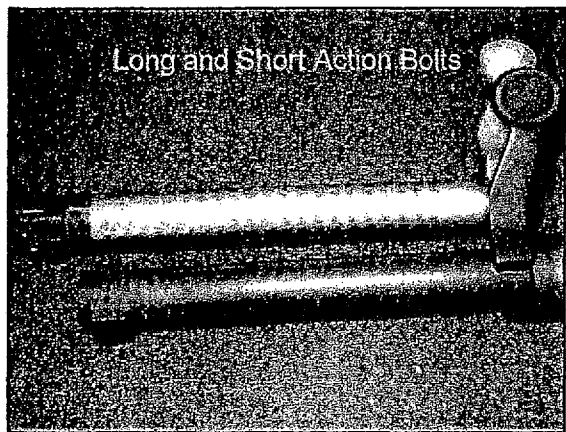
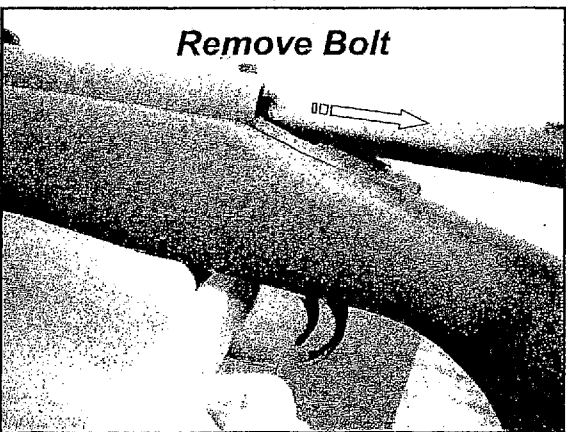
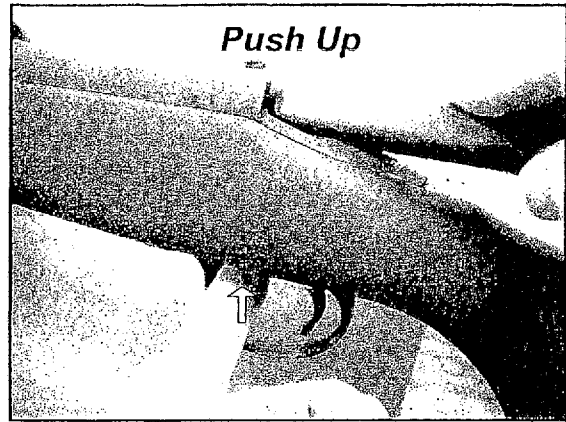
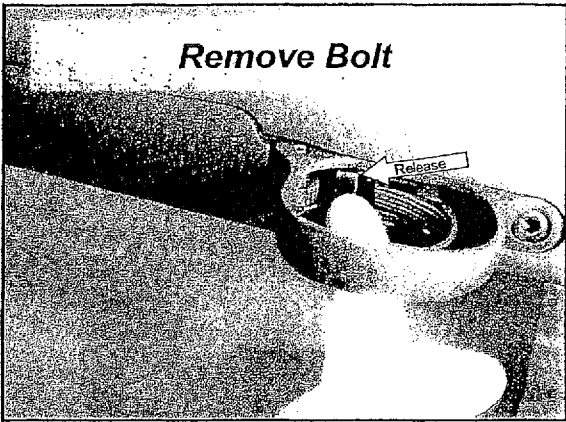
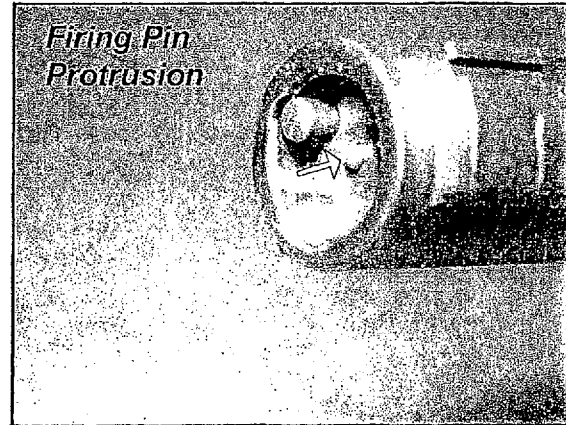
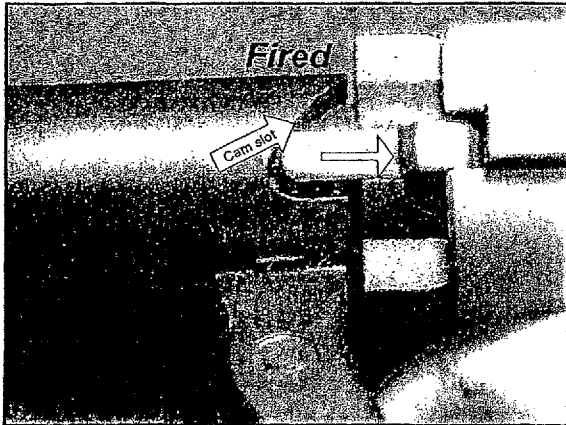

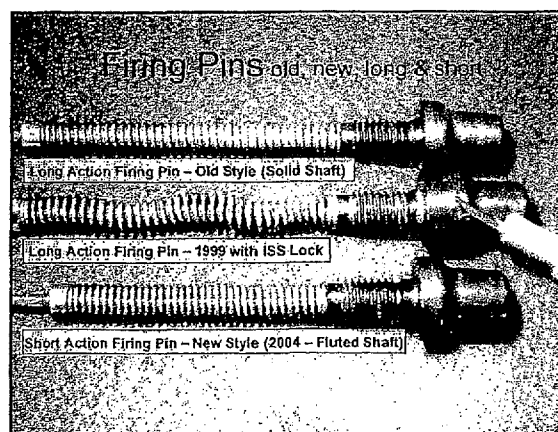
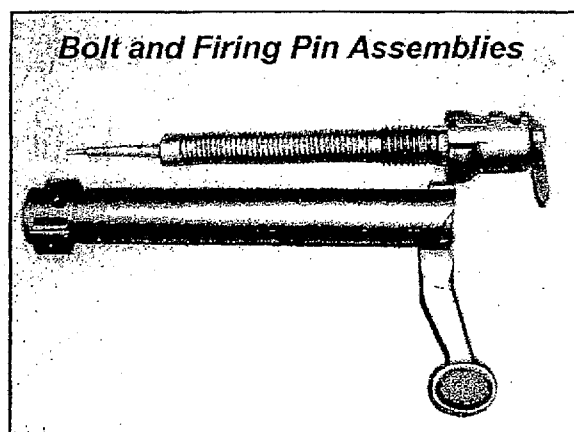
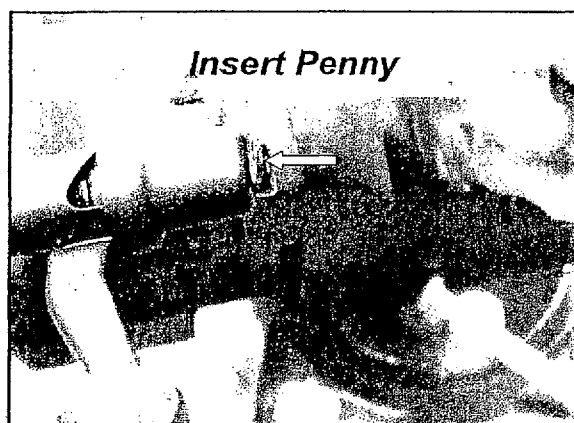
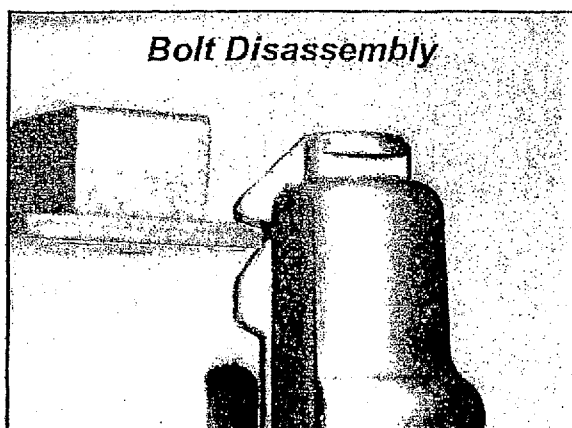

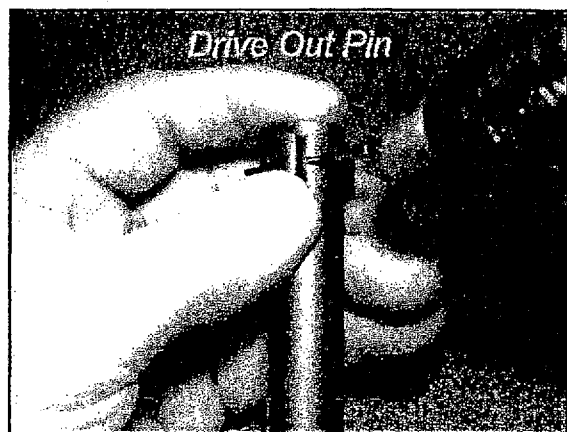
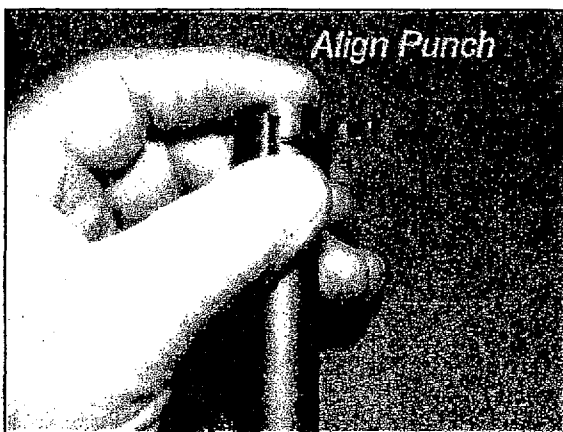
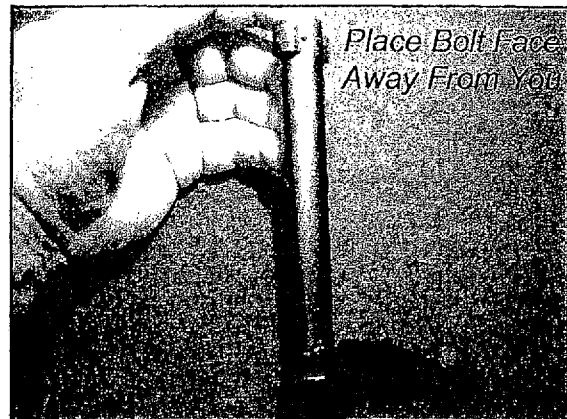
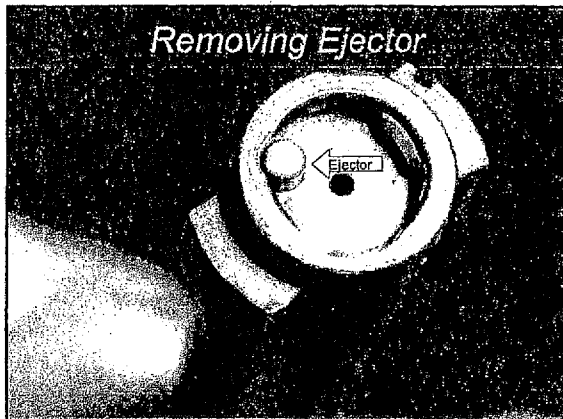
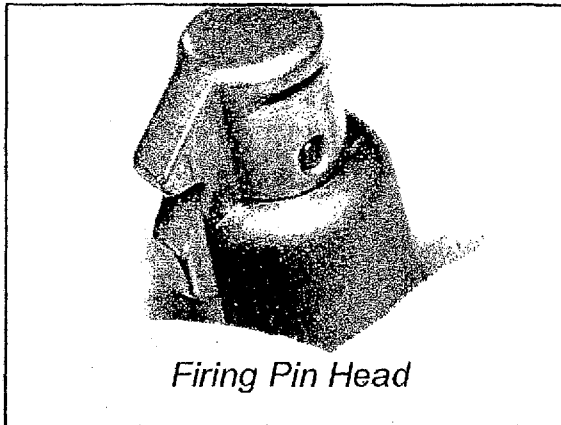

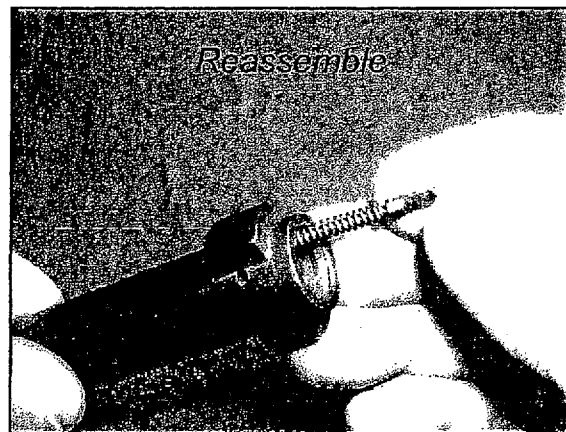
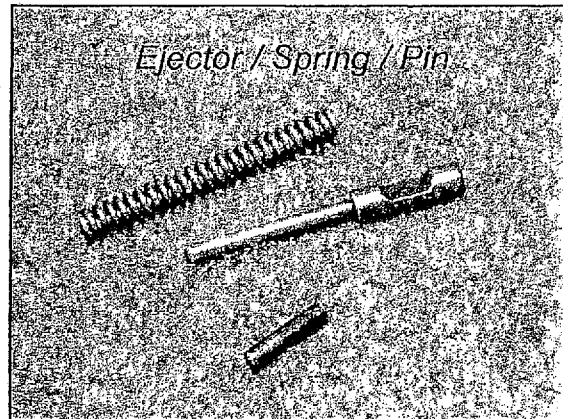
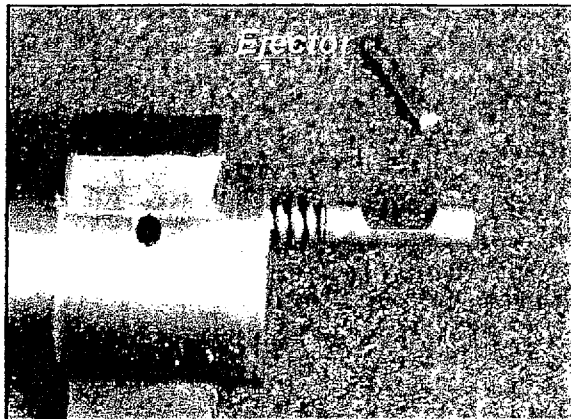
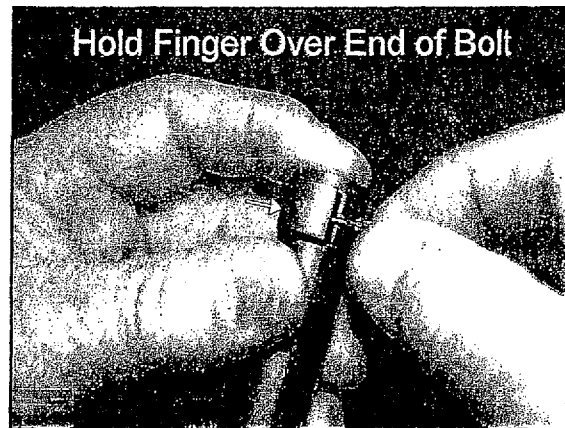
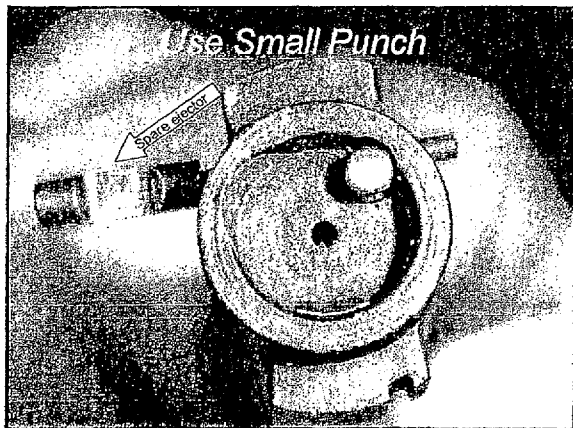

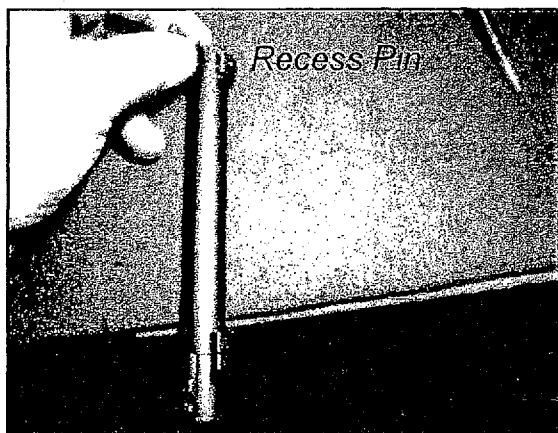
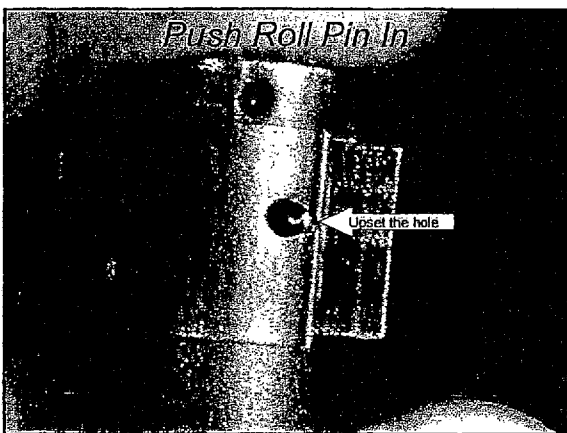
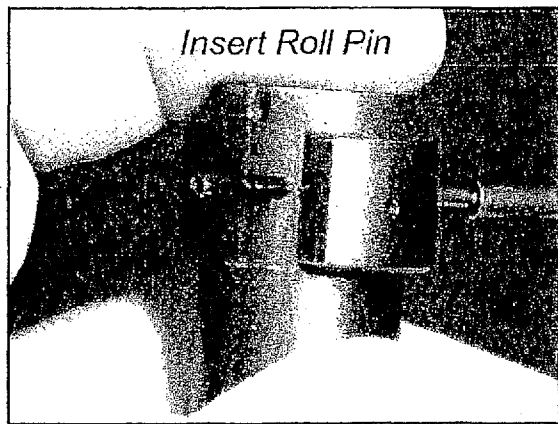
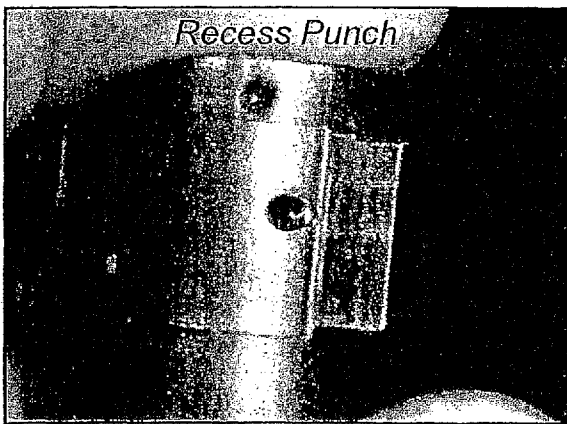
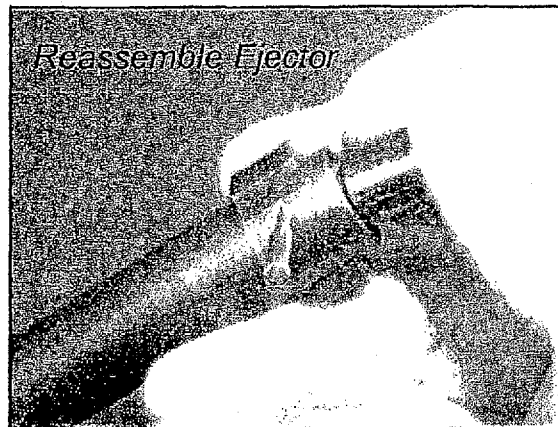
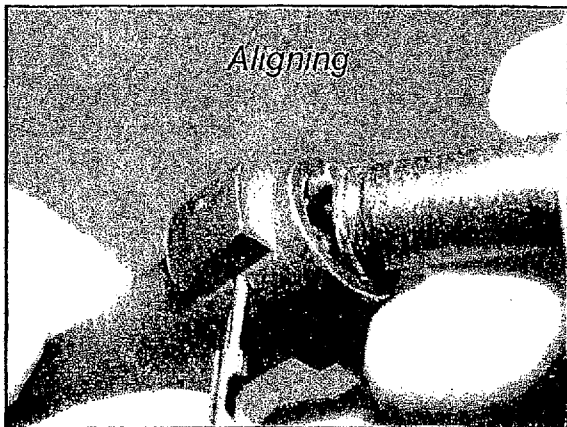

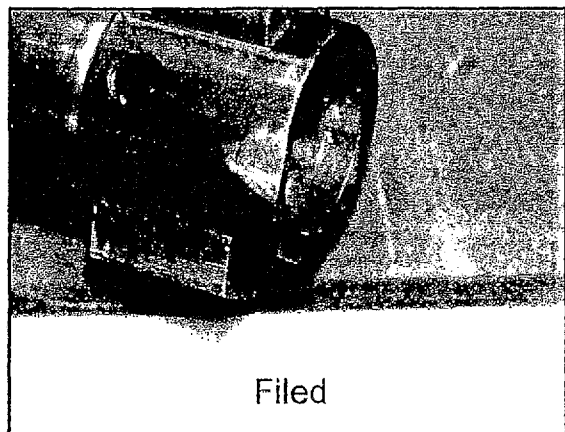
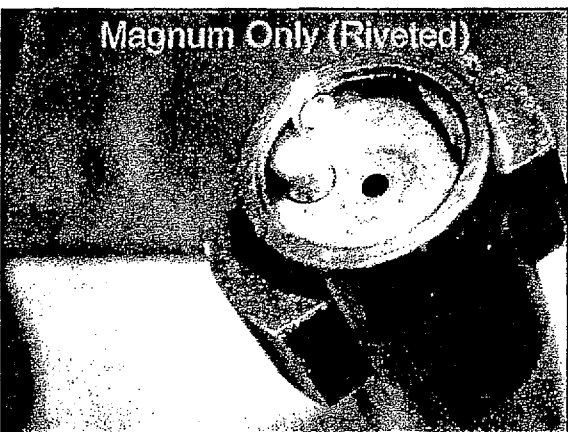
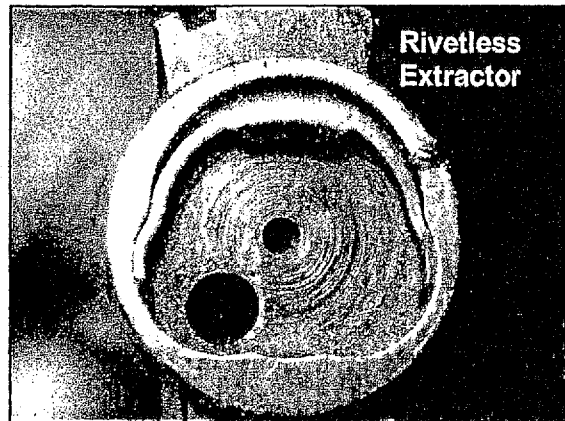
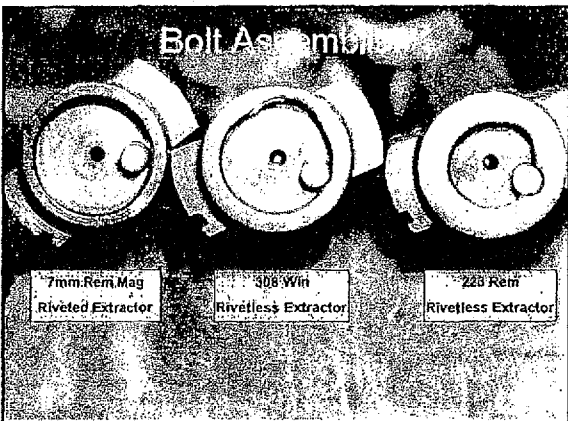
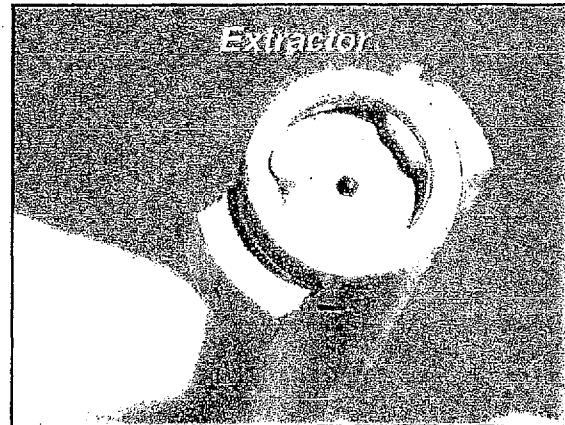
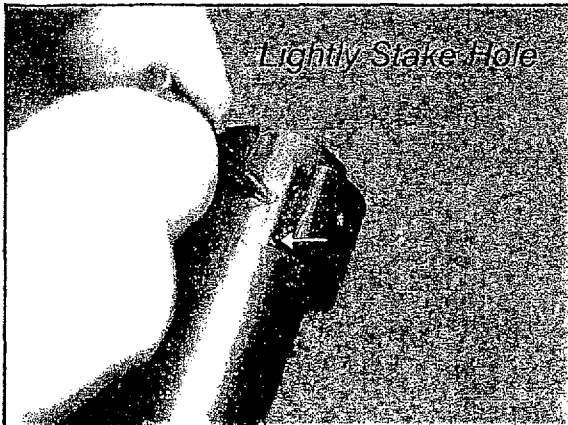

Extractor Removal

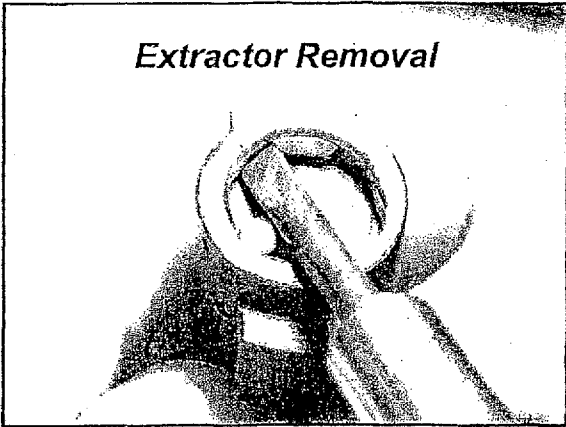

Push In

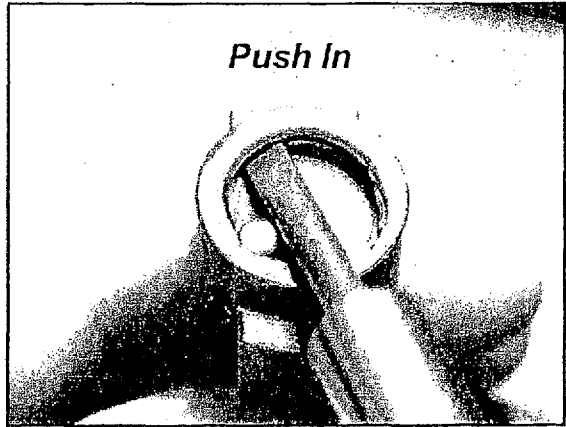

¼ Turn Clockwise

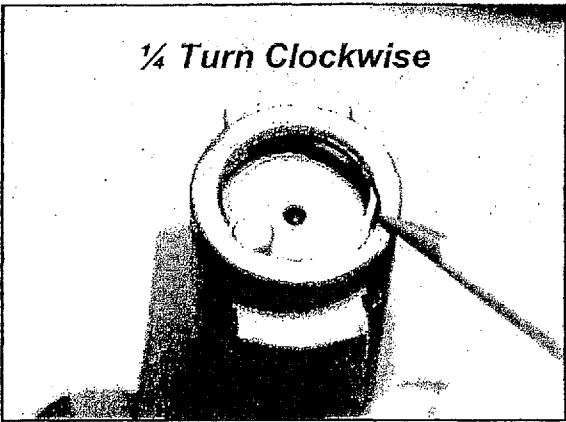

Remove

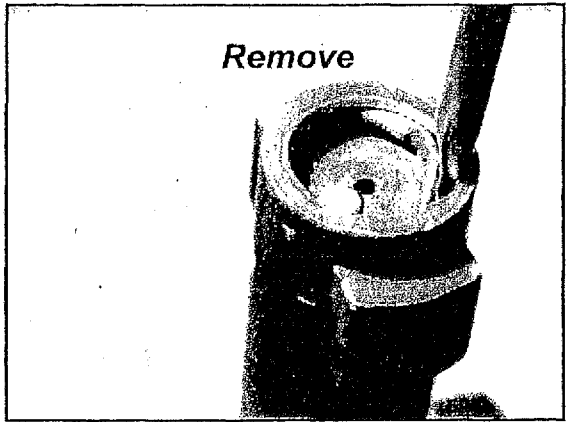

Scrap

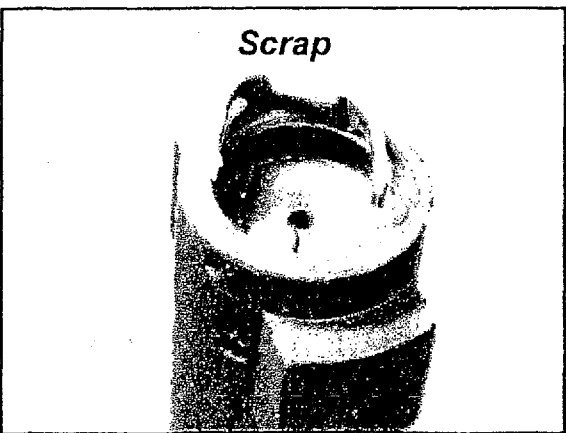

Extractor (bolt face side)

