

*Remington*®

## MODEL 700

### INCLUDES VARMINT MODEL

## BOLT ACTION

### HIGH POWER RIFLE

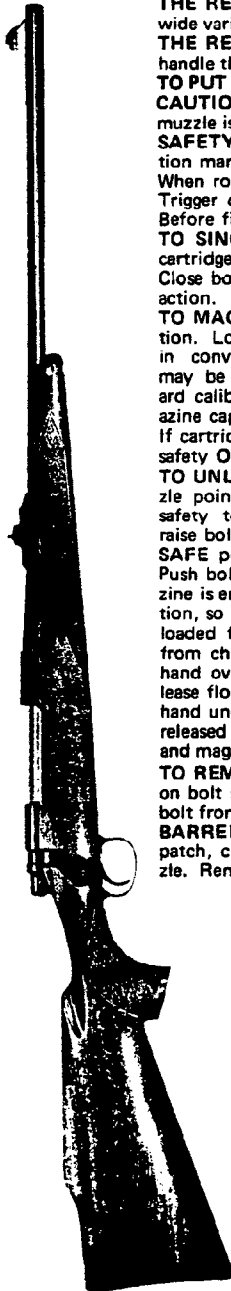

**THE REMINGTON MODEL 700** is a high quality bolt action repeater available in a wide variety of center fire calibers. Two grades are supplied-ADL (standard) and BDL. **THE REMINGTON MODEL 700 Varmint** is a BDL grade rifle expressly designed to handle the high velocity "Varmint" calibers.

**TO PUT BOLT IN RIFLE**—Align bolt lugs to receiver and slide cocked bolt into rifle. **CAUTION** — While handling, carrying, loading or unloading rifle, make sure muzzle is pointed in a safe direction.

**SAFETY (Fig. 1)** — To engage safety to **ON SAFE** position, rotate to rear stop position marked "S" on receiver. Bolt handle will be locked down and rifle will not fire. When rotated forward to fire position, marked "F" on receiver, safety will disengage. Trigger can be pulled to fire rifle or bolt handle raised to open action. **CAUTION:** Before firing, make sure barrel is clean, free of heavy oil, grease, or any obstruction. **TO SINGLE LOAD** — Raise bolt handle and pull rearward to open action. Place cartridge upon magazine follower or directly into chamber. Put safety **ON SAFE**. Close bolt. Lower bolt handle to lock action.

**TO MAGAZINE LOAD** — Open action. Load cartridge into magazine in conventional manner. Magazine may be loaded with four (4) standard caliber cartridges. Magnum magazine capacity is three (3) cartridges. If cartridge is loaded in chamber put safety **ON SAFE** before closing bolt.

**TO UNLOAD** — Hold rifle with muzzle pointed in safe direction. Move safety to **OFF SAFE** position and raise bolt handle. Move safety to **ON SAFE** position and pull handle rearward. Grasp cartridge and remove from action. Push bolt forward until next cartridge is released from magazine. Repeat until magazine is empty. **CAUTION:** Safety will be in the fire position during part of this operation, so keep muzzle pointed in safe direction. BDL grade magazine may also be unloaded from bottom. Raise bolt handle, pull bolt rearward and remove cartridge from chamber. Leave bolt in open (rear) position and put safety **ON SAFE**. Place hand over ejection port and turn rifle bottom upward. Press floor plate latch to release floor plate (Fig. 2). Lift floor plate, spring and follower clear of magazine, place hand under open magazine and turn rifle back to upright position. Grasp and remove released cartridges. Close and latch floor plate. **CAUTION:** Carefully inspect action and magazine to be sure no cartridges remain in rifle.

**TO REMOVE BOLT** — Press upward on bolt stop release (Fig. 2) and pull bolt from rifle.

**BARREL CARE** — Use lightly oiled patch, cleaning from breech to muzzle. Remove bolt to make cleaning easier. Scrub bore with cleaning solvent if necessary. To insure maximum accuracy, wire brush cleaning of barrel bore in all varmint calibers is recommended after each 25 rounds.

**ACTION CARE AND DIS-ASSEMBLY** — Remove bolt and stock if necessary to clean action or replace parts. Unscrew guard screws and lift stock away from action and barrel. Clean bolt and action in solvent and wipe clean. Before reassembly, stock to receiver, particularly on ADL Grade, locate magazine fully in magazine recess in bottom of receiver. This special care will prevent any damage to stock when stock is tightened against receiver. Note: Reassemble BDL grade trigger guard assembly (includes floor plate, guard, magazine follower and spring) to stock before placing stock over assembled magazine.

**TO DISASSEMBLE BOLT PARTS** — Remove bolt and insert coin or similar piece in slot at rear of firing pin head (Fig. 3). Hold bolt handle and turn bolt plug until firing pin assembly can be unscrewed and removed from bolt assembly. Reassemble in reverse order.

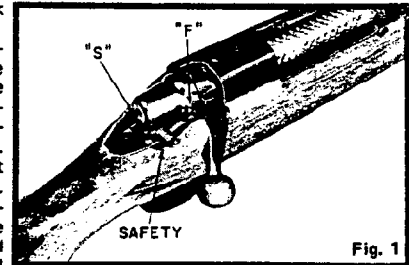

Fig. 1

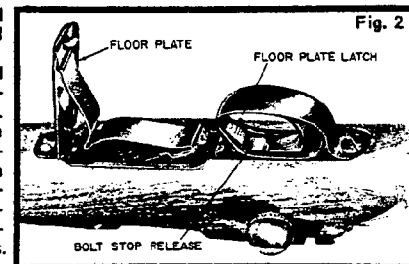
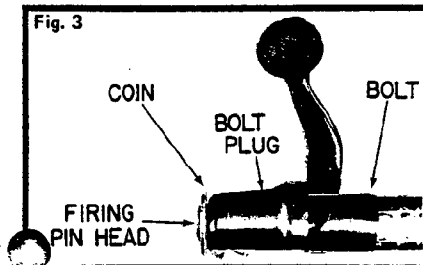

Fig. 2

Fig. 3



**TRIGGER** — No adjustment of trigger by the owner is recommended. Trigger pull has been factory adjusted. Should any adjustment be necessary return rifle to factory or see a Remington approved gunsmith.

**LUBRICATION** — Your Remington Model 700 will remain clean longer if little or no oil is used on parts of action. Lubricate cam surfaces on bolt to prevent wear. Wash action and bolt parts with a good grade of petroleum solvent, dry and re-oil very lightly. After handling, wipe barrel, receiver and all steel parts to prevent rusting. Invisible "prints" of moisture can cause rust unless removed. After using in wet weather dry and wipe steel parts with oil to prevent rusting. Abrupt changes in temperature can cause condensation and wetness. Therefore, special care is needed to interior steel parts to prevent rust. When shooting in freezing weather, remove excess oil for best results. Use dry graphite if necessary to lubricate metal parts.

**SIGHT ADJUSTMENT** — Factory sights on Remington high power rifles are targeted at 100 yds and carefully adjusted at factory for average shooters. If your rifle does not appear to shoot accurately it does not necessarily mean that sights are improperly aligned. Individual differences in eyesight or method of shooting may require sight re-alignment. Make sure that adjustable dovetail front sight (where supplied) is centered on barrel. Before attempting to re-align sights it should be realized that the greater the group size the more difficult it becomes to determine where rifle is shooting (center of impact). A consistent method of holding rifle, aiming and squeezing trigger will aid in obtaining a small group size. Different sight settings are required for each cartridge type, bullet type and weight, barrel length, each range and wind condition and, most likely, each individual shooter. To test rifle for accuracy place large target in safe area at desired range. (Before testing at a longer range it is advisable to fire a few rounds at 50 yards. At this range, bullets will generally hit somewhere on target). Shoot from a prone or sitting position giving body and elbows solid support. Fire four or five shots per group, using ammunition with which you plan to hunt. Shoot carefully and deliberately. If groups are at desired point, sights are correctly adjusted. If not, you should adjust sights. If shots are too high, loosen elevation screw and lower rear sight. If shots are too low, rear sight should be raised. If rifle shoots left, loosen windage screw and move rear sight aperture to right.

Should rifle shoot to right, move aperture to left. Always move rear sight in direction you want rifle to shoot. Information about trajectory or ballistics of your favorite load may be found in the Remington Firearms and Ammunition catalog. A free copy may be obtained from Remington dealers or by writing to Remington Arms Co., Inc. 939 Barnum Ave., Bridgeport, Conn. 06600.

**TELESCOPE OR RECEIVER SIGHTS**—The all-purpose stock on the Remington 700 is adapted for use with telescope or receiver sights as well as gun factory sights. The receiver is drilled and tapped for telescope and receiver sights. The location and design of the rear sight holes are standard for most target telescope mounts. If rear sight is removed for receiver sighting clearance, the rear sight barrel screw holes may be filled with the receiver plug screws. Front sight ramp may also be removed and receiver plug screws used at muzzle.

**SLING STRAP** — A sling strap complete with mountings is packaged with each BDL Grade rifle. When attaching to rifle—assemble both quick detachable (Q. D.) swivel assemblies to stock. To do this, push plunger on swivel until small plate lifts and can be swung free of attaching stud on swivel. Then insert attaching stud into eye of stock screw. Close plate on swivel to lock swivel to stock screw. To attach strap to swivels—insert tongue of strap into rear swivel. Loop strap back and thru attached keeper band. Insert strap into and thru buckle and front swivel. Loop back and secure with brass fastener. Adjust strap to desired position. To remove strap from rifle, simply snap quick detachable swivels from stock screws and remove strap.

**IMPORTANT** — Remington firearms are designed, manufactured and proof tested to standards based on factory loaded ammunition. Improperly loaded handloads can be dangerous. Remington Arms Company, Inc. cannot assume responsibility for damages or injury caused by handloads or reloaded ammunition.

This gun has been manufactured to Remington specifications and shipped from the factory suitable for use. Remington does not recommend and is not responsible for any alteration or modification to the gun not made by Remington factory personnel, nor the replacement of worn or damaged parts with those not of Remington manufacture.

**SHOOTING GLASSES.** Smart shooters, who don't normally wear corrective lenses, always hunt and shoot wearing good, impact-resistant shooting glasses in order to protect their eyes against unanticipated ricochet, possible powder blowback, or branch and twig whiplash. In addition to eye safety, green or gray glasses keep the eyes fresh and untired on bright, glary days, while yellow lenses aid in spotting game in dim or fading light. So for safety, comfort and better shooting — both in the field and on the target range — shooting glasses are a real "must".

**EAR PROTECTION** — Proper ear protection in the form of ear plugs or hearing guards should be utilized whenever practical.

**MODEL  
700**

**BOLT ACTION  
HIGH POWER RIFLE**

**PARTS LIST**

NOTE: Prices for barrels and bolts will be quoted upon application. Factory assembly required.

SEE INSTRUCTIONS FOR ORDERING PARTS

| View No.  | Part No. | NAME OF PART                     | List Price | View No. | Part No. | NAME OF PART                                | List Price |
|---|----------|----------------------------------|------------|----------|----------|---|------------|
| NOTE: Basic 30-06 Caliber listed below. See Exploded View for proper identity of parts. See added page for other caliber part listings. |          |                                  |            | 48       | 17043    | Safety Pivot Pin                            | \$ .50     |
| 1   |          | Barrel Assembly                  |            | 49       | 17044    | Safety Snap Washer                          | .40        |
| 2   |          | Bolt Assembly                    |            | 50       | 15666    | Sear Safety Cam                             | 1.40       |
|   |          | Bolt Final Assembly              |            | 51       | 24476    | Sear Pin                                    | .40        |
| 3   | 17012    | Bolt Plug                        | \$ 4.35    | 52       | 17047    | Sear Spring                                 | .40        |
| 4   | 17013    | Bolt Stop                        | 1.05       | 53       | 30855    | Sling Strap Assembly, BDL Grade             | 5.95       |
| 5   | 24475    | Bolt Stop Pin                    | .40        |          | 26990    | Sling Strap Assembly and Mountings Complete | 14.00      |
| 6   | 15478    | Bolt Stop Release                | .50        | 54       | 33366    | Stock Assembly, ADL Grade                   | 80.00      |
| 7   | 15224    | Bolt Stop Spring                 | .60        |          | 33371    | Stock Assembly, BDL Grade                   | 97.00      |
| 8   | 90953    | Butt Plate                       | .75        |          | 18186    | Stock Reinforcing Screw (not shown)         | .60        |
| 8a  | 90954    | Butt Plate Spacer BDL Grade      | .50        |          | 16970    | Stock Reinforcing Screw Dowel (not shown)   | .40        |
| 9   | 25380    | Butt Plate Screw                 | .40        | 55       | 26555    | Swivel Assembly, BDL Grade (Q.D.)           | 3.60       |
| 10  | 15287    | Center Guard Screw, ADL Grade    | .40        | 56       | 15280    | Trigger                                     | 1.95       |
| 11  | 17017    | Ejector                          | 1.50       | 57       | 17053    | Trigger Adjusting Screw                     | .50        |
| 12  | 17676    | Ejector Pin                      | .40        |          | 26345    | Trigger Assembly                            | 16.70      |
| 13  | 17019    | Ejector Spring                   | .40        | 58       | 19461    | Trigger Connector                           | 1.00       |
| 14  | 14669    | Extractor                        | 2.35       | 59       | 91128    | Trigger Engagement Screw                    | .40        |
| 15  | 27340    | Extractor Rivet                  | .50        | 60       | 15281    | Trigger Guard                               | 5.65       |
|   | 15376    | Fastener, Sling Strap            | .50        | 61       | 26371    | Trigger Guard Assembly, BDL Grade           | 15.55      |
| 16  | 22020    | Firing Pin                       |            | 62       | 26655    | Trigger Housing Assembly                    | 8.35       |
| 17  | 22040    | Firing Pin Assembly              | 13.85      | 63       | 24477    | Trigger Pin                                 | .40        |
| 18  | 17022    | Firing Pin Cross Pin             | .40        | 64       | 15400    | Trigger Spring                              | .40        |
| 20  | 15291    | F Plate Latch, BDL Grade         | 1.10       | 65       | 15481    | Trigger Stop Screw                          | .40        |
| 21  | 16451    | Floor Plate Latch Pin, BDL Grade | .40        |          |          |   |            |

|    |       |  |      |
|----|-------|--|------|
| 22 | 16452 | Floor Plate Latch Spring, BDL Grade    | .60  |
| 23 | 16453 | Floor Plate Pivot Pin, BDL Grade       | .50  |
| 24 | 22035 | Floor Guard Screw                      | .50  |
| 25 | 15161 | Front Guard Screw Bushing, ADL Grade   | .70  |
| 26 | 15373 | Front Sight                            | 1.65 |
|    | 15719 | Front Sight (Low)                      | 1.65 |
| 27 | 28510 | Front Sight Ramp                       | 2.80 |
|    | 15635 | Front Sight Ramp, BDL Grade            | 3.20 |
| 28 | 28505 | Front Sight Ramp Screw                 | .40  |
| 29 | 15363 | Front Sight Hood, BDL Grade            | 1.20 |
| 30 | 15357 | Front Swivel Nut, BDL Grade            | .50  |
| 31 | 34096 | Front Swivel Screw, BDL Grade          | .80  |
|    | 90957 | Grip Cap, BDL Grade (not shown)        | .60  |
|    | 25380 | Grip Cap Screw                         | .35  |
|    | 90958 | Grip Cap Spacer, BDL Grade (not shown) | .50  |
| 32 | 15284 | Magazine, ADL Grade                    | 1.95 |
|    | 16430 | Magazine, BDL Grade (not shown)        | 1.95 |
| 33 | 90952 | Magazine Follower (ADL Grade)          | 5.50 |
|    | 15940 | Magazine Tab Screw (ADL Grade)         | .40  |
| 34 | 17028 | Magazine Spring                        | 1.65 |
|    | 15677 | Magazine Spring, BDL Grade             | 1.65 |
| 35 | 17029 | Main Spring                            | .75  |
| 36 | 26355 | Rear Guard Screw                       | .50  |
| 37 | 32510 | Rear Sight Aperture                    | 1.95 |
| 38 | 32500 | Rear Sight Base                        | 2.65 |
| 39 | 28505 | Rear Sight Base Screw (2)              | .40  |
| 40 | 90905 | Rear Sight Slide                       | 4.00 |
| 41 | 90906 | Elevation Screw                        | .40  |
| 42 | 90904 | Windage Screw                          | .40  |
| 43 | 15358 | Rear Swivel Screw, BDL Grade           | .90  |
| 44 | 17034 | Receiver Plug Screw                    | .40  |
| 45 | 26585 | Safety Assembly                        | 1.70 |
| 46 | 23222 | Safety Detent Ball                     | .40  |
| 47 | 15368 | Safety Detent Spring                   | .70  |

#### ADDITIONAL CALIBERS

See 30-06 list for parts not below

|                 |   |
|-----------------|---|
| Barrel Assembly |   |
| 15709           | Extractor, 7mm Rem., Mag., 264-300 Win. Mag. 8mm Rem. Mag. \$ 2.35                                |
| 15850           | Extractor, 222-223 Rem., 17 Rem. 2.35   |
| 27341           | Extractor Rivet, 7mm Rem. Mag., 264-300 Win. Mag., 8mm Rem. Mag. .50                              |
| 27342           | Extractor Rivet, 222 Rem., 223 Rem., 17 Rem. .50  |
| 22021           | Firing Pin, 222 Rem., 243-308 Win., 6mm Rem. Mag., 22-250 Rem., 223 Rem., 17 Rem.                 |
| 22041           | Firing Pin Assembly, 222 Rem., 17 Rem., 243 Win., 308 Win., 6mm Rem., 22-250 Rem., 223 Rem. 13.85 |
| 22037           | Front Guard Screw, 222 Rem., 223 Rem., 243 & 308 Win., 6mm Rem., 22-250 Rem., 17 Rem. .40         |
| 16204           | Front Scope Base, Varmint 3.45  |
| 14659           | Front Sight, 7mm Rem. Mag., 264 Win. Mag. 1.65  |
| 28511           | Front Sight Ramp, ADL Grade 2.80  |
| 15992           | Front Sight Ramp, BDL Grade 3.20  |
| 15282           | Magazine, ADL Grade, 222 Rem. 1.95  |
| 16716           | Magazine, BDL Grade, 222 Rem., 223 Rem., 17 Rem. 1.95   |
| 15283           | Magazine, ADL Grade, 243 & 308 Win., 6mm Rem. 22-250 Rem. 1.95                                    |
| 16715           | Magazine, BDL Grade, 243 & 308 Win., 6mm Rem. 22-250 Rem. 1.95                                    |
| 90951           | Magazine Follower, 222 Rem. 5.50  |
| 90982           | Magazine Follower, 243 & 308 Win., 6mm Rem. 22-250 Rem. 5.50                                      |
| 90951           | Magazine Follower, 223, 17 Rem. 5.50  |
| 91017           | Magazine Follower, 270, 25-06, 30-06 (BDL Grade) 5.50   |
| 90952           | Magazine Follower, 8mm Rem. Mag. 5.50   |

See added page for other caliber listings.

DELIVERIES ARE F.O.B. ILION, N. Y.

PARTS AND PRICES SUBJECT TO CHANGE WITHOUT NOTICE

# **ADDITIONAL CALIBERS**

# **MODEL 700 BOLT ACTION HIGH POWER RIFLE**

# **PARTS LIST**

NOTE: Prices for barrels and bolts will be quoted upon application. Factory assembly required.

SEE INSTRUCTIONS FOR ORDERING PARTS

| Part No. | NAME OF PART  | List Price | Part No. | NAME OF PART   | List Price |
|----------|---|------------|----------|--|------------|
| 15286    | Magazine Spacer 222 Rem. BDL Grade-----                                     | \$ .70     | 33380    | Stock Assembly, 7mm Rem. Mag., ADL Grade-----  | \$ 97.00   |
| 15742    | Magazine Spacer, 222 Rem. ADL Grade-----                                    | .70        | 33365    | Stock Assembly, 222 Rem., 243 Win., 308 Win.,<br>6mm Rem., 22-250 Rem., ADL Grade-----                               | 80.00      |
| 15286    | Magazine Spacer, 223 Rem., BDL Grade, 17 Rem.-----                          | .70        | 33385    | Stock Assembly, 7mm Rem. Mag., 264-300 Win.<br>Mag., BDL Grade., 8mm Rem. Mag.-----                                  | 114.00     |
| 91133    | Magazine Spring, 222 Rem. 223 Rem. 17 Rem.-----                             | 1.65       | 33370    | Stock Assembly, 222 Rem., 243 Win., 308 Win.<br>6mm Rem., 22-250 Rem., BDL Grade, 17 Rem.-----                       | 97.00      |
| 17891    | Magazine Spring, 243 & 308 Win., 6mm Rem.-----                              | 1.65       | 33376    | Stock Assembly, Varmint, BDL Grade, 222 Rem.,<br>223 Rem., 243 Win., 6mm Rem., 22-250 Rem.-----                      | 97.00      |
| 15698    | Magazine Spring, 22-250 Rem.-----   | 1.65       | 33375    | Stock Assembly, Varmint, BDL Grade, 25-06-----   | 97.00      |
| 15699    | Magazine Spring, 22-250 Rem., 6mm Rem., 243<br>Win., BDL Grade-----         | 1.65       | 26370    | Trigger Guard Assembly, BDL Grade, 222 Rem.,<br>17 Rem., 223 Rem., 243 Win., 308 Win., 6mm<br>Rem., 22-250 Rem.----- | 15.55      |
| 17058    | Main Spring, 222 Rem., 223 Rem., 243 Win., 308<br>Win., 17 Rem.-----        | .75        |          |  |            |
| 18843    | Rear Scope Base, Varmint-----   | 3.70       |          |  |            |
| 90949    | Recoil Pad, 7mm Rem. Mag., 264 & 300 Win.<br>Mag., 8mm Rem. Mag.-----       | 6.00       |          |  |            |
| 25410    | Recoil Pad Screw, 7mm Rem. Mag., 264 & 300<br>Win. Mag., 8mm Rem. Mag.----- | .40        |          |  |            |
| 18842    | Scope Base Screw, Rear Varmint-----   | .40        |          |  |            |
| 16205    | Scope Base Screw, Front Varmint-----  | .50        |          |  |            |

PARTS AND PRICES SUBJECT TO CHANGE WITHOUT NOTICE

DELIVERIES ARE F.O.B. ILION, N. Y.

# **MODEL 700 BOLT ACTION HIGH POWER RIFLE**

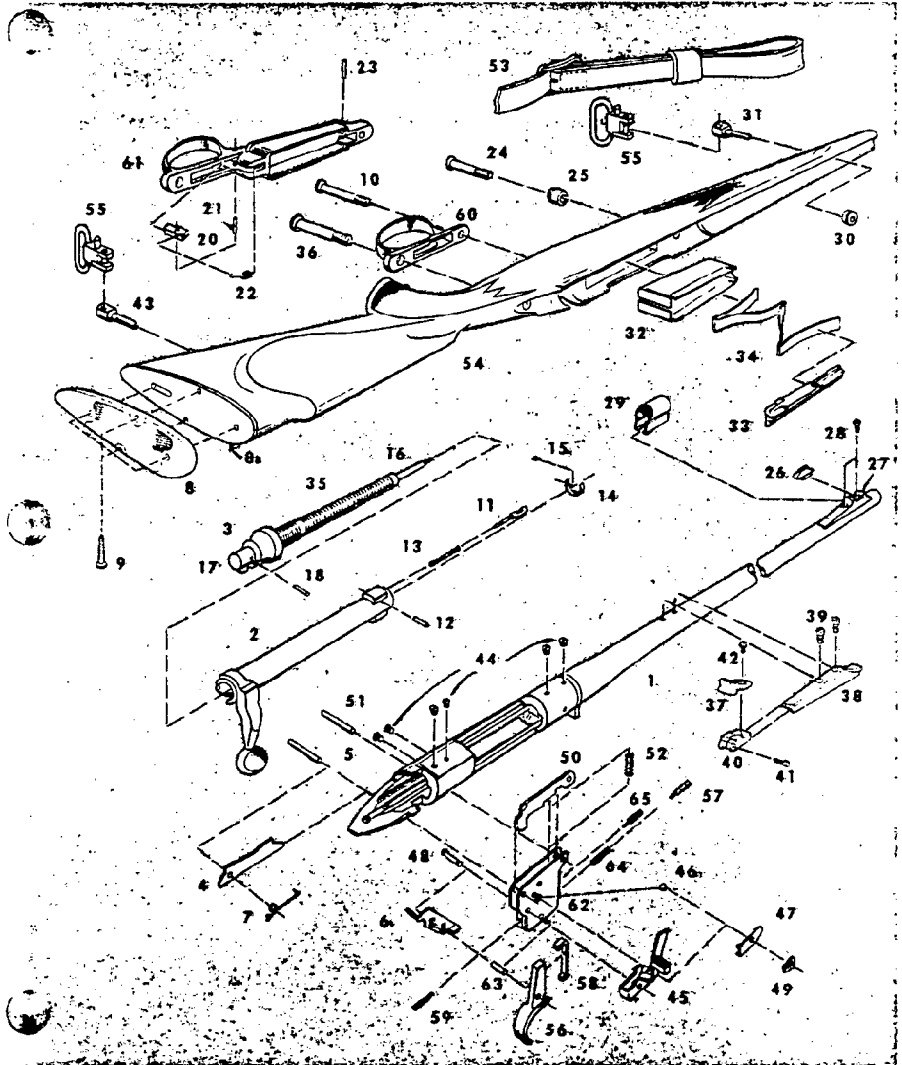

Send all guns for factory service and inquiries on service and parts to  
**REMINGTON ARMS COMPANY, INC.**  
 Arms Service Division  
 Ilion, New York 13357

All other inquiries are to be addressed to  
**REMINGTON ARMS COMPANY, INC.**  
 Bridgeport, Connecticut 06602

## INSTRUCTIONS FOR ORDERING PARTS

### (PLEASE READ CAREFULLY)

Please give model number, part number and name. Give serial number and state caliber or gauge and choke. Identify parts from list, picture or exploded view. List interchangeable shotgun barrels on separate order form to speed shipment.

Cover only one subject in letter or order. Do not order parts and give repair instructions in same letter.

Please do not ship sample parts if they may be identified otherwise. See shipping instructions below.

The sale of center fire rifle barrels, bolts and receivers is restricted. Special tools and gauges are required for assembly.

Parts will be supplied for discontinued models if available. Parts cannot be supplied nor guns repaired if not listed in complete line parts list. Parts, being made to close dimensions, may require slight adjustment or fitting to assure proper function of arm.

**IMPORTANT:** Do not combine Part Or with Gun Service Orders. Please send Part orders direct to:

**REMINGTON ARMS COMPANY, INC.**  
**PARTS DEPT.**  
**ARMS SERVICE DIVISION**  
**Ilion, New York 13357**

## INSTRUCTIONS FOR FACTORY SERVICE

### (PLEASE READ CAREFULLY)

Please package carefully. Use plenty of cushioning material to prevent movement of gun or parts in package. Please do not ship gun in a gun case, or special container that must be returned. Return of gun or parts will be speeded if properly packaged in a throw-away carton. Clearly mark forwarding and return address on gun package as well as on attached letter.

Securely attach complete letter of information on outside of each package returned to factory for repairs. Please do not return gun accessories such as sling straps, quick release swivels, special boots, covers, telescopes, mounts or any special equipment to factory with gun shipment. Give full details of contents. State if complete gun or part. List model number, part number and name, serial number and caliber or gauge. Give full condition of contents — any parts missing or damaged, etc. This will enable us to accurately list needed repairs.

Do not order parts and give repair instructions in same letter. To avoid delay in starting work, please include in first order or letter the trouble to be corrected, changes desired or parts to be replaced. If an estimate is required please advise. Otherwise work will proceed and a statement of cost will be sent. This will speed service.

**MAINTENANCE** — Rifle should be checked periodically by a competent gunsmith to ensure proper inspection and any necessary replacement of worn or damaged parts.

For instructions on how to dress, ship and deliciously cook wild game, send for the Remington "Wild Game" Cookbook \$3.95—Remington Sportsmen's Library, P.O. Box 432, Bridgeport, Connecticut 06601.

Unless specified otherwise, shipments will be made by way of Parcel Post on small packages, Express on larger packages. Remington gun parts are not interchangeable with those of any other make. For this reason the Remington Arms Company, Inc., cannot service any gun not of its manufacture.

Repairs will be made on discontinued models as long as supply of parts is available. However repairs cannot be made for models which not listed in Complete Line Parts Lists.

**IMPORTANT: IT IS A FEDERAL OFFENSE TO SHIP FIREARMS AND AMMUNITION TOGETHER. BEFORE PACKAGING FIREARMS FOR RETURN TO FACTORY, ALL LIVE AMMUNITION SHOULD BE REMOVED.**

If live ammunition is included in package, shipment cannot be made by Insured Mail. All other shipments may be made by Insured Mail. Please send repairs direct to:

**REMINGTON ARMS COMPANY, INC.**  
**ARMS SERVICE DIVISION**  
**Ilion, New York 13357**

Printed in U.S.A.

Form RD 5461  
Rev. 378