

GUN OWNER'S GUIDE

Remington

Model **700**



Bolt Action

Center Fire Rifle

INCLUDES VARMINT MODEL

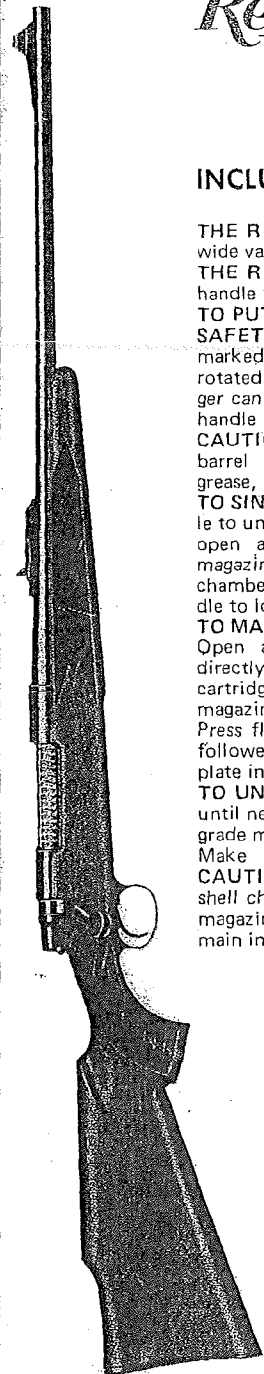

THE REMINGTON MODEL 700 is a high quality bolt action repeater available in a wide variety of center fire calibers. Two grades are supplied—ADL (standard) and BDL. THE REMINGTON MODEL 700 Varmint is a BDL grade rifle expressly designed to handle the high velocity "Varmint" calibers.

TO PUT BOLT IN RIFLE—Align bolt lugs to receiver and slide cocked bolt into rifle. **SAFETY (Fig. 1)** To engage safety to ON SAFE position, rotate to rear stop position marked "S" on receiver. Bolt handle will be locked down and rifle will not fire. When rotated forward to fire position, marked "F" on receiver, safety will disengage. Trigger can be pulled to fire rifle or bolt handle raised to open action.

CAUTION: Before firing make sure barrel is clean, free of heavy oil, grease, or any obstruction.

TO SINGLE LOAD—Raise bolt handle to unlock bolt and pull rearward to open action. Place cartridge upon magazine follower or directly into chamber. Close bolt. Lower bolt handle to lock action.

TO MAGAZINE LOAD (ADL Grade)

Open action and load cartridges directly into magazine. BDL Grade cartridges load in same manner as in ADL Grade or may be loaded through bottom of magazine (with bolt closed). Put safety ON SAFE and turn rifle bottom upward. Press floor plate latch to release floor plate (Fig. 2). Lift floor plate (with attached follower and spring) and load cartridges into magazine opening. Close and snap floor plate into position.

TO UNLOAD—Pull bolt rearward and remove cartridge from rifle. Push bolt forward until next cartridge is released from magazine. Continue until magazine is empty. BDL grade magazine may be unloaded from bottom with bolt closed and safety ON SAFE. Make certain to empty chamber.

CAUTION: Open action and check shell chamber in breech of barrel and magazine to make sure no rounds remain in rifle.

TO REMOVE BOLT—Press upward on bolt stop release (Fig. 2) and pull bolt from rifle.

BARREL CARE—Use lightly oiled patch, cleaning from breech to muzzle. Remove bolt to make cleaning easier. Scrub bore with cleaning solvent if necessary.

To insure maximum accuracy, wire brush cleaning of barrel bores in all varmint calibers is recommended after each 25 rounds.

ACTION CARE AND DISASSEMBLY—Remove bolt and stock if necessary to clean action or replace parts. Unscrew guard screws and lift stock away from action and barrel. Clean bolt and action in solvent and wipe clean. Before re-assembling stock to receiver, particularly on ADL Grade, locate magazine fully into magazine recess in bottom of receiver. This special care will prevent any damage to stock when stock is tightened against receiver. Note: Re-assemble BDL grade trigger guard assembly (includes floor plate, guard, magazine follower and spring) to stock before placing stock over assembled magazine.

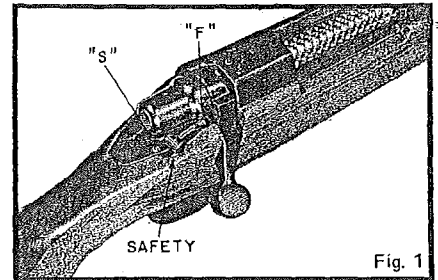

Fig. 1

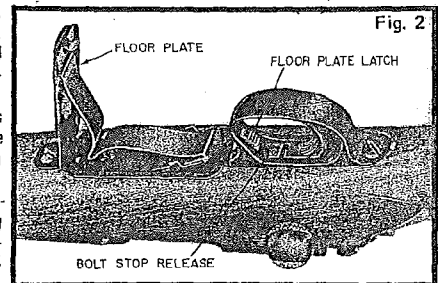
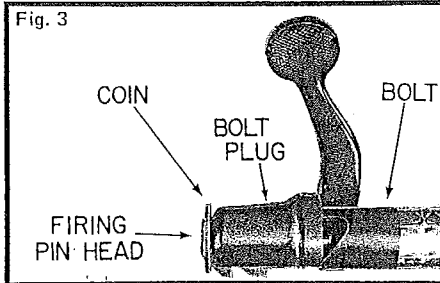

Fig. 2

1972

TO DISASSEMBLE BOLT PARTS—Remove bolt and insert coin or similar piece in slot at rear of firing pin head (Fig. 3). Hold bolt handle and turn bolt plug until firing pin assembly can be unscrewed and removed from bolt assembly. Reassemble in reverse order.



TO ADJUST TRIGGER (Fig. 4) — Remove trigger guard and stock. Cock bolt in receiver. Pull of Trigger is adjusted to desired weight by turning trigger adjusting screw clockwise for a heavier weight adjustment and counter-clockwise for a lighter weight adjustment. Adjustment of trigger adjusting screw to provide a weight pull of less than 3 pounds is not recommended. Overtravel of trigger may be reduced by turning trigger stop screw clockwise until firing pin will not fall when trigger is pulled. Then, while keeping pressure on trigger, back off trigger stop screw, counter-clockwise, until firing pin falls. Continue back off about 1/16 turn. This method of adjusting will allow least amount of trigger overtravel.

IMPORTANT: The trigger engagement screw (Fig. 4) has been factory adjusted and sealed to provide the correct amount of trigger connector supporting surface beneath sear.

LUBRICATION—Your Remington Model 700 will remain clean longer if little or no oil is used on parts of action. Lubricate cam surfaces on bolt to prevent wear. Wash action and bolt parts with a good grade of petroleum solvent, dry and re-oil very lightly. After handling, wipe barrel, receiver and all steel parts to prevent rusting. Invisible "prints" of moisture can cause rust unless removed. After using in wet weather dry and wipe steel parts with oil to prevent rusting. Abrupt changes in temperature can cause condensation and wetness. Therefore, special care is needed to interior steel parts to prevent rust. When shooting in freezing weather, remove excess oil for best results. Use dry graphite if necessary to lubricate metal parts.

SIGHT ADJUSTMENT — Factory sights on Remington high power rifles are targeted at 100 yards and carefully adjusted at factory for average shooters. If your rifle does not appear to shoot accurately it does not necessarily mean that sights are improperly aligned. Individual differences in eyesight or method of shooting may require sight re-alignment. Make sure that adjustable dovetail front sight (where supplied) is centered on barrel. Before attempting to re-align sights it should be realized that the greater the group size the more difficult it becomes to determine where rifle is shooting (center of impact). A consistent method of holding rifle, aiming and squeezing trigger will aid in obtaining a small group size. Different sight settings are required for each cartridge type, bullet type and

weight, barrel length, each range and wind condition and, most likely, each individual shooter. To test rifle for accuracy place large target in safe area at desired range. (Before testing at a longer range it is advisable to fire a few rounds at 50 yards. At this range, bullets will generally hit somewhere on target). Shoot from a prone or sitting position giving body and elbows solid support. Fire four or five shots per group, using ammunition with which you plan to hunt. Shoot carefully and deliberately. If groups are at desired point, sights are correctly adjusted. If not, you should adjust sights. If shots are too high, lower rear sight. If shots are too low, rear sight should be raised. If rifle shoots left, rear sight should be moved right by turning windage screw counter clockwise. Should rifle shoot to right, move rear sight to left, turning screw clockwise. Always move rear sight in direction you want rifle to shoot. Information about trajectory or ballistics of your favorite load may be found in the Remington Firearms and Ammunition Catalog. A free copy may be obtained from Remington dealers or by writing to Remington Arms Co., Inc. 939 Barnum Ave., Bridgeport, Conn. 06600.

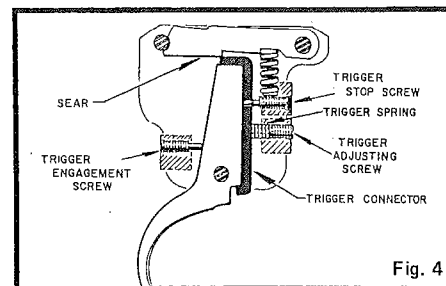

TELESCOPE OR RECEIVER SIGHTS—The all-purpose stock on the Remington 700 is adapted for use with telescope or receiver sights as well as gun factory sights. The receiver is drilled and tapped for telescope and receiver sights. The location and design of the rear sight holes are standard for most target telescope mounts. If rear sight is removed for receiver sighting clearance, the rear sight barrel screw holes may be filled with the receiver plug screws. Front sight ramp may also be removed and receiver plug screws used at muzzle.

SLING STRAP—A sling strap complete with mountings is packaged with each BDL Grade rifle. When attaching to rifle—assemble both quick detachable (Q.D.) swivel assemblies to stock. To do this, push plunger on swivel until small plate lifts and can be swung free of attaching stud on swivel. Then insert attaching stud into eye of stock screw. Close plate on swivel to lock swivel to stock screw. To attach strap to swivels—insert tongue of strap into rear swivel. Loop strap back and thru attached keeper band. Insert strap into and thru buckle and front swivel. Loop back and secure with brass fastener. Adjust strap to desired position. To remove strap from rifle, simply snap quick detachable swivels from stock screws and remove strap.

MODEL 700 BOLT ACTION HIGH POWER RIFLE

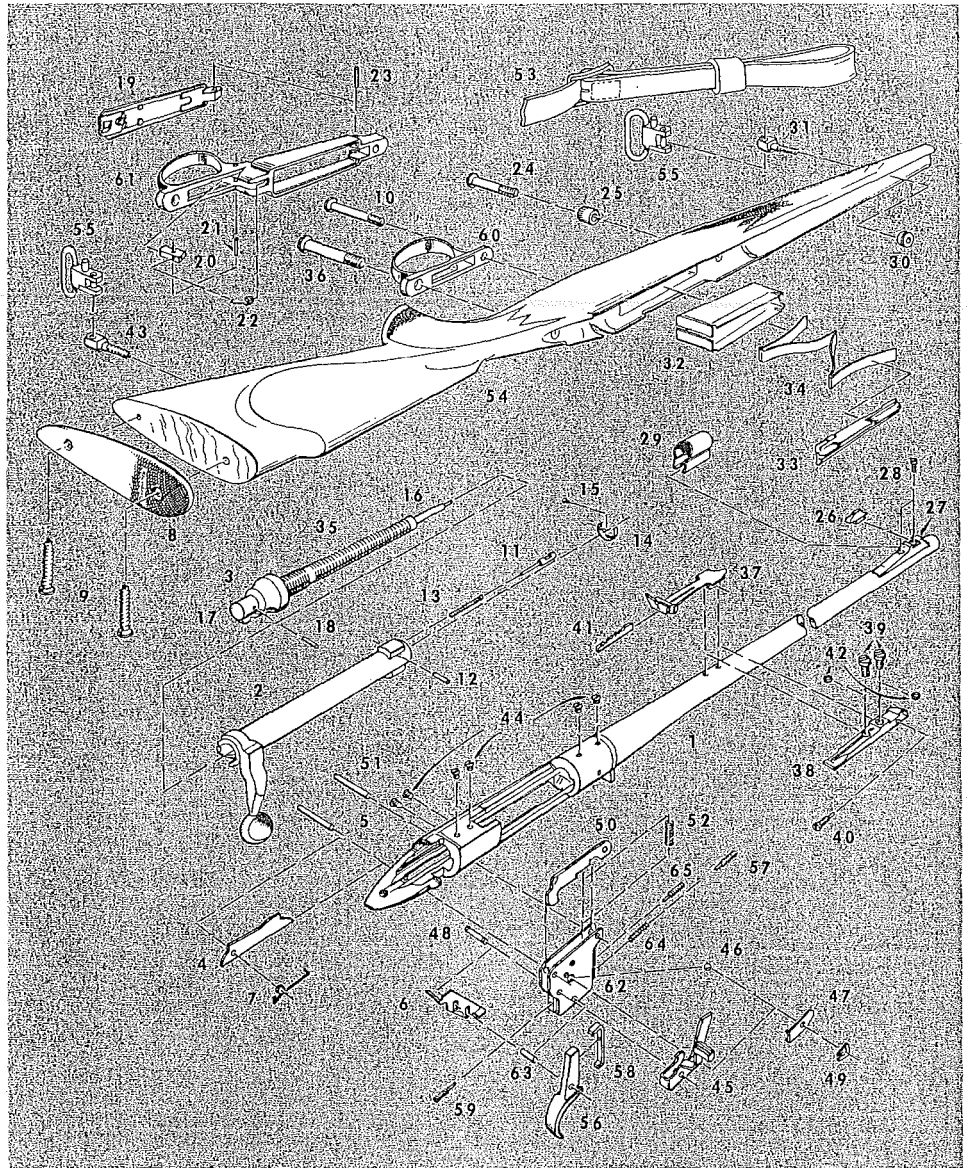

Send all guns for factory service and inquiries on service and parts to
REMINGTON ARMS COMPANY, INC.
 Arms Service Division
 Ilion, New York 13357

All other inquiries are to be addressed to
REMINGTON ARMS COMPANY, INC.
 Bridgeport, Connecticut 06602

MODEL 700

BOLT ACTION HIGH POWER RIFLE

PARTS LIST

NOTE: Prices for barrels and bolts will be quoted upon application. Factory assembly required.

SEE INSTRUCTIONS FOR ORDERING PARTS

View No.	Part No.	NAME OF PART	List Price	View No.	Part No.	NAME OF PART	List Price
NOTE: Basic 30-06 Caliber listed below. See Exploded View for proper identity of parts. See added page for other caliber part listings.				48	17043	Safety Pivot Pin	\$.30
1		Barrel Assembly		49	17044	Safety Snap Washer	.30
2		Bolt Assembly		50	15666	Sear Safety Cam	.75
		Bolt Final Assembly		51	24476	Sear Pin	.30
3	17012	Bolt Plug	\$ 2.20	52	17047	Sear Spring	.30
4	17013	Bolt Stop	.75	53	30855	Sling Strap Assembly, BDL Grade	3.45
5	24475	Bolt Stop Pin	.30		26990	Sling Strap Assembly and Mountings Complete	9.10
6	15478	Bolt Stop Release	.30	54	26381	Stock Assembly, ADL Grade	46.20
7	15224	Bolt Stop Spring	.40		26401	Stock Assembly, BDL Grade	53.05
8	14472	Butt Plate	.40		18186	Stock Reinforcing Screw (not shown)	.40
9	25410	Butt Plate Screw	.30		16970	Stock Reinforcing Screw Dowel (not shown)	.30
10	15287	Center Guard Screw, ADL Grade	.30	55	26555	Swivel Assembly, BDL Grade (O. D.)	2.10
11	17017	Ejector	1.10	56	15280	Trigger	1.10
12	17676	Ejector Pin	.30	57	17053	Trigger Adjusting Screw	.30
13	17019	Ejector Spring	.30		26345	Trigger Assembly	12.60
14	14669	Extractor	1.65	58	19461	Trigger Connector	.55
15	27340	Extractor Rivet	.30	59	17053	Trigger Engagement Screw	.30
	15376	Fastener, Sling Strap	.25	60	15281	Trigger Guard	3.25
16	22020	Firing Pin	3.25	61	26376	Trigger Guard, BDL Grade	7.20
17	22040	Firing Pin Assembly	9.00		26371	Trigger Guard Assembly, BDL Grade	9.00
18	17022	Firing Pin Cross Pin	.30	62	26655	Trigger Housing Assembly	6.30
19	19800	Floor Plate, BDL Grade	2.55	63	24477	Trigger Pin	.30
20	15291	Floor Plate Latch, BDL Grade	.75	64	15400	Trigger Spring	.30

21	16451	Floor Plate Latch Pin, BDL Grade	.30
22	16452	Floor Plate Latch Spring, BDL Grade	.40
23	16453	Floor Plate Pivot Pin, BDL Grade	.40
24	22035	Front Guard Screw	.30
25	15161	Front Guard Screw Bushing, ADL Grade	.40
26	15373	Front Sight	1.10
	15719	Front Sight (Low)	1.10
27	28510	Front Sight Ramp	1.80
	15635	Front Sight Ramp, BDL Grade	1.80
28	28505	Front Sight Ramp Screw	.30
29	15363	Front Sight Hood, BDL Grade	.75
30	15357	Front Swivel Nut, BDL Grade	.25
31	15356	Front Swivel Screw, BDL Grade	.60
	15331	Grip Cap, BDL Grade (not shown)	.40
	30505	Grip Cap Spacer, BDL Grade (not shown)	.30
32	15284	Magazine, ADL Grade	1.00
	16430	Magazine, BDL Grade (not shown)	1.00
33	17024	Magazine Follower	.75
	15752	Magazine Follower, BDL Grade	.75
	15940	Magazine Tab Screw (ADL Grade)	.30
34	17028	Magazine Spring	1.00
	15677	Magazine Spring, BDL Grade	1.00
35	17029	Main Spring	.55
36	26355	Rear Guard Screw	.30
37	24525	Rear Sight Assembly	4.00
38	16454	Rear Sight Base	1.10
39	16023	Rear Sight Base Screw	.30
40	16456	Rear Sight Screw	.30
41	28095	Rear Sight Step (Selected Sizes)	.30
42	16968	Rear Sight Washer	.30
43	15358	Rear Swivel Screw, BDL Grade	.60
44	17034	Receiver Plug Screw	.30
45	26585	Safety Assembly	1.25
46	23222	Safety Detent Ball	.30
47	15368	Safety Detent Spring	.30

ADDITIONAL CALIBERS

See 30-06 list for parts not listed below

15852	Ejector, 222-223 Rem., 223 Rem. Mag., 17 Rem.	1.10
15709	Extractor, 7mm Rem. Mag., 264-300 Win. Mag., 6.5mm Rem. Mag., 350 Rem. Mag.	1.65
15850	Extractor, 222-223 Rem., 17 Rem.	1.65
27341	Extractor Rivet, 7mm Rem. Mag., 264-300 Win. Mag., 6.5mm Rem. Mag., 350 Rem. Mag.	.30
27342	Extractor Rivet, 222 Rem., 223 Rem., 17 Rem.	.30
22021	Firing Pin, 222 Rem., 243-308 Win., 6mm Rem. Mag., 22-250 Rem., 6.5mm Rem. Mag., 350 Rem. Mag., 223 Rem., 17 Rem.	3.60
22041	Firing Pin Assembly, 222 Rem., 17 Rem., 243 Win., 308 Win., 6mm Rem., 22-250 Rem., 6.5mm Rem. Mag., 350 Rem. Mag., 223 Rem.	9.00
16434	Floor Plate, BDL Grade, 222 Rem., 223 Rem., 243 & 308 Win., 6mm Rem., 22-250 Rem., 17 Rem.	2.55
22037	Front Guard Screw, 222 Rem., 223 Rem., 243 & 308 Win., 6mm Rem., 22-250 Rem., 17 Rem.	.30
16204	Front Scope Base, Varmint	3.00
14659	Front Sight, 7mm Rem. Mag., 264 Win. Mag.	1.10
28511	Front Sight Ramp, ADL Grade	1.80
15992	Front Sight Ramp, BDL Grade	1.80
15282	Magazine, ADL Grade, 222 Rem.	1.00
16716	Magazine, BDL Grade, 222 Rem., 223 Rem., 17 Rem.	1.10
15283	Magazine, ADL Grade, 243 & 308 Win., 6mm Rem., 22-250 Rem.	1.00
16715	Magazine, BDL Grade, 243 & 308 Win., 6mm Rem., 22-250 Rem.	1.00
14756	Magazine, BDL Grade, 6.5mm Rem. Mag., 350 Rem. Mag.	1.00
17975	Magazine Follower, 222 Rem.	.75
17056	Magazine Follower, 243 & 308 Win., 6mm Rem., 22-250 Rem., 6.5mm Rem. Mag., 350 Rem. Mag.	.75

See added page for other caliber listings.

ADDITIONAL CALIBERS

MODEL 700 BOLT ACTION HIGH POWER RIFLE

PARTS LIST

NOTE: Prices for barrels and bolts will be quoted upon application. Factory assembly required.

SEE INSTRUCTIONS FOR ORDERING PARTS

Part No.	NAME OF PART	List Price	Part No.	NAME OF PART	List Price
15285	Magazine Spacer, 222 Rem.	\$.40	26382	Stock Assembly, 7mm Rem. Mag., ADL Grade	\$ 55.20
16826	Magazine Spacer, 222 Rem., BDL Grade	.40	26380	Stock Assembly, 222 Rem., 243 Win., 308 Win., 6mm Rem., 22-250 Rem., ADL Grade	46.20
15286	Magazine Spacer, 223 Rem., BDL Grade, 17 Rem.	.55	26415	Stock Assembly, 7mm Rem. Mag., 264-300 Win. Mag., BDL Grade	62.05
17983	Magazine Spring, 222 Rem., 223 Rem., 17 Rem.	1.10	26400	Stock Assembly, 222 Rem., 243 Win., 308 Win., 6mm Rem., 22-250 Rem., BDL Grade, 17 Rem.	53.05
17891	Magazine Spring, 243 & 308 Win., 6mm Rem., 6.5mm Rem. Mag., 350 Rem. Mag., ADL Grade	1.00	29585	Stock Assembly, Varmint, BDL Grade, 222 Rem., 223 Rem., 243 Win., 6mm Rem., 22-250 Rem.	53.05
15698	Magazine Spring, 22-250 Rem.	1.00	29586	Stock Assembly, Varmint, BDL Grade, 25-06	53.05
15699	Magazine Spring, 22-250 Rem., 6mm Rem., 243 Win., BDL Grade	1.00	26402	Stock Assembly, 6.5mm Rem. Mag., 350 Rem. Mag.	62.05
17058	Main Spring, 222 Rem., 223 Rem., 243 Win., 308 Win., 6.5mm Rem. Mag., 350 Rem. Mag., 17 Rem.	.55	26375	Trigger Guard, BDL Grade, 222 Rem., 223 Rem., 243 & 308 Win., 6mm Rem., 22-250 Rem., 17 Rem.	7.20
18843	Rear Scope Base, Varmint	2.75	26370	Trigger Guard Assembly, BDL Grade, 222 Rem., 17 Rem., 223 Rem., 243 Win., 308 Win., 6mm Rem., 22-250 Rem., 6.5mm Rem. Mag., 350 Rem. Mag.	9.00
21387	Recoil Pad, 7mm Rem. Mag., 264 & 300 Win. Mag.	4.50			
25410	Recoil Pad Screw, 7mm Rem. Mag., 264 & 300 Win. Mag.	.30			
18842	Scope Base Screw, Rear Varmint	.25			
16205	Scope Base Screw, Front Varmint	.25			

PARTS AND PRICES SUBJECT TO CHANGE WITHOUT NOTICE

DELIVERIES ARE F.O.B. ILION, N.Y.

INSTRUCTIONS FOR ORDERING PARTS

(PLEASE READ CAREFULLY)

Please give model number, part number and name. Give serial number and state caliber or gauge and choke. Identify parts from list, picture or exploded view. List interchangeable shotgun barrels on separate order form to speed shipment.

Cover only one subject in letter or order. Do not order parts and give repair instructions in same letter.

Please do not ship sample parts if they may be identified otherwise. See shipping instructions below.

The sale of center fire rifle barrels, bolts and receivers is restricted. Special tools and gauges are required for assembly.

Parts will be supplied for discontinued models if available. Parts cannot be supplied nor guns repaired if not listed in complete line parts list. Parts, being made to close dimensions, may require slight adjustment or fitting to assure proper function of arm.

IMPORTANT: Do not combine Part Orders with Gun Service Orders. Please send Part Orders direct to:

REMINGTON ARMS COMPANY, INC.
PARTS DEPT.
ARMS SERVICE DIVISION
Ilion, New York 13357

INSTRUCTIONS FOR FACTORY SERVICE

(PLEASE READ CAREFULLY)

Please package carefully. Use plenty of cushioning material to prevent movement of gun or parts in package. Please do not ship gun in a gun case, or special container that must be returned. Return of gun or parts will be speeded if properly packaged in a throw-away carton. Clearly mark forwarding and return address on gun package as well as on attached letter.

Securely attach complete letter of information on outside of each package returned to factory for repairs. Please do not return gun accessories such as sling straps, quick release swivels, special boots, covers, telescopes, mounts or any special equipment to factory with gun shipment. Give full details of contents. State if complete gun or part. List model number, part number and name, serial number and caliber or gauge. Give full condition of contents — any parts missing or damaged, etc. This will enable us to accurately list needed repairs.

Do not order parts and give repair instructions in same letter. To avoid delay in starting work, please include in first order or letter the trouble to be corrected, changes desired or parts to be replaced. If an estimate is required please advise. Otherwise work will proceed and a statement of cost will be sent. This will speed service.

Unless specified otherwise, shipments will be made by way of Parcel Post on small packages, Express on larger packages. Remington gun parts are not interchangeable with those of any other make. For this reason the Remington Arms Company, Inc., cannot service any gun not of its manufacture.

Repairs will be made on discontinued models as long as supply of parts is available. However, repairs cannot be made for models which are not listed in Complete Line Parts Lists.

IMPORTANT: Before packaging guns for return to factory, **ALL LIVE AMMUNITION SHOULD BE REMOVED.**

If live ammunition is included in package, shipment cannot be made by Insured Mail. All other shipments may be made by Insured Mail, Please send repairs direct to:

REMINGTON ARMS COMPANY, INC.
ARMS SERVICE DIVISION
Ilion, New York 13357

MAINTENANCE — Rifle should be checked periodically by a competent gunsmith to ensure proper inspection and any necessary replacement of worn or damaged parts.

IMPORTANT — Remington firearms are designed, manufactured and proof tested to standards based on factory loaded ammunition. Improperly loaded handloads can be dangerous. Remington Arms Company, Inc. cannot assume responsibility for damages or injury caused by handloads or reloaded ammunition.

This gun has been manufactured to Remington specifications and shipped from the factory suitable for use. Remington does not recommend and is not responsible for any alteration or modification to the gun not made by Remington factory personnel, nor the replacement of worn or damaged parts with those not of Remington manufacture.

Your new rifle was tested at the factory with
Remington-Peters center fire cartridges.



For best results, we recommend you use these cartridges in your
new Remington rifle.

Great guns deserve great ammunition.

We Make Both.



For complete information on all
Remington-Peters products, write for
your free color catalog:

Remington Arms Company, Inc.
Department GOG
Bridgeport, Conn. 06602

Printed in U.S.A.

Form RD 5461
Rev. 472